

# Mark Anthony

Estate Agents



14 Ewell Downs Road, Ewell, KT17 3BP  
Offers in excess of £1,250,000







14 Ewell Downs Road, Ewell, KT17 3BP

**Offers in excess of £1,250,000**

Mark Anthony Estate Agents are very pleased to be instructed to act in the sale of this attractive detached family home located in one of Ewell's premier private roads.

The location is ideal for Wallace Fields School, Glyn School and Ewell Village with its excellent local shops, restaurants and Mainline stations to London Bridge, Waterloo and Victoria.

There is scope to remodel the existing accommodation which comprises a spacious wood panelled hallway, downstairs W.C, kitchen / diner, three separate reception rooms of which two are very large. There is also an outside utility room.

On the first floor there are five bedrooms of which two have balconies overlooking the rear garden, plus an ensuite bathroom and shower room. The property has a frontage of 40 ft deep x 60 ft wide with a carriage driveway, leading to a garage and outside utility room, the once magnificent 140 ft long x 60ft wide South West facing rear garden has a grand paved raised terrace.

The property comes to the market with no chain and viewing is recommend to appreciate the properties full potential.



- Attractive home located in one of Ewell premier private roads
- Ideal location for Wallace Fields and Glyn Schools
- Walking distance to Ewell Village High Street and two Mainline stations to London
- 40 ft deep x 60ft wide frontage
- Three reception rooms
- Five bedrooms and two bathrooms
- Kitchen diner, utility room and downstairs W.C
- 140ft deep x 60ft wide South West facing rear garden
- No chain, viewing is recommended to appreciate the properties full potential
- Epc Rating : E





Floor Plans

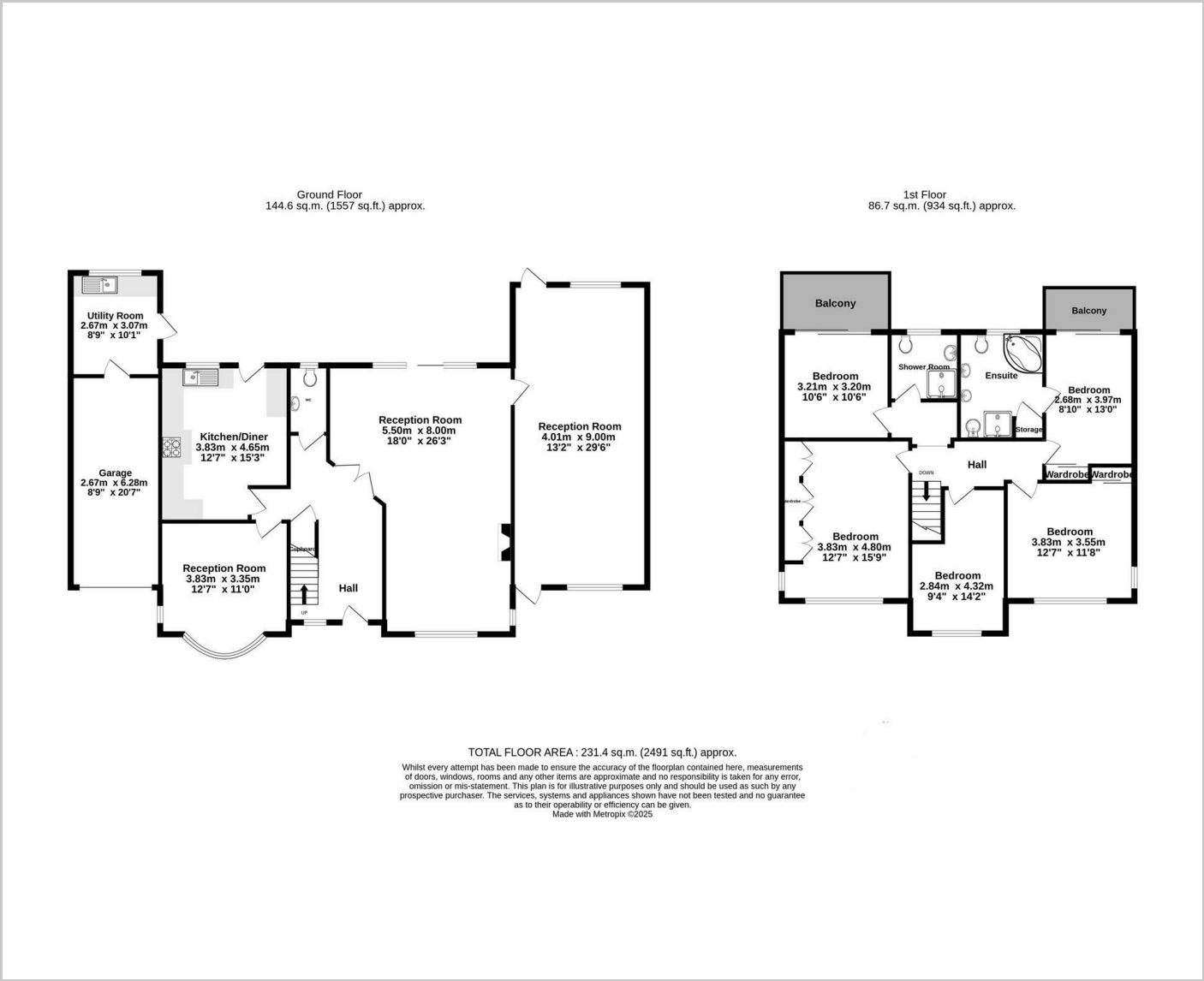

Area Map

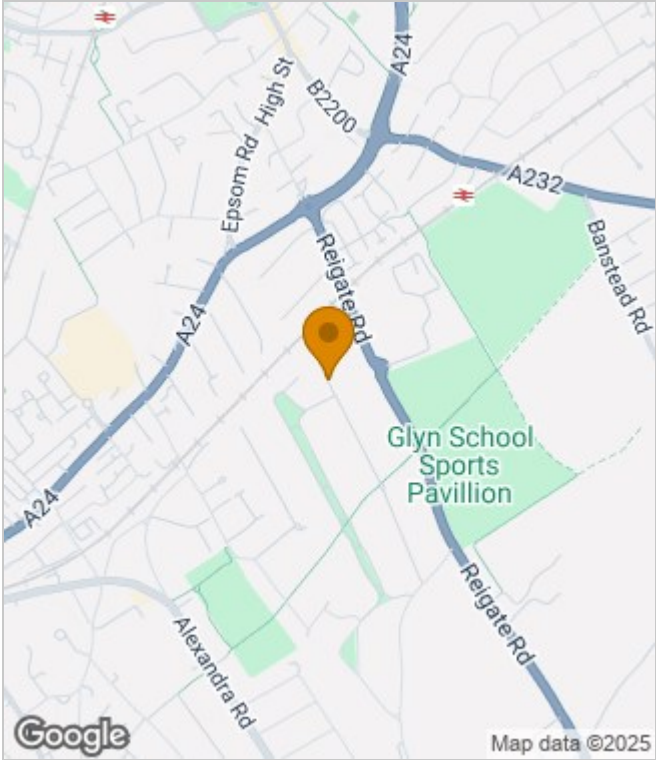

Energy Performance Graph

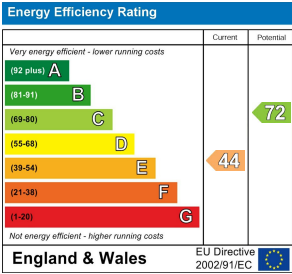

These particulars, whilst believed to be accurate are set out as a general outline only for guidance and do not constitute any part of an offer or contract. Intending purchasers should not rely on them as statements of representation of fact, but must satisfy themselves by inspection or otherwise as to their accuracy. No person in this firms employment has the authority to make or give any representation or warranty in respect of the property.