

Mark Anthony

Estate Agents



27 Manor Drive, Ewell Court, KT19 0EX
£635,000

 2  1  1  D



27 Manor Drive, Ewell Court, KT19 0EX

£635,000

Mark Anthony Estate Agents are delighted to bring to the market this extended two double bedroom detached bungalow situated in the extremely sought after Ewell Court, within walking distance of Ewell Village, Stoneleigh Mainline station, local shopping parade, Ofsted outstanding schools and the picturesque Hogsmill Nature Reserve.

Immediately upon entering the property you are aware of the scale and space provided whilst standing in the most welcoming of hallways, the accommodation flows naturally off the hallway and includes an extended light and airy reception room overlooking and accessing the rear garden a wonderful family space both for living and entertaining, two double bedrooms with fitted wardrobes and storage, rear aspect kitchen, bathroom and separate W.C

There is also a predominantly lawned 90ft sunny South facing rear garden, off road parking to the front and a detached garage.

The property is brought to the market with NO ONWARD CHAIN, viewing is highly recommended to fully appreciate all that this superb home offers, with scope to extend (stpp) like others have in the road.

- Extended Detached Bungalow
- Two double bedrooms
- Located in Ewell Court
- Welcoming hall way
- Extended Lounge / Diner
- Potential to extend (stpp) like others have in the road
- Off road parking and Garage
- 90 ft South facing garden
- No Chain
- EPC D



Floor Plans

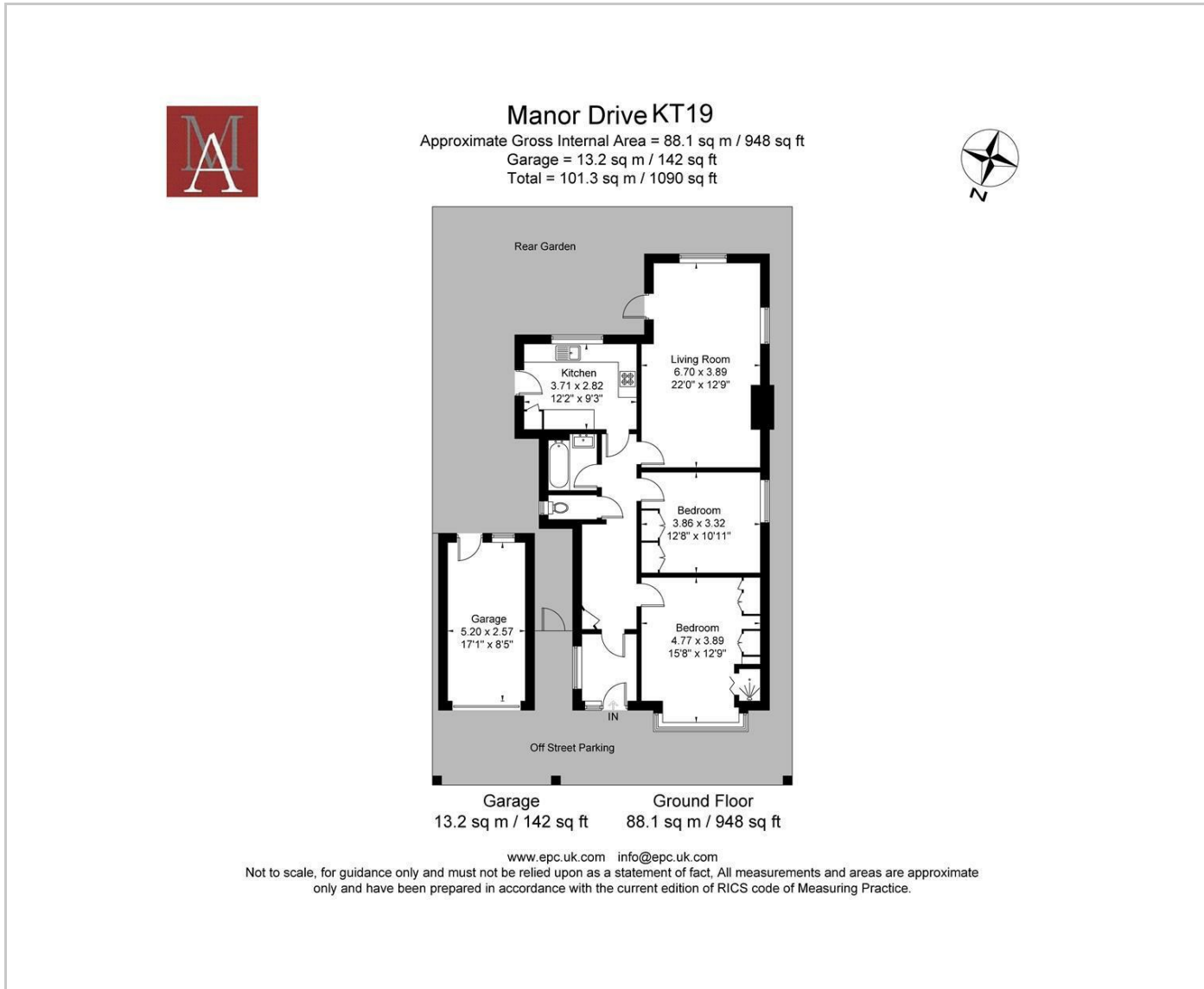

Area Map

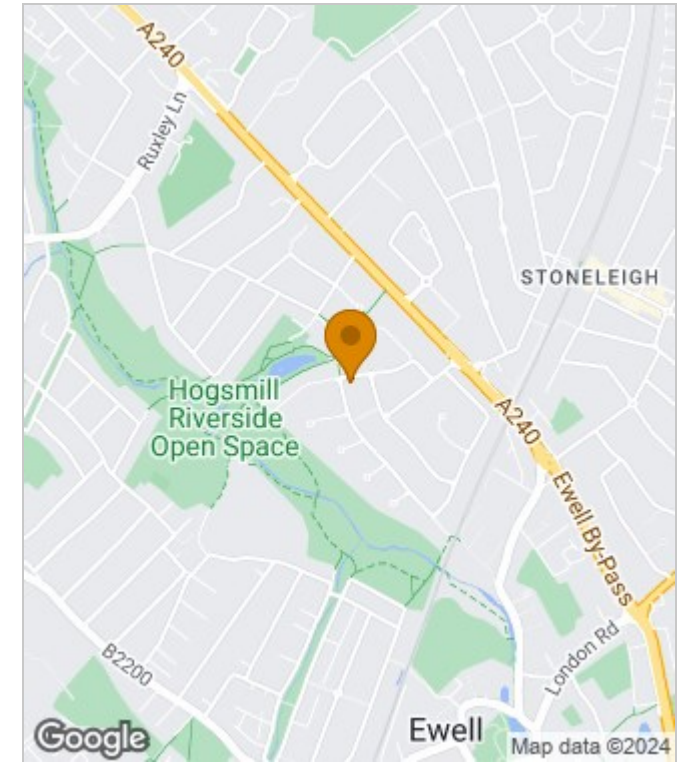

Energy Performance Graph

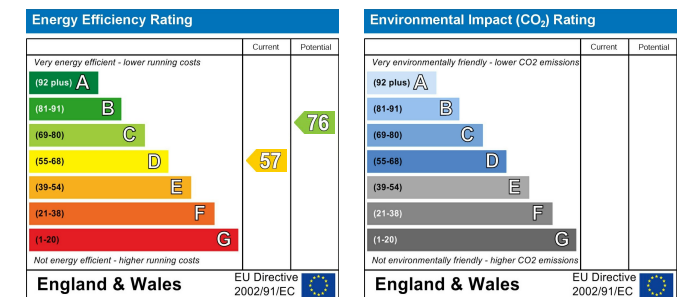

These particulars, whilst believed to be accurate are set out as a general outline only for guidance and do not constitute any part of an offer or contract. Intending purchasers should not rely on them as statements of representation of fact, but must satisfy themselves by inspection or otherwise as to their accuracy. No person in this firm's employment has the authority to make or give any representation or warranty in respect of the property.