



3 ARDBEG. MONESS TERRACE, ABERFELDY, PH15 2AD

Irving Geddes are delighted to offer for sale this beautifully presented, sizeable 3 bedroom ground floor flat occupying part of a handsome period building of privately owned apartments. No.3 enjoys a tremendous open outlook, private parking and gardens, located in a mature residential area close to the centre of the ever popular highland Perthshire town of Aberfeldy.

The spacious apartment has main front & rear door access, & extends to over 100m². The layout comprises; L-shaped HALL, large LOUNGE/DINING ROOM, a most attractive contemporary KITCHEN with rear door, 3 DOUBLE BEDROOMS, and modern luxury BATHROOM with free-standing bath and separate shower.

There is ample parking to the front, along with a private strip of garden ground. This elevated area allows for a most pleasant open aspect. There are areas laid to gravel to the side & rear with a further area of private garden laid to lawn.

3 Ardbeg enjoys an enviable location and is a property offered in true move-in condition. Likely to have broad appeal and early viewing is advised.

Ideally located with easy access to local amenities, a short walk to numerous independent shops, restaurants, hotels and cinema. Aberfeldy has a modern community campus, offering infant to secondary schooling, library, swimming pool and sports facilities. Those interested in outdoor pursuits are well catered for with a large public park & cricket ground, along with tennis & bowls club, golf course & woodland walks. Loch Tay is 6mils away, with numerous mountain & riverside walks within close proximity.

Video Tour <https://my.matterport.com/show/?m=oDa4DiAG45X>

Energy Performance Rated 'C' for efficiency. **Council Tax** Band 'C'.

Viewing Strictly by appointment through Irving Geddes - 01887 822722.











These particulars are believed to be correct, but their accuracy is not guaranteed and they do not form part of any contract. All measurements shown are approximate only.

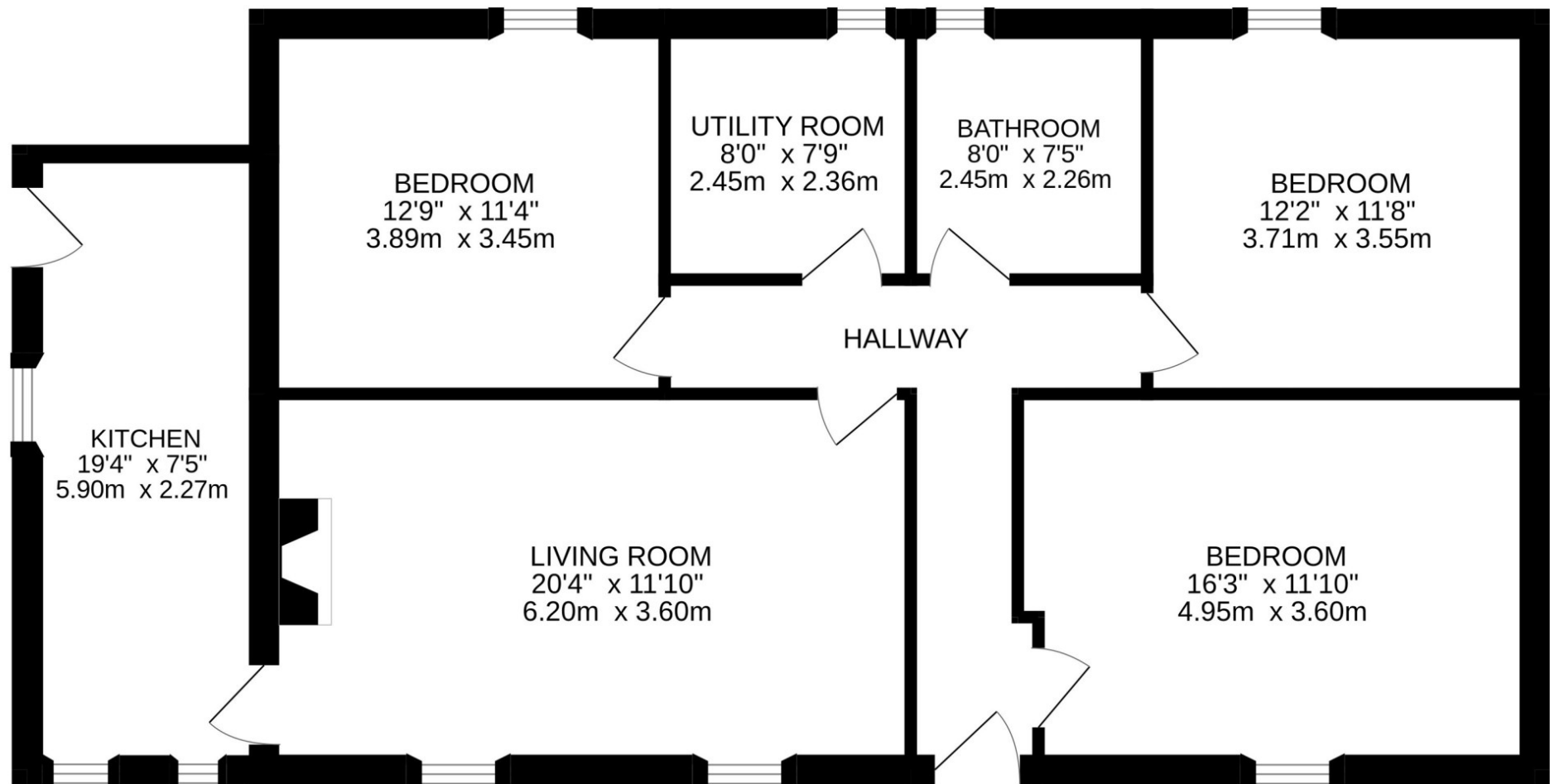



Crieff

25 West High Street, PH7 4AU
Tel: 01764 653771

Comrie

1 Drummond Street, PH6 2DW
Tel: 01764 670325

Aberfeldy

6 The Square, PH15 2DD
Tel: 01887 822722