



RETAIL SHOP, 22 WEST HIGH STREET
CRIEFF, PH7 4DL

22 WEST HIGH STREET, CRIEFF, PH7 4DL

Irving Geddes are delighted to offer for sale this double fronted retail premises, boasting an excellent trading position, with significant passing trade and nearby car parking. The trading floor, complete with display racking, extends to some 680ft² & comprises a main retail space & built-in storage area. The basement, accessed by internal stairs at the rear, offers significant storage of c.390ft², and has a W.C., and door to rear. A property also benefits from private parking for one vehicle at the rear, a significant bonus for a high street premises.

Crieff itself is the largest town in Strathearn & is a popular tourist destination, with a resident population of about 8,000. Situated some 17 miles to the west of Perth it is in an area of high amenity and recreational value.

The rateable value of this property is £7,600 per annum. Rates relief may apply but interested parties should satisfy themselves in this regard.

Video Walkthrough <https://my.matterport.com/show/?m=NNUyC1wYKZw>

Viewing Strictly by appointment through Irving Geddes - 01764 653771.



Irving Geddes
W.S. • Solicitors • Estate Agents





BASEMENT

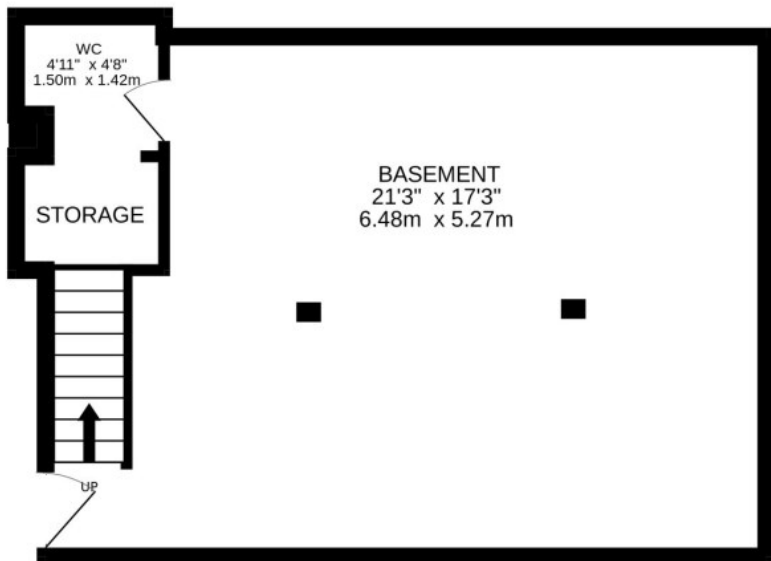

GROUND FLOOR

