



WESTWOOD COTTAGE
HOPE PLACE, CRIEFF, PH17 3DL

WESTWOOD COTTAGE, HOPE PLACE, CRIEFF, PH7 3DL

We are delighted to offer for sale this attractive and upgraded three bedroom semi-detached cottage enjoying a most quiet location at the end of a cul-de-sac in a prime residential area of Crieff. Westwood is presented in immaculate condition and has been upgraded by the current owners to include CR Smith double glazing, new kitchen, bathroom, internal doors, decoration & cavity wall insulation.

Accommodation comprises on the ground floor; ENTRANCE VESTIBULE, L-shaped HALLWAY with storage, large LOUNGE, triple aspect SUNROOM with French doors leading to a patio area, DINING KITCHEN with range cooker, dishwasher, fridge freezer, UTILITY ROOM with storage and generously proportioned rear porch giving access to the garden, TWO BEDROOMS and FAMILY BATHROOM with separate shower unit. The upper floor comprises; DOUBLE BEDROOM (en-suite shower) with bespoke fitted wardrobes, large cupboard, eaves storage & fabulous views over looking Callums' Hill.

Attractive, mature garden grounds surround the property and feature a wide variety of flowering plants. There is an area of lawn, stone chippings & planted borders. Located to the rear of the garden is a garage with electric door, timber shed & summer house. Access to Westwood Cottage is via a driveway to the front and provides parking for many vehicles.

Westwood Cottage is a charming property, warmed by gas central heating and double glazed throughout. Enjoying an enviable location and likely to be a most welcome addition to the market, early viewing is advised.















GROUND FLOOR

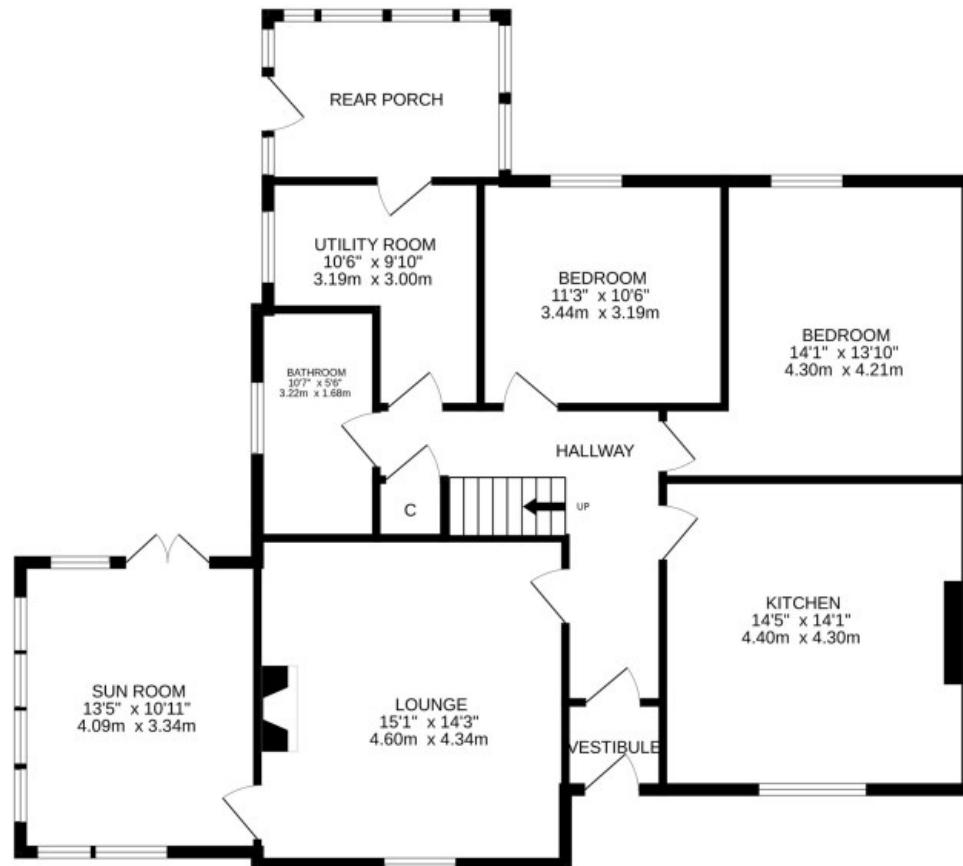

1ST FLOOR

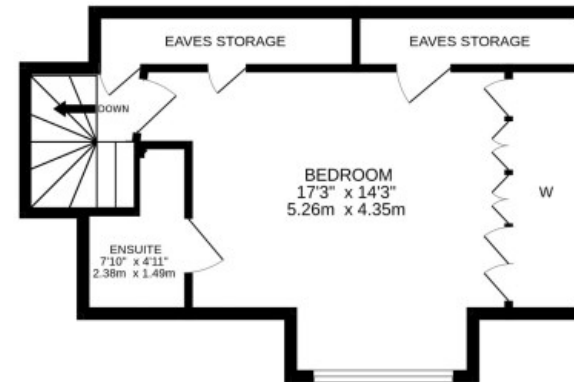

Energy Performance E Rating Council Tax Band E Services Mains Drainage, Electric, Gas & Water

3D Tour <https://my.matterport.com/show/?m=nabcYAYnCYP>

Viewing Strictly by appointment through Irving Geddes on 01764 653771.





Crieff

25 West High Street, PH7 4AU
Tel: 01764 653771

Comrie

1 Drummond Street, PH6 2DW
Tel: 01764 670325

Aberfeldy

6 The Square, PH15 2DD
Tel: 01887 822722