

28 PARK VILLAGE
TURRETBANK ROAD, CRIEFF, PH7 4JN



28 PARK VILLAGE, TURRETBANK ROAD, CRIEFF, PH7 4JN

Irving Geddes are delighted to offer for sale this spacious 2 bedroom Park Home boasting attractive mature gardens. Located within a popular development, adjacent to park-land and the sought after Turretbank area of Crieff.

Well-proportioned accommodation comprising; HALLWAY with STUDY off, large LOUNGE open to a DINING ROOM with sliding doors leading to a substantial CONSERVATORY, with direct access to the rear garden. There is a fully-fitted BREAKFASTING KITCHEN, internal HALL with storage, a BATHROOM, and TWO BEDROOMS, the master with EN-SUITE SHOWER ROOM. Externally there are fully enclosed gardens grounds, the front laid to lawn with mature planting and mono-bloc path, the smaller rear has an area of lawn, mono-bloc path & decked patio with greenhouse. There is private parking for 2 vehicles and a large detached shed.

Aimed at those 50 and over, Park Village is located on the western edge of the ever popular market town of Crieff, enjoying a quiet situation yet within easy reach of the town centre. Site fees (£226.40pm) cover ground rent, site warden, general maintenance & lighting of common areas.

Video Tour <https://my.matterport.com/show/?m=YT8mzo6Nm2x>

Viewing Strictly by appointment - Irving Geddes 01764 653771.

IrvingGeddes
W.S. • Solicitors • Estate Agents











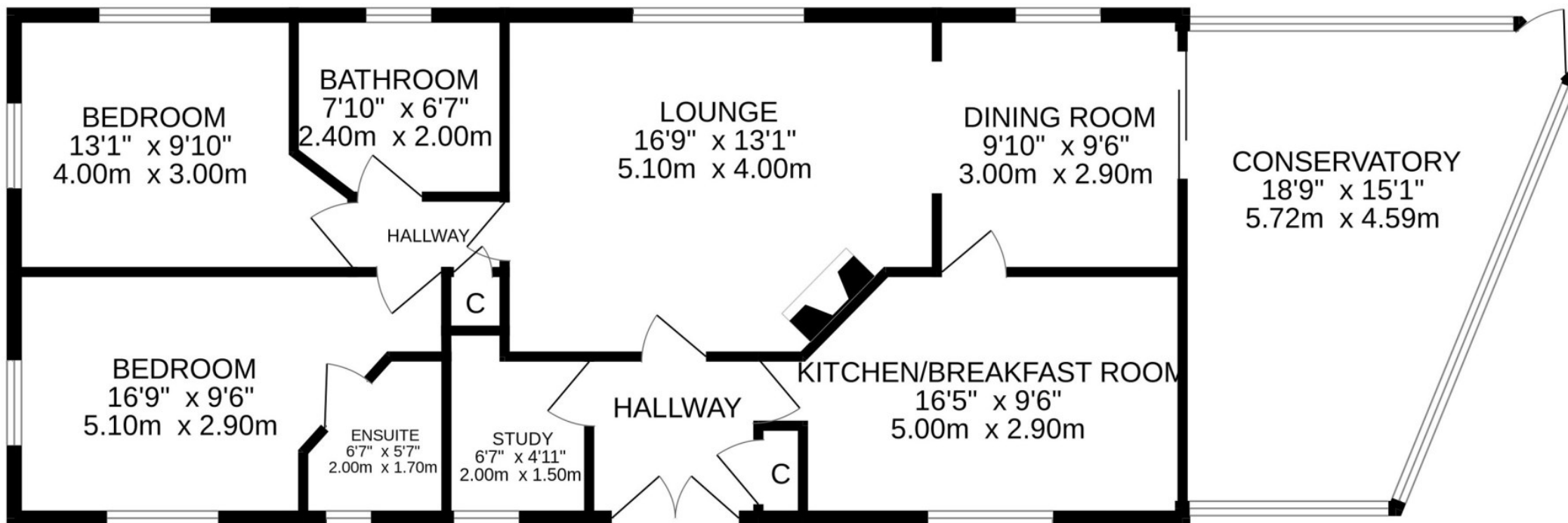

These particulars are believed to be correct, but their accuracy is not guaranteed and they do not form part of any contract. All measurements are approximate only.



Crieff
25 West High Street, PH7 4AU
Tel: 01764 653771

Comrie
1 Drummond Street, PH6 2DW
Tel: 01764 670325

Aberfeldy
6 The Square, PH15 2DD
Tel: 01887 822722