

# Chard

— ESTATE AGENTS —



## Brompton Park Crescent, SW6

£714 pw (£3098 pcm)

An immaculately presented two bedroom apartment in this popular gated development. The property offers an open plan kitchen/reception room leading out to the patio garden, wood flooring, two bedrooms and two bathrooms.

Brompton Park Crescent is a gated development close to the amenities of Old Brompton Road and transport links of both West Brompton and Fulham Broadway.

- Gated Development • Open Plan • Two Bathrooms •
- Wood Flooring • Private Patio Garden • Residential Pool and Gymnasium •

# Chard

— ESTATE AGENTS —

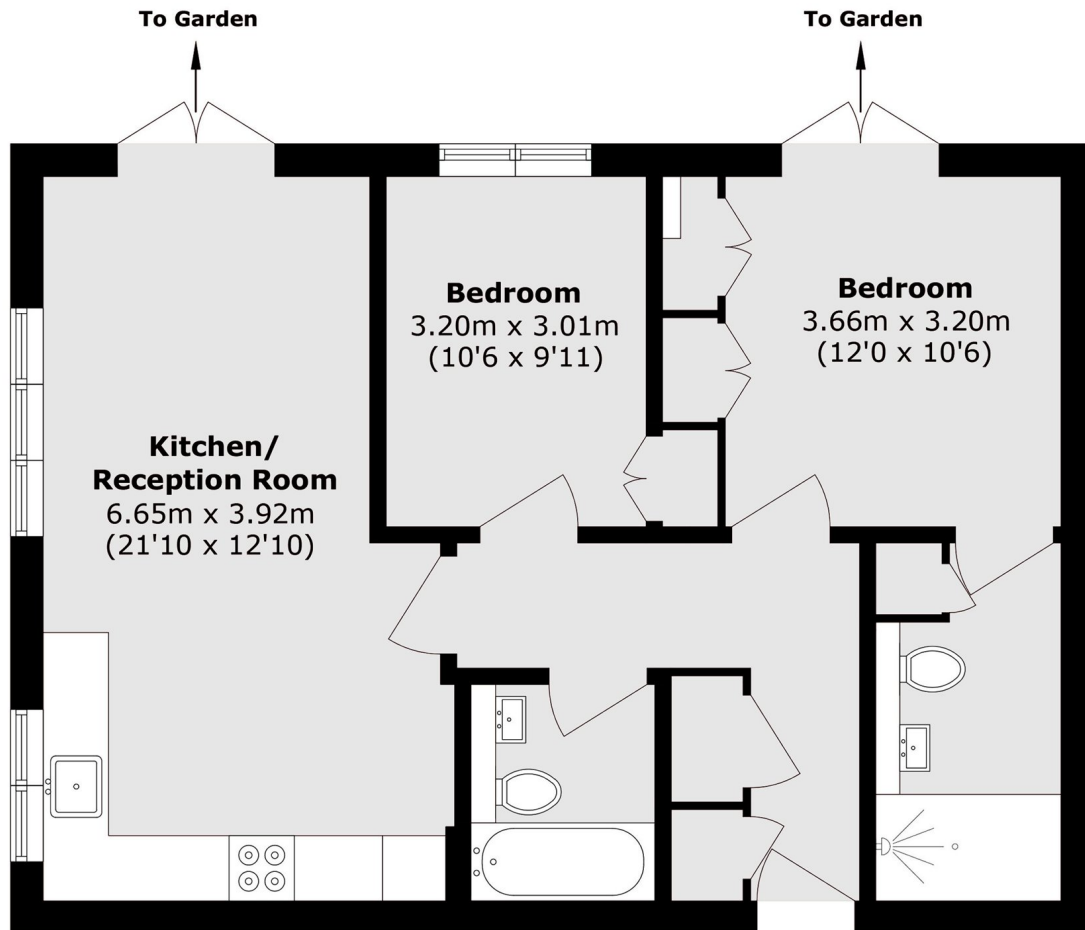

## Ground Floor

Total area (approx.): 62.2 sq. m (669.5 sq. ft)

Chard Fulham  
656 Fulham Road,  
London, SW6 5RX  
020 7384 1400  
[fulhamlettings@chard.co.uk](mailto:fulhamlettings@chard.co.uk)

Energy Rating: . We aim to make our particulars both accurate and reliable. However they are not guaranteed; nor do they form part of an offer or contract. If you require clarification on any points then please contact us, especially if you're traveling some distance to view. Please note that appliances and heating systems have not been tested and therefore no warranties can be given as to their good working order.