

Chard

— ESTATE AGENTS —



Eltringham Street, SW18

£634 pw (£2,750 pcm)

This three bedroom house in the heart of Wandsworth comprises a private garden, a large double reception room, a separate kitchen, three bedrooms and a family bathroom.

Eltringham Road is opposite Battersea Reach, within walking distance to Wandsworth Town station and close to the River Thames

- Three Bedrooms • Double Reception • Separate Kitchen •
- Central Location • Private Garden • Wandsworth Town •

Chard

— ESTATE AGENTS —

ELTRINGHAM STREET, SW18

Approx. gross internal area

857 Sq Ft. / 79.7 Sq M.

Representation of current layout.

Not to scale.

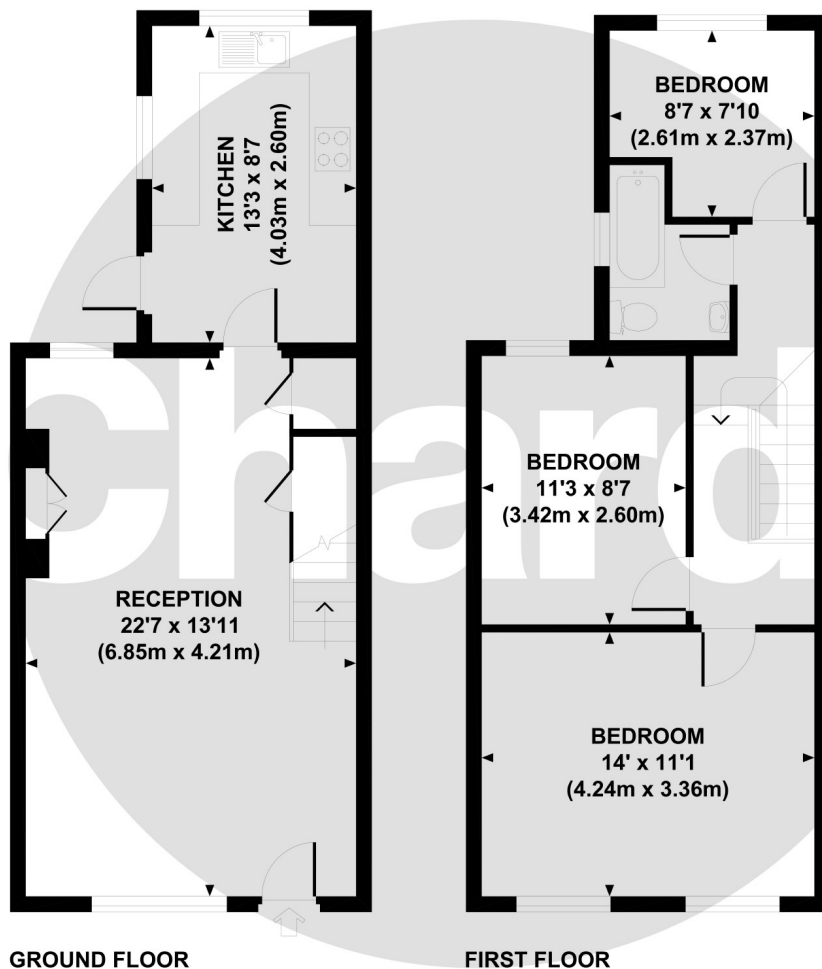

Chard Fulham
656 Fulham Road,
London, SW6 5RX
020 7384 1400
fulhamlettings@chard.co.uk

Energy Rating: D. We aim to make our particulars both accurate and reliable. However they are not guaranteed; nor do they form part of an offer or contract. If you require clarification on any points then please contact us, especially if you're traveling some distance to view. Please note that appliances and heating systems have not been tested and therefore no warranties can be given as to their good working order.