

Chard

— ESTATE AGENTS —



Jubilee Terrace, SW6

£542 pw (£2,350 pcm)

A light and contemporary maisonette located on this popular residential road. Boasting wood flooring throughout the property also offers a large kitchen/dining area, separate reception, double bedroom with built in wardrobe space and a modern bathroom.

Burlington Road is conveniently located for the local amenities on both Fulham Road and Fulham High Street with transport links of Putney Bridge close by.

- Private Entrance • Kitchen/Diner • Wood Flooring •
- Modern Bathroom • Light and Airy • Central Location •

Chard

— ESTATE AGENTS —

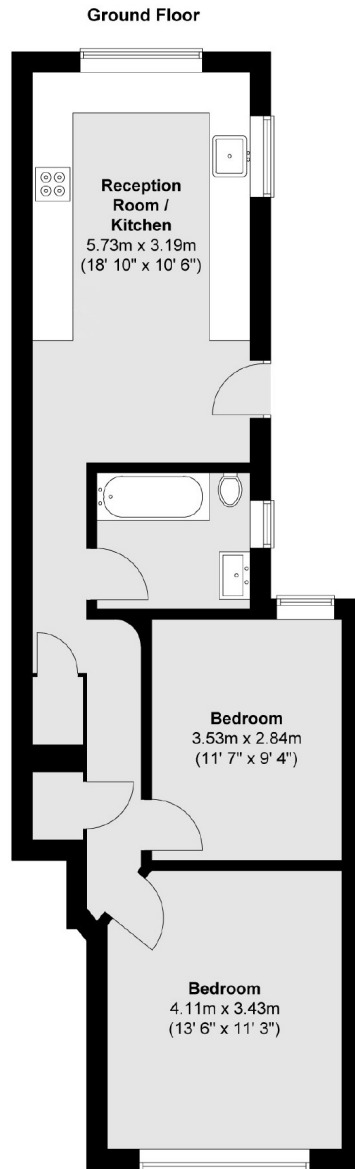

Total area (approx.) : 56.7 sq. m (610 sq. ft)

Chard Fulham
656 Fulham Road,
London, SW6 5RX
020 7384 1400
fulhamlettings@chard.co.uk

Energy Rating: . We aim to make our particulars both accurate and reliable. However they are not guaranteed; nor do they form part of an offer or contract. If you require clarification on any points then please contact us, especially if you're traveling some distance to view. Please note that appliances and heating systems have not been tested and therefore no warranties can be given as to their good working order.