

Chard

— ESTATE AGENTS —



Epirus Road, SW6

£1,384 pw (£6,000 pcm)

This beautifully presented 5-bedroom home in Fulham offers spacious living with a blend of modern design and Victorian charm. Spread over four floors, it features an open-plan living/dining area, a sleek kitchen, and a private garden. The master bedroom includes an en-suite, with additional well-sized bedrooms and modern bathrooms throughout.



This beautifully presented 5-bedroom home in Fulham offers spacious living with a blend of modern design and Victorian charm. Spread over four floors, it features an open-plan living/dining area, a sleek kitchen, and a private garden. The master bedroom includes an en-suite, with additional well-sized bedrooms and modern bathrooms throughout.

Epirus Road is so ideally located to Fulham Broadway Underground. It is also just off the North End Road and Fulham Road where there are many bus routes leading into the city and towards Chelsea.

- Five Bedrooms • 4 Bathrooms • Large Double Reception •
- Private Garden •



Chard

— ESTATE AGENTS —

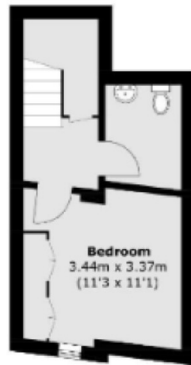

Lower Ground Floor



Second Floor

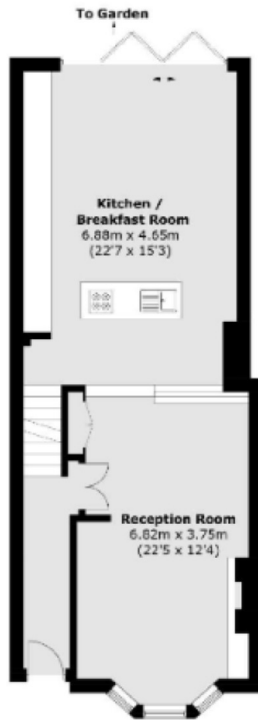

Ground Floor



First Floor

Total area (approx.): 167.0 sq. m (1,797.4 sq. ft)
(Excluding Eaves)

Chard Fulham
656 Fulham Road,
London, SW6 5RX
020 7384 1400
fulhamlettings@chard.co.uk

Energy Rating: . We aim to make our particulars both accurate and reliable. However they are not guaranteed; nor do they form part of an offer or contract. If you require clarification on any points then please contact us, especially if you're traveling some distance to view. Please note that appliances and heating systems have not been tested and therefore no warranties can be given as to their good working order.