

# Chard

— ESTATE AGENTS —



## Townmead Road, SW6

£530 pw (£2,444 pcm)

A beautifully presented apartment in this popular new build development. The property offers an open plan kitchen/reception room, modern bathroom suite, one double bedroom, wood flooring throughout and a large private terrace.

Townmead Road is perfectly located for Imperial Wharf, the River Thames and a short walk away from the amenities on the New Kings Road.

- Private Terrace • Modern Fixtures and Fittings • Wood Flooring •
- New Build Development • Concierge Service • River Thames •

# Chard

— ESTATE AGENTS —

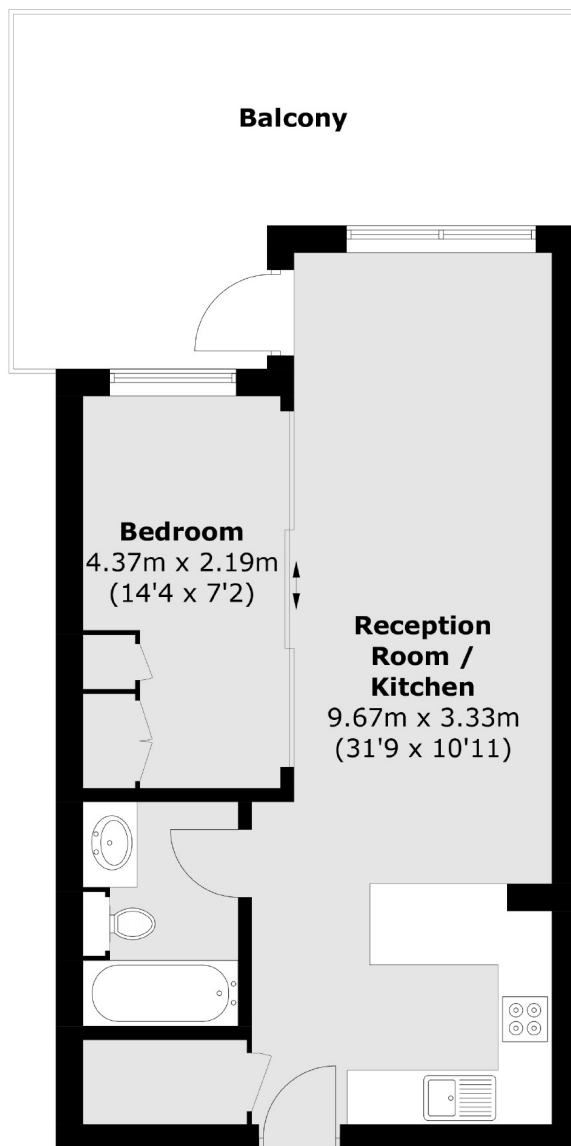

Total area (approx.): 46.9 sq. m (504.8 sq. ft)  
Balcony (approx.): 19.1 sq. m (205.5 sq. ft)

Chard Fulham  
656 Fulham Road,  
London, SW6 5RX  
020 7384 1400  
[fulhamlettings@chard.co.uk](mailto:fulhamlettings@chard.co.uk)

Energy Rating: . We aim to make our particulars both accurate and reliable. However they are not guaranteed; nor do they form part of an offer or contract. If you require clarification on any points then please contact us, especially if you're traveling some distance to view. Please note that appliances and heating systems have not been tested and therefore no warranties can be given as to their good working order.