

Chard

— ESTATE AGENTS —



Querrin Street, SW6

£1,150,000

This is a wonderful opportunity to purchase an end of terrace home close to the River Thames and Parsons Green. This property comprises of four bedrooms, two bathrooms and a private garden,

Located in one of Sands Ends premier roads the property is situated close to all of the amenities on the Wandsworth Bridge Road, including many excellent local shops, restaurants and pubs.

- Four Bedrooms • Two Bathrooms • Garden •
- Potential To Modernise • End Of Terrace • Freehold •

Chard

— ESTATE AGENTS —

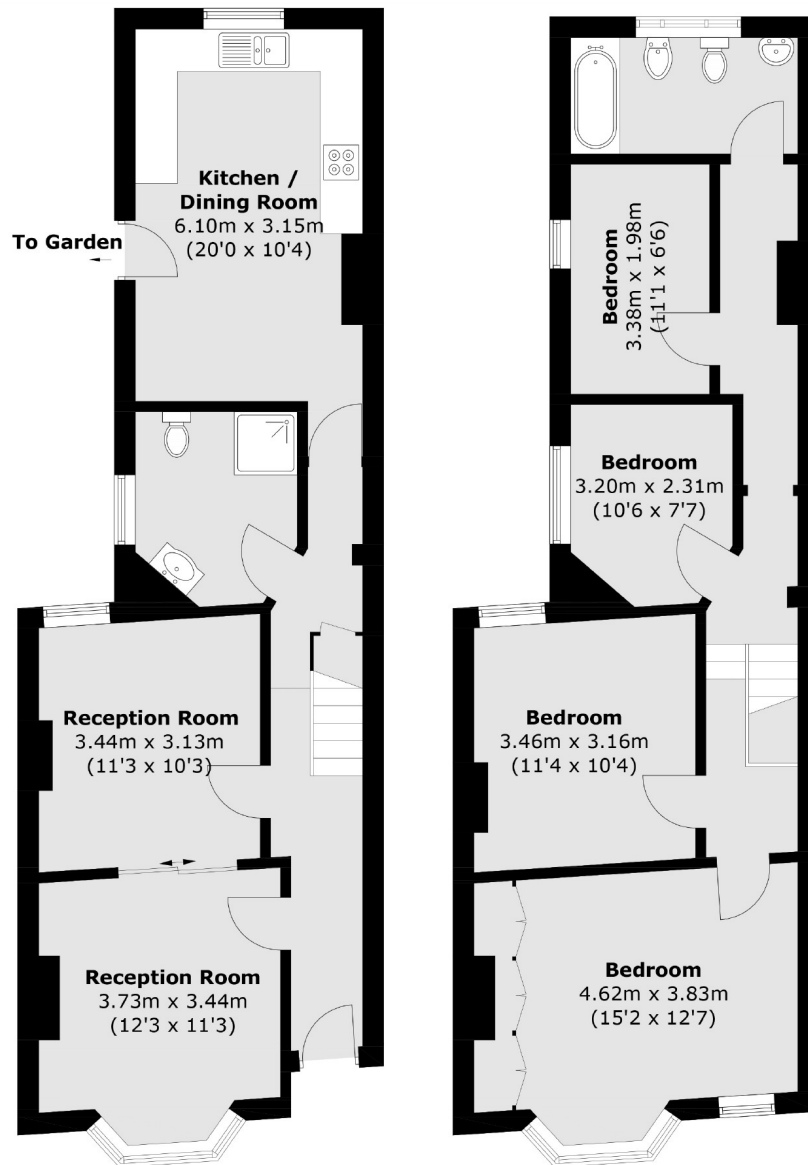

Ground Floor

First Floor

Total area (approx.): 118.9 sq. m (1,279.8 sq. ft)

Chard Fulham
656 Fulham Road,
London, SW6 5RX
020 7731 5115
fulhamsales@chard.co.uk

Energy Rating: D. We aim to make our particulars both accurate and reliable. However they are not guaranteed; nor do they form part of an offer or contract. If you require clarification on any points then please contact us, especially if you're traveling some distance to view. Please note that appliances and heating systems have not been tested and therefore no warranties can be given as to their good working order.