

# Chard

— ESTATE AGENTS —



## The Boulevard, SW6

£623 pw (£2700 pcm)

This two bedroom, two bathroom ninth floor apartment in the Imperial Wharf riverside development, has a spacious reception with a private balcony and a separate kitchen. There is also a 24-hour concierge, an on-site gym, and excellent local amenities.

Imperial Wharf Overground station is moments away along with many bus routes. For a scenic mode of transport, the river taxi is on your doorstep with routes into the city and Wandsworth. Fulham Broadway and Battersea are all close by providing excellent amenities.

- Two Double Bedrooms • Bright Reception • Integrated Kitchen •
- Private Balconies • Stunning Views • Residential Gym •

# Chard

— ESTATE AGENTS —

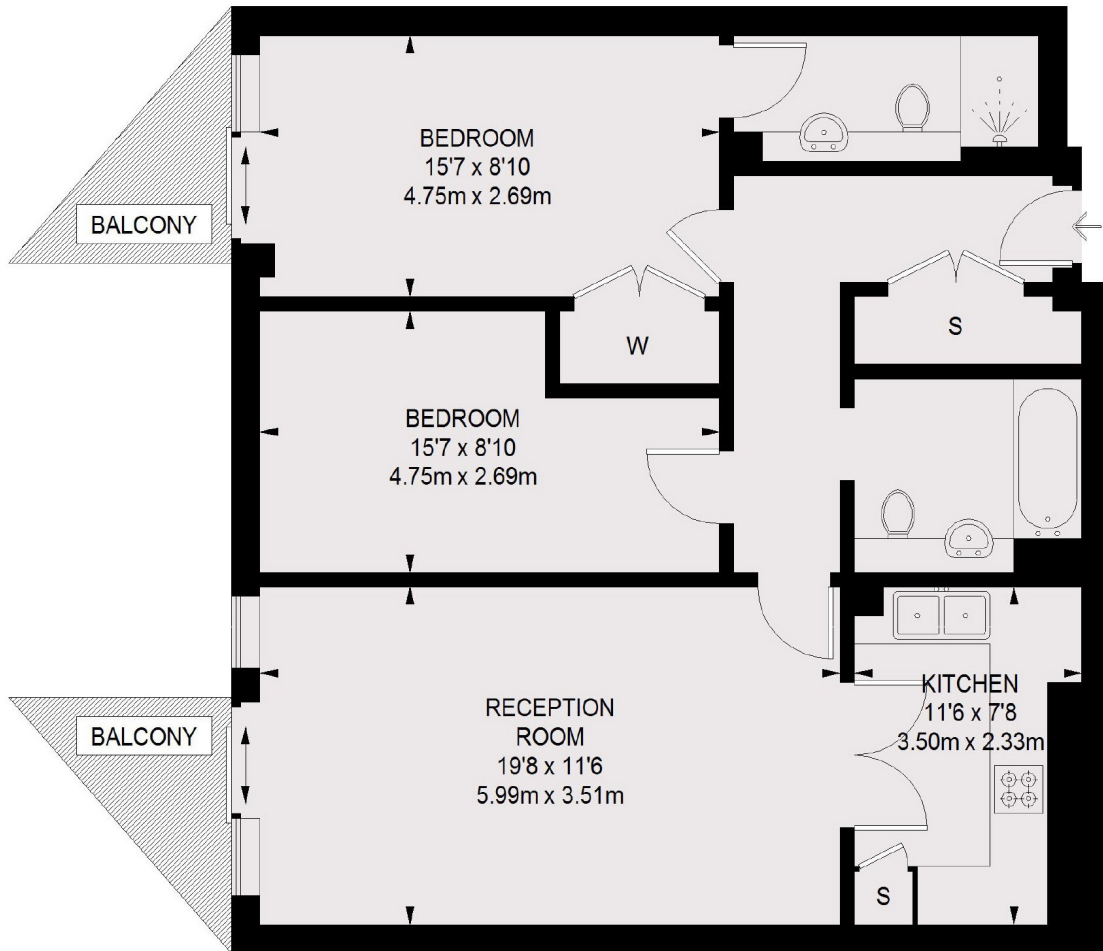

TOTAL APPROX. FLOOR AREA  
837 SQ. FT. (77.77 SQ. M.)

Chard Fulham  
656 Fulham Road,  
London, SW6 5RX  
020 7384 1400  
fulhamlettings@chard.co.uk

Energy Rating: D. We aim to make our particulars both accurate and reliable. However they are not guaranteed; nor do they form part of an offer or contract. If you require clarification on any points then please contact us, especially if you're traveling some distance to view. Please note that appliances and heating systems have not been tested and therefore no warranties can be given as to their good working order.