

Chard

— ESTATE AGENTS —



Moore Park Road, SW6

£530 pw (£2300 pcm)

This two bedroom raised ground floor flat in the heart of Fulham, is moments away from Eel Brook Common. The property has a spacious open plan living room with a fitted kitchen, a master bedroom with built in storage and a tiled modern bathroom.

Moore Park Road is well situated with easy access to Fulham Road and New Kings Road, with a variety of bus routes leading into the city. Fulham Broadway station (District line) is moments away with a selection of local amenities, bars, restaurants and superstores on your doorstep.

- Two Bedrooms • Open-Plan • Fitted Kitchen •
- Modern Bathroom • Good Storage • Fulham Broadway •

Chard

— ESTATE AGENTS —

Key

- (SA) Smoke Alarm
- (FB) Fire Blanket
- (FD) Fire Door
- (FE) Fire Extinguisher
- (HA) Heat Alarm
- (B) Boiler
- (CMA) Carbon Monoxide Alarm

Raised Ground Floor

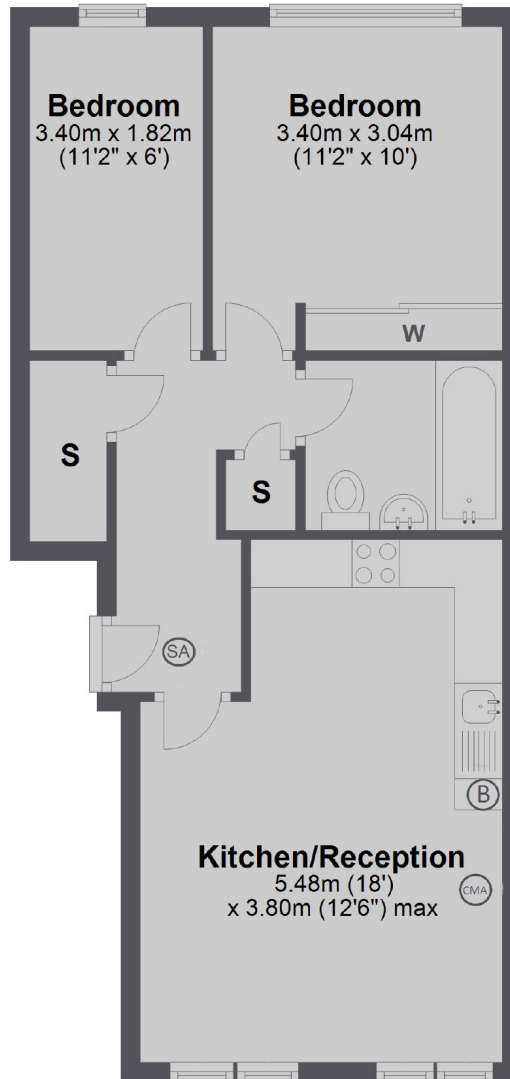

Total area: approx. 47.9 sq. metres (515.7 sq. feet)

Chard Fulham
656 Fulham Road,
London, SW6 5RX
020 7384 1400
fulhamlettings@chard.co.uk

Energy Rating: C. We aim to make our particulars both accurate and reliable. However they are not guaranteed; nor do they form part of an offer or contract. If you require clarification on any points then please contact us, especially if you're traveling some distance to view. Please note that appliances and heating systems have not been tested and therefore no warranties can be given as to their good working order.