

# Chard

— ESTATE AGENTS —



## Margravine Road, W6

£685,000

A recently refurbished, two double bedroom split level maisonette with a private garden, its own entrance and generous open plan living throughout spanning nearly 800sq.ft. This stylish property offers a unique space with high ceilings and other attractive period features, as well as a newly fitted contemporary bathroom, separate utility room and study space on the lower ground floor.

Margravine Road is within a short walking distance of Barons Court and Hammersmith tube station and is moments away from a plethora of local shops, restaurants and amenities on Fulham Palace Road. Queens Club is also situated just around the corner from the flat.

- Long Lease • Newly Renovated • Two Double Bedrooms •
- Private Patio Garden • Contemporary Bathroom Suite • Barons Court •

# Chard

— ESTATE AGENTS —

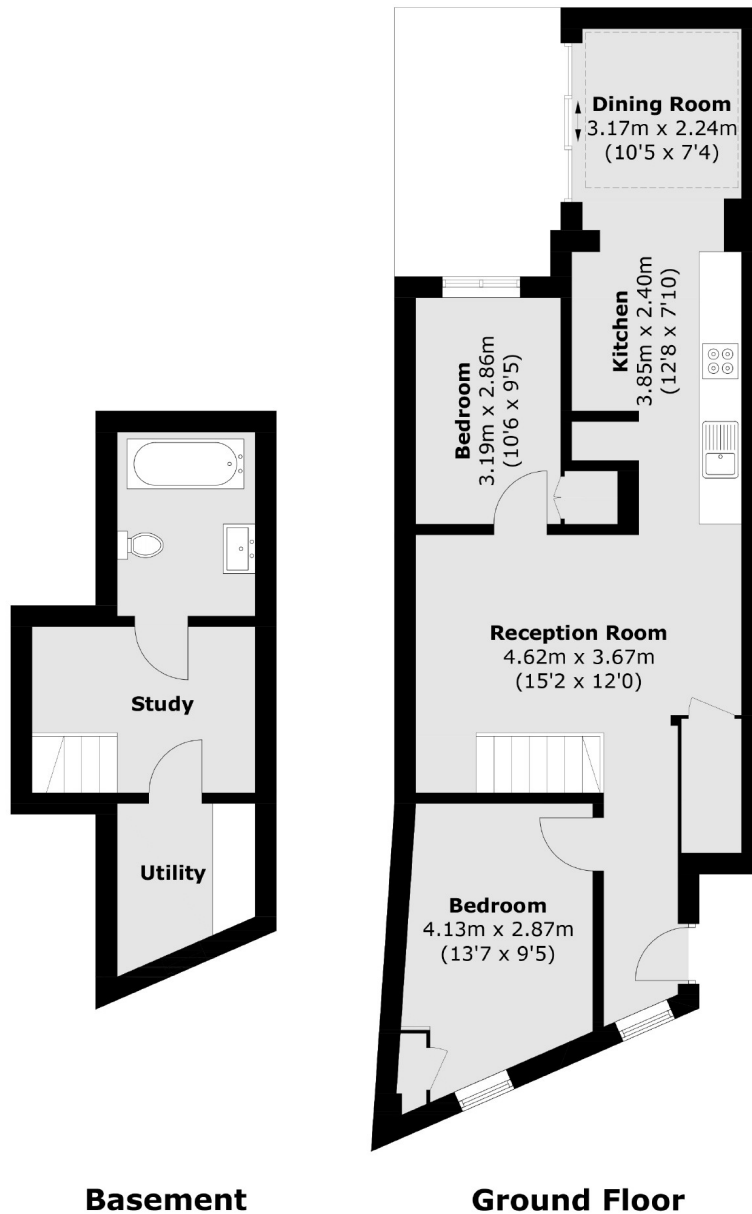

**Basement**

**Ground Floor**

Total area (approx.): 73.2 sq. m (787.8 sq. ft)

Chard Fulham  
656 Fulham Road,  
London, SW6 5RX  
020 7731 5115  
fulhamsales@chard.co.uk

Energy Rating: D. We aim to make our particulars both accurate and reliable. However they are not guaranteed; nor do they form part of an offer or contract. If you require clarification on any points then please contact us, especially if you're traveling some distance to view. Please note that appliances and heating systems have not been tested and therefore no warranties can be given as to their good working order.