

Chard

— ESTATE AGENTS —



Broomhouse Lane, SW6

£475,000

Situated on the top floor with panoramic views of Fulham, is this beautifully presented and spacious two double bedroom apartment. The apartment is accessed by a lift and features a fitted kitchen, light reception room with direct access to a private west facing balcony, family bathroom and plenty of storage.

Situated in a desirable location between two picturesque parks, Hurlingham and South Park, whilst just a short walk to desirable restaurants, bars and amenities in Parsons Green and on the New Kings Road.

- Excellent Location • Two Double Bedrooms • Private West Facing Balcony •
- Top Floor With Lift Access • Residents Permit Parking • Parsons Green •

Chard

— ESTATE AGENTS —

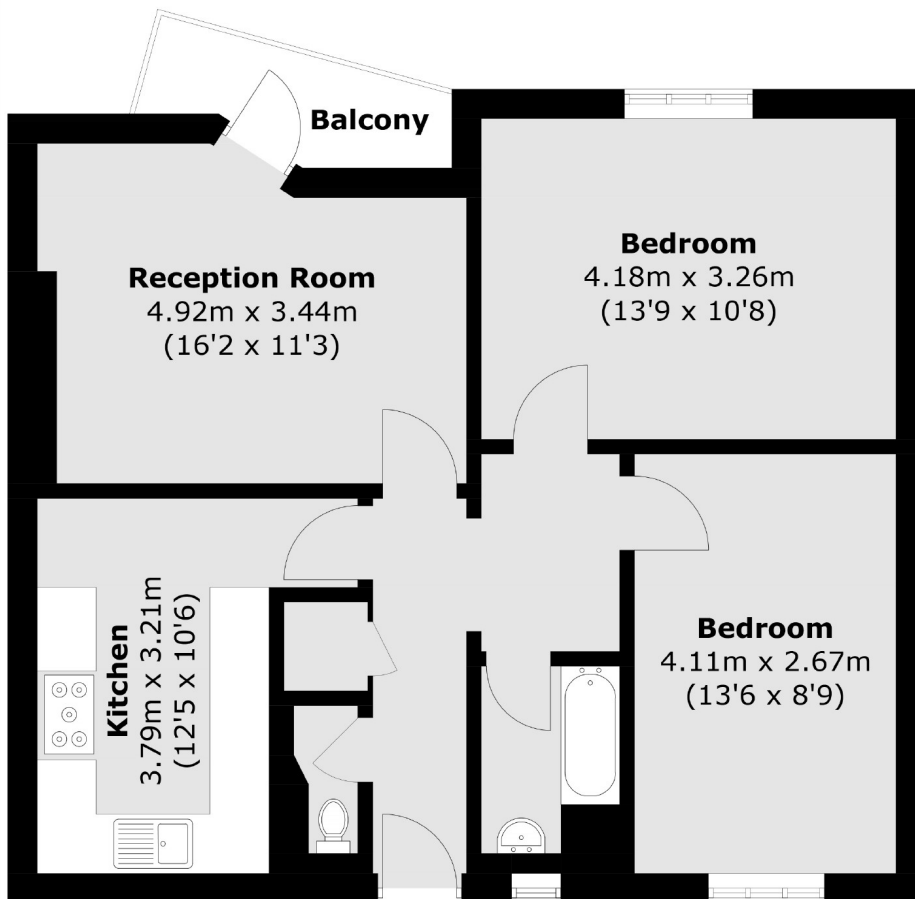

Total area (approx.): 64.4 sq. m (693.2 sq. ft)
Balcony: 3.0 sq. m (32.3 sq. ft)

Chard Fulham
656 Fulham Road,
London, SW6 5RX
020 7731 5115
fulhamsales@chard.co.uk

Energy Rating: TBC. We aim to make our particulars both accurate and reliable. However they are not guaranteed; nor do they form part of an offer or contract. If you require clarification on any points then please contact us, especially if you're traveling some distance to view. Please note that appliances and heating systems have not been tested and therefore no warranties can be given as to their good working order.