

Chard

— ESTATE AGENTS —



Barclay Close, SW6

£475,000

A beautifully presented two double bedroom top floor flat with a private balcony. The property is positioned in a well maintained, centrally located purpose built building with a lift and communal green space.

Barclay Close is close to both Parsons Green and Fulham Broadway There are also extensive leisure and shopping amenities including Whole Foods Market, Marks & Spencer and Waitrose all within close proximity.

- Two Bedrooms • Balcony • Lift •
- Modern Finish • Rooftop Views • Fulham Broadway •

Chard

— ESTATE AGENTS —

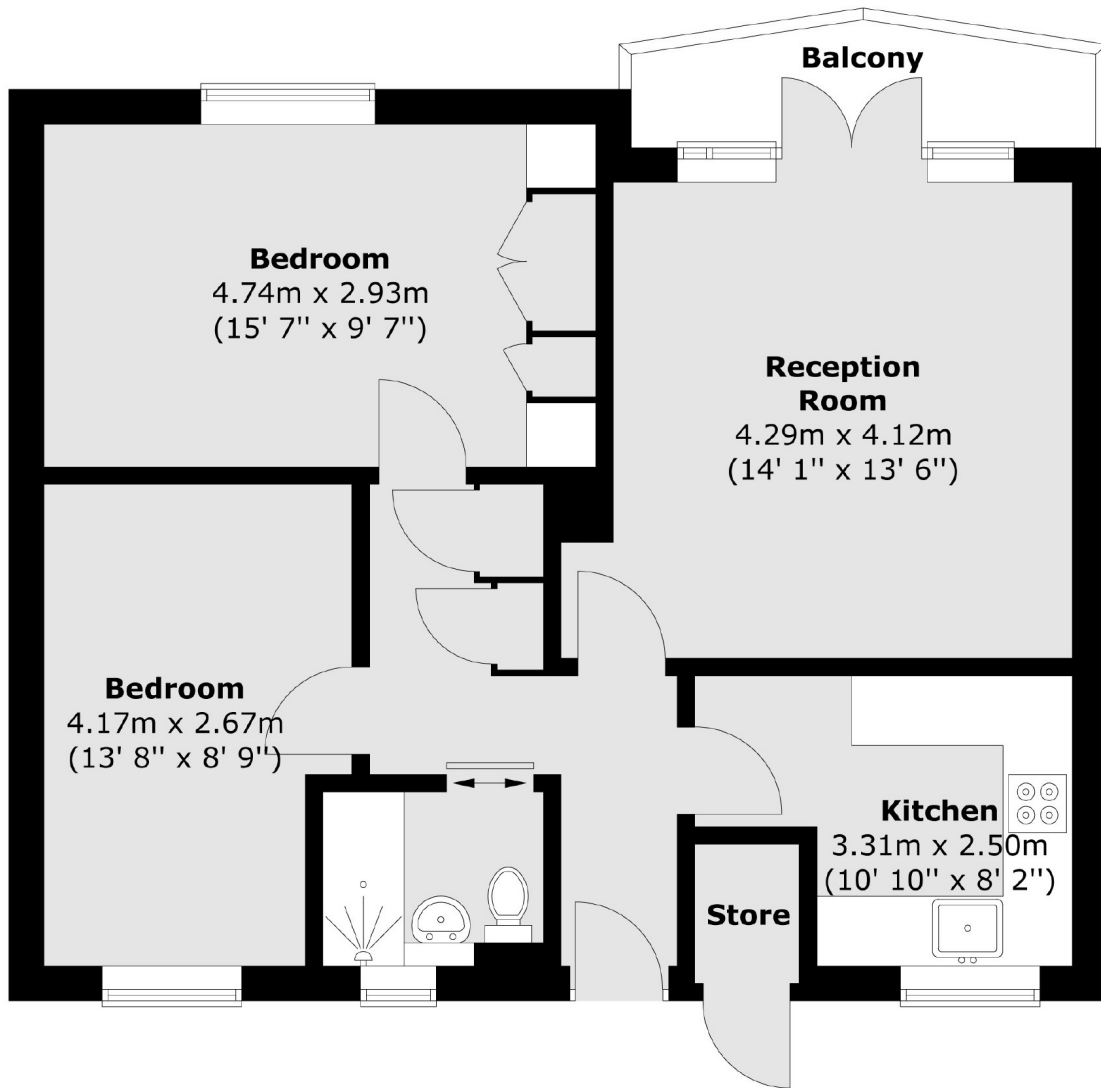

Total area (approx.) : 61.1 sq. m (658 sq. ft)
Total external storage area (approx.) : 1.1 sq. m (12 sq. ft)
Total balcony area (approx.) : 3.9 sq. m (42 sq. ft)

Chard Fulham
656 Fulham Road,
London, SW6 5RX
020 7731 5115
fulhamsales@chard.co.uk

Energy Rating: C. We aim to make our particulars both accurate and reliable. However they are not guaranteed; nor do they form part of an offer or contract. If you require clarification on any points then please contact us, especially if you're traveling some distance to view. Please note that appliances and heating systems have not been tested and therefore no warranties can be given as to their good working order.