



Richmond Court, Exeter, EX4

Guide Price £210,000



Key Features

- Turn key apartment
- Allocated parking
- Master Ensuite
- City centre
- Close to amenities
- Two double bedrooms



A beautifully presented two bedroom apartment situated in the heart of Exeter City Centre offering two double bedrooms with master en-suite, open plan living and a private allocated parking bay'





The apartment is located on the first floor. Upon entering, you are greeted by a spacious entrance hall with two storage cupboards on the left-hand side, followed by doors leading to all principal rooms.

As you proceed down the hallway, the master and second bedrooms are located on the right side of the apartment. Both are generously sized doubles, offering ample room for furniture. The master bedroom benefits from its own en-suite, which includes a shower, WC, and wash hand basin.

The family bathroom features a modern three-piece suite, including a bathtub with shower over, WC, and wash hand basin.

At the rear of the apartment is the open-plan living and kitchen area, which spans the entire width of the apartment, covering an impressive 25'7" x 18'1" of floor space. This room is particularly light and airy, thanks to the large bay-fronted window that floods the space with natural daylight. The kitchen offers plenty of base and eye-level storage cupboards, along with a range of integrated appliances, including a four-ring gas hob with oven below, an extractor above, an integrated dishwasher and washing machine and a free standing fridge-freezer.

The apartment also benefits from an allocated parking space, conveniently located a few metres from the main entrance.



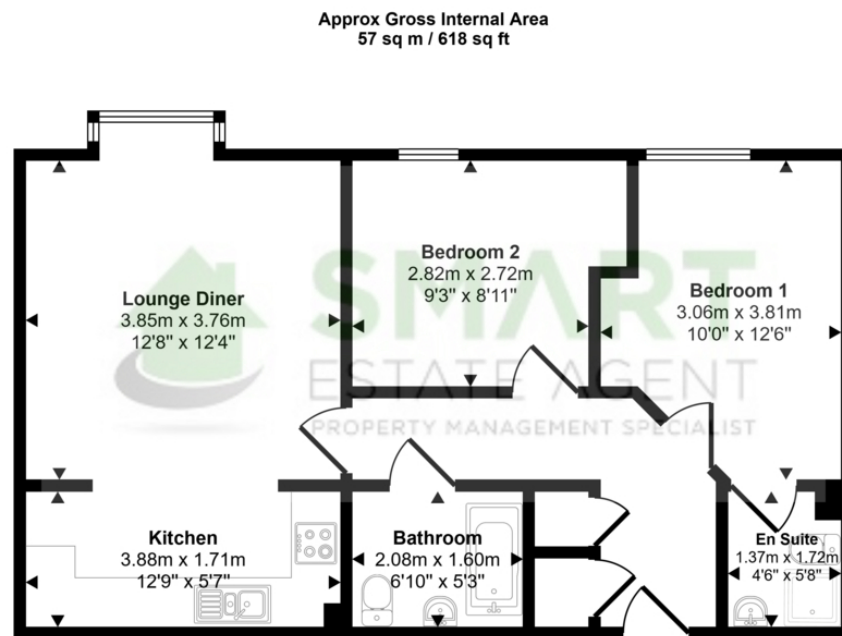

Floorplan

This floorplan is only for illustrative purposes and is not to scale. Measurements of rooms, doors, windows, and any items are approximate and no responsibility is taken for any error, omission or mis-statement. Icons of items such as bathroom suites are representations only and may not look like the real items. Made with Made Snappy 360.

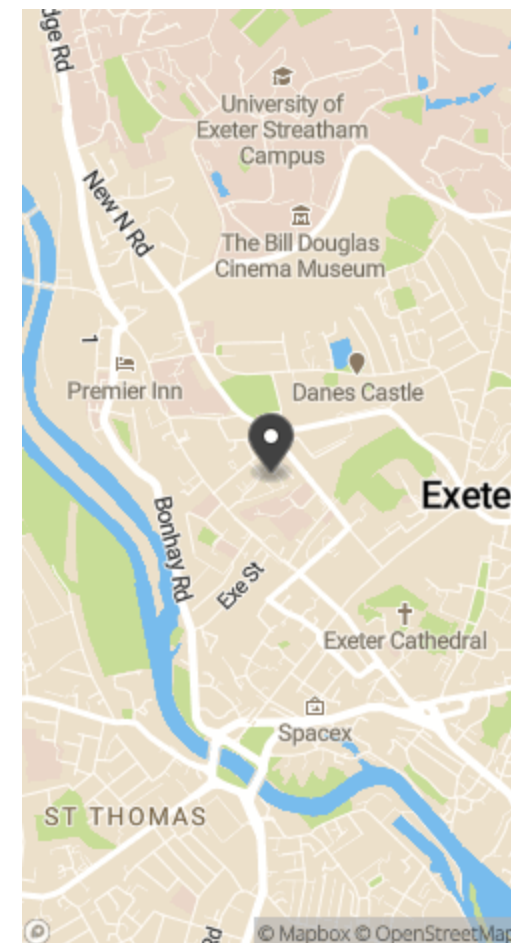

Tenure Type: Leasehold

Council Tax Band:

Council Authority: Exeter City Council