



Glenwood Rise, Exeter, EX2 Guide Price
£325,000

Key Features

- Driveway
- Sought after location
- Close to amenities
- Front and rear gardens
- Motivated seller
- Two double bedrooms



FANTASTIC LOCATION! A rare opportunity to purchase a two bedroom bungalow on a sizeable plot situated on the outskirts of the city centre tucked away in the quiet residential area of Glenwood Rise.





Entering the bungalow, you are greeted by a spacious entrance hall that provides access to all the principal rooms. To the right, you will find the generous kitchen, which enjoys views over the rear garden. In brief, the kitchen offers plenty of worktop space, along with base and eye-level units, an integrated electric double oven, and space and plumbing for a dishwasher and fridge-freezer.

Continuing through the hallway, on the right is the living room, which is a fantastic size and offers plenty of room for sizeable furniture. French doors provide access to the beautiful rear garden. There is also space for a small dining table.

The property also features two spacious double bedrooms, both offering ample space for bedroom furniture, with the master room benefiting from fitted wardrobes.

There is a newly refurbished wet room, conveniently located for easy access from all principal rooms. It incorporates a WC, wash hand basin, and shower.

The bungalow is pleasantly surrounded by front and rear gardens. The rear garden is a great size and is fully laid to lawn with shrub borders, while the front garden is split into different tiers with paving and additional space for any keen gardener to make their own. There is also a useful outbuilding attached to the side of the property, perfect for storing garden or household essentials.

The front of the property features a driveway providing parking for one vehicle.



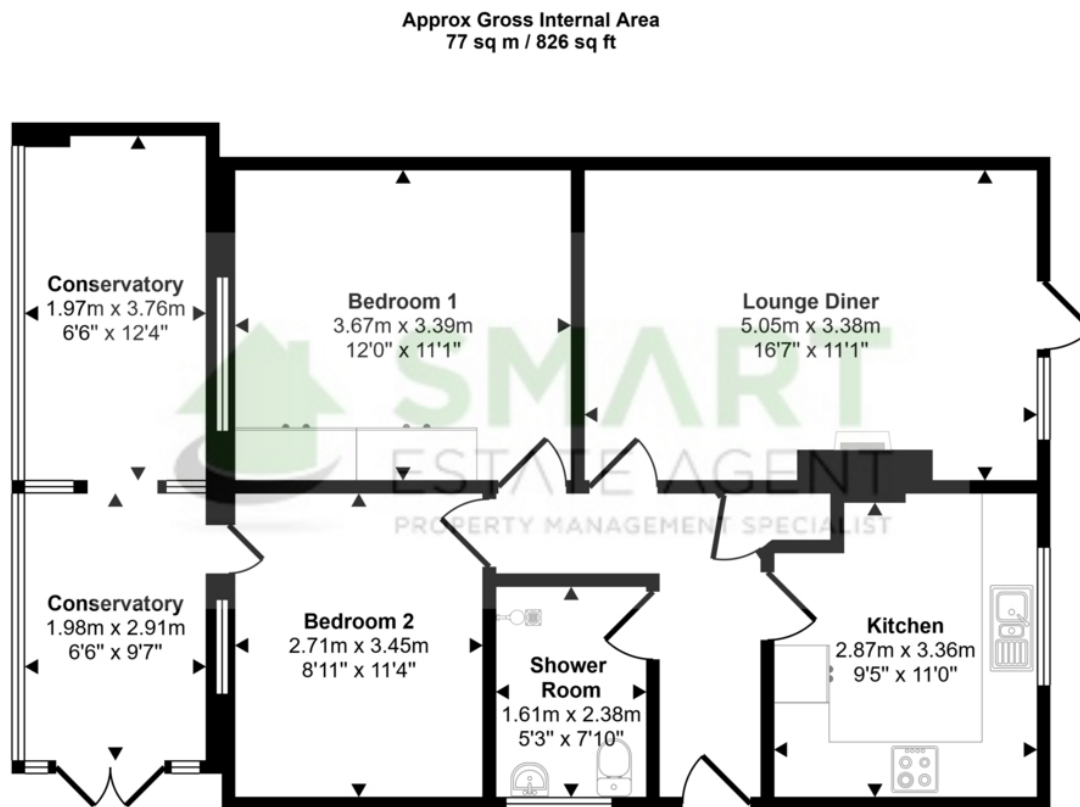

Floorplan

This floorplan is only for illustrative purposes and is not to scale. Measurements of rooms, doors, windows, and any items are approximate and no responsibility is taken for any error, omission or mis-statement. Icons of items such as bathroom suites are representations only and may not look like the real items. Made with Made Snappy 360.

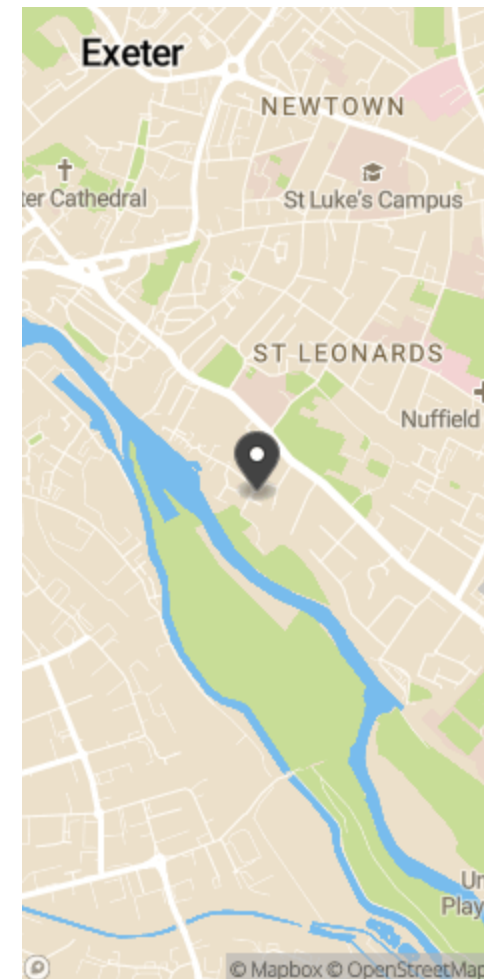

Tenure Type: Freehold

Council Tax Band: C

Council Authority: Exeter City Council