



Pinhoe Road, Exeter, EX4

Guide Price £250,000

Smart Estate Agent - Exeter

www.smartestateagent.co.uk | 01392 905 906



SMART
ESTATE AGENT
PROPERTY MANAGEMENT SPECIALIST



- Two double bedrooms
- Garage
- Convenient location
- Low maintenance rear garden
- Open plan kitchen

Upon entering the home, you are welcomed by a convenient entrance porch perfect for storing coats and shoes. Following on from the entrance porch you will find the sizeable living area which offers ample room for furniture in addition to being light and airy thanks to the large double-glazed upvc window facing the front of the property.

The kitchen diner is situated to the rear of the property and provides access to the rear garden. The kitchen itself is well equipped with a range of base and eye level units, space and plumbing for a dishwasher and washing machine, as well as space for a fridge/freezer and cooker. As a whole the kitchen is a great size and incorporates enough space to include a dining table.

On the first floor are two well-proportioned double bedrooms with the master room being especially sizeable with fitted wardrobes and plenty of space for bedroom furniture. The three-piece shower room is located within easy access to both bedrooms and incorporates a WC, wash hand basin and generous sized shower.

To the rear of the property, you will find a low maintenance garden providing the perfect space for sitting in the sun in the summer month or alfresco dining. You will also find gated access to the garage which is conveniently located at the end of the block.





-  2
-  1
-  1



Approx Gross Internal Area
66 sq m / 709 sq ft

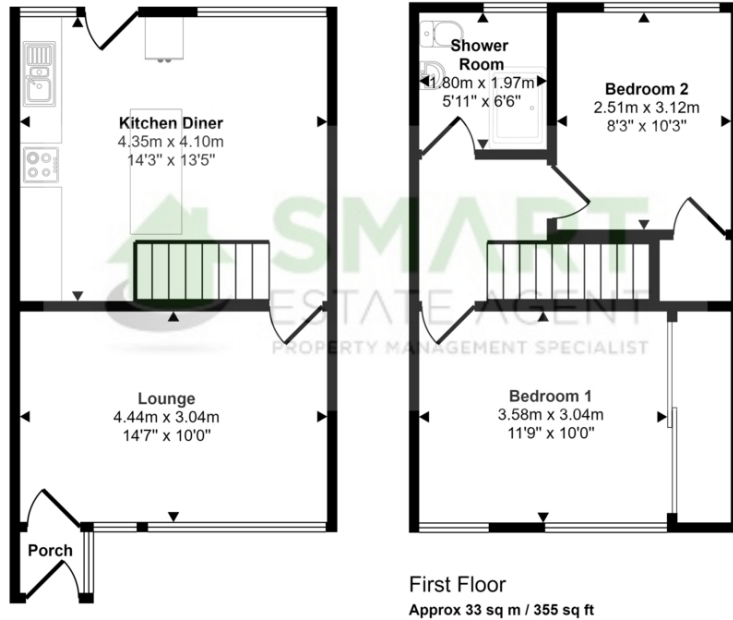

This floorplan is only for illustrative purposes and is not to scale. Measurements of rooms, doors, windows, and any items are approximate and no responsibility is taken for any error, omission or mis-statement. Icons of items such as bathroom suites are representations only and may not look like the real items. Made with Made Snappy 360.

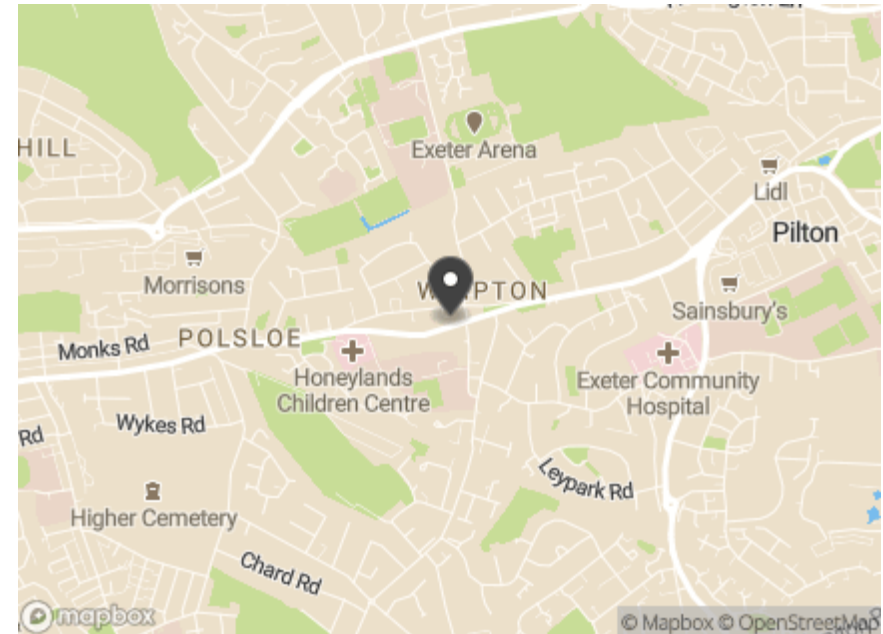

Smart Estate Agent - Exeter

10 Southernhay West, , Exeter, EX1 1JG

www.smartestateagent.co.uk | 01392 905 906