



Wyndham Avenue, Exeter, EX1

Guide Price £375,000





A MUST SEE superbly modernised and spacious 3 bedroom mid-terrace family sized house with original features whilst having been modernised throughout the entire home. Highlights being the open plan kitchen / dining room, large living room and garage.



Key Features

- Beautifully Modernised Throughout
- Traditional Features
- Newly Fitted Kitchen / Dining Room
- Recently Renovated
- Feature Wood Burner
- Landscaped Garden
- Garage
- Fitted Storage & Shelving
- Superb Modern Bathroom
- Local Amenities On Your Doorstep









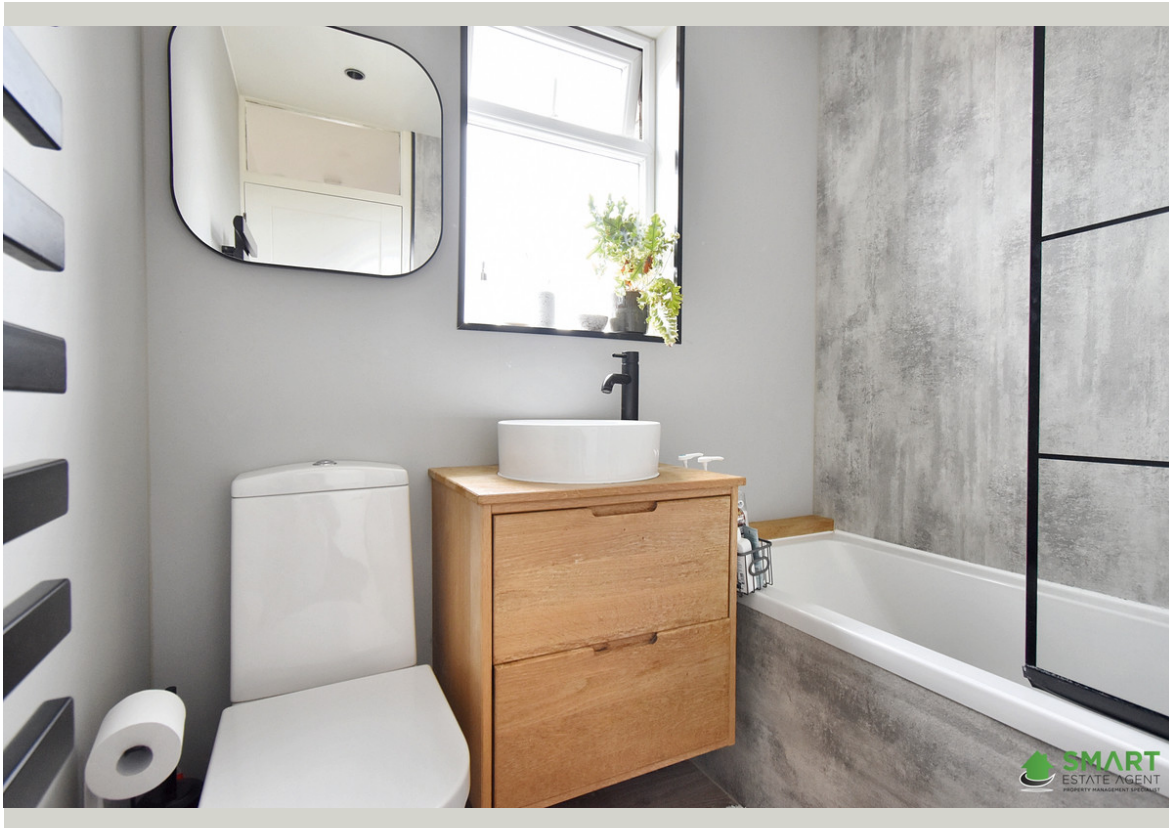



This stunning 3 bedroom home is presented to the highest of standards. The property has 3 bedrooms with two very large doubles, dining space following through to the newly fitted kitchen with all the essential and ample fitted storage which is a real highlight and really make it the hub of the house.

The living room has a large square bay window which gives the room a light and airy feel, timber shelves match the interior and a feature wood burner is a great addition for the winter nights.

The property has a beautiful landscaped rear garden, providing an amazing dining & socialising space, more storage fitted to the rear of the house, whilst the pathway leads down to another dining space and the rear garage.

Located on minutes from Exeter RD&E and City Centre.

Well regarded primary & secondary schools are within easy access of the property, as is Heavitree Park. The property is conveniently located close to a bus route, train station and is well situated for access to major road links including the M5 and A30.



Energy Efficiency Rating		Current	Potential
Very energy efficient - lower running costs			
(92+)	A		
(81-91)	B		87
(69-80)	C	71	
(55-68)	D		
(39-54)	E		
(21-38)	F		
(1-20)	G		
Not energy efficient - higher running costs			
England, Scotland & Wales			EU Directive 2002/91/EC

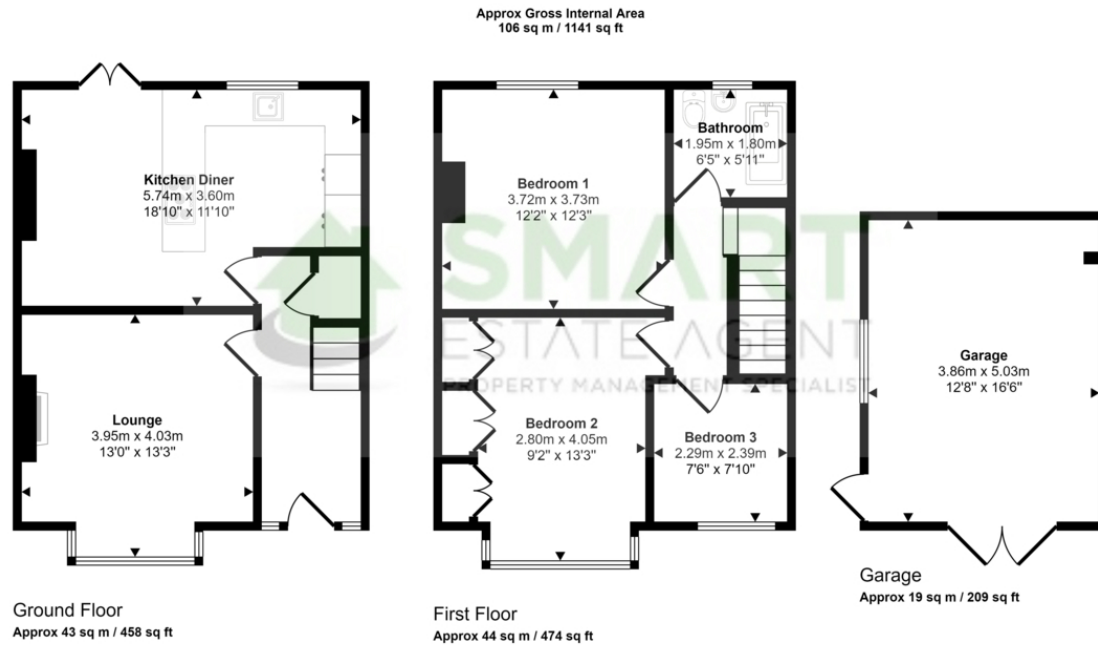

This floorplan is only for illustrative purposes and is not to scale. Measurements of rooms, doors, windows, and any items are approximate and no responsibility is taken for any error, omission or mis-statement. Icons of items such as bathroom suites are representations only and may not look like the real items. Made with Made Snappy 360.

Tenure Type: Freehold
Council Tax Band: C
Council Authority: Exeter City