

GRAS LAWN, EXETER, EX2 4RZ

GUIDE PRICE £200,000





- No Onward Chain
- One Bedroom Coachhouse
- Modern Features Throughout
- Large Living / Dining Room
- Double Bedroom with Built-in Wardrobes
- Modern Kitchen
- Modern Down Lighting
- Gas Central Heating & Double Glazing
- Allocated Parking Space
- Excellent Location for RD&E Hospital and Local Amenities

A superb opportunity to acquire this modern and well-presented one bedroom coach house with allocated parking, located within the popular residential development of Gras Lawn. The property offers convenient access to the Royal Devon & Exeter Hospital, City Centre, Exeter's Historic Quayside, and a regular bus service.



The accommodation is light and spacious throughout and comprises in brief, communal access shared with one other property, entrance hall, living room/diner, modern kitchen, double bedroom with fitted wardrobes and a bathroom. Further features include gas central heating, double glazing, and one allocated parking space. The property has access to a useful store cupboard at entrance to the communal hallway (the communal hallway is shared with the neighbouring coachhouse only).





Approx Gross Internal Area
47 sq m / 511 sq ft

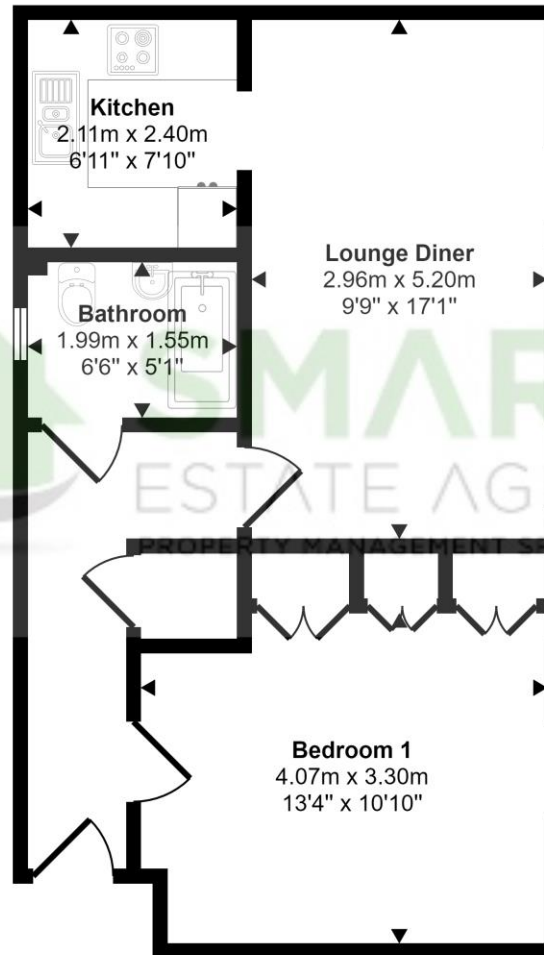

Floorplan

LEASEHOLD DETAILS Length of lease: 999 years
from 1st September 2000.

Service Charge: Approximately £650 per 6 months.

Ground Rent: £50 per 6 months

This floorplan is only for illustrative purposes and is not to scale. Measurements of rooms, doors, windows, and any items are approximate and no responsibility is taken for any error, omission or mis-statement. Icons of items such as bathroom suites are representations only and may not look like the real items. Made with Made Snappy 360.