

Deakin-White



12 Beale Street, Dunstable, Bedfordshire, LU6 1LZ

£425,000

Deakin-White are delighted to offer for sale this large family home in the highly sought after Town Centre of Dunstable in a cul-de-sac location. Accommodation includes on the ground floor an entrance hall, open plan lounge/diner, conservatory, kitchen, utility room and a WC. On the first floor there are four bedrooms with en-suite to master and a bathroom. Outside there is a mature garden, driveway and a garage. Good local schools are nearby along with local shops and transport links including the A5 and M1 Motorway.

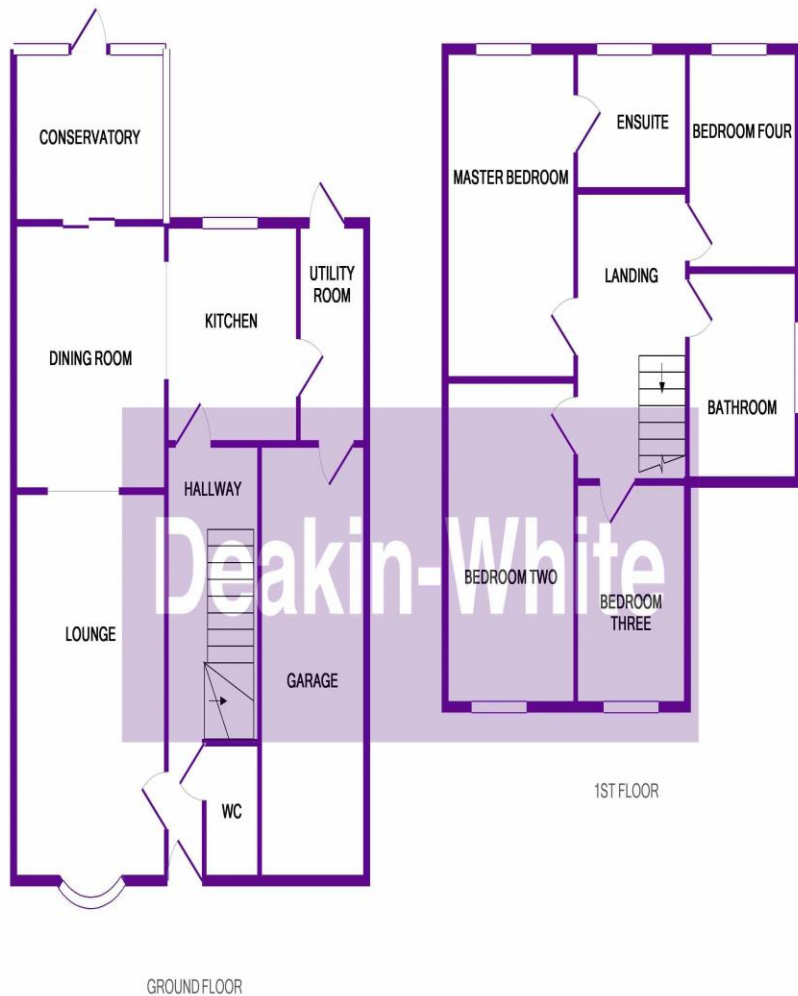

Whilst every attempt has been made to ensure the accuracy of the floor plan contained here, measurements of doors, windows, rooms and any other items are approximate and no responsibility is taken for any error, omission, or mis-statement. This plan is for illustrative purposes only and should be used as such by any prospective purchaser. The services, systems and appliances shown have not been tested and no guarantee as to their operability or efficiency can be given.

Made with Metropix ©2019

ACCOMMODATION

- Four Bedrooms
- Large Lounge/Diner
- En-Suite To Master
- Garage
- Driveway
- Close To Town Centre
- Good Transport Links



Deakin-White

Disclaimer – IMPORTANT: we would like to inform prospective purchasers that these sales particulars have been prepared as a general guide only. A detailed survey has not been carried out, nor the services, appliances and fittings tested. Room sizes should not be relied upon for furnishing purposes and are approximate. If floor plans are included, they are for guidance only and illustration purposes only and may not be to scale. If there are any important matters likely to affect your decision to buy, please contact us before viewing the property.