



## 3 Kingswear Court Castle Road

Kingswear  
£1,500 Per annum

*Freeborns*  
ESTATE AGENTS

Located in Kingswear, this charming furnished apartment on Castle Road offers tranquil living surrounded by natural beauty. The property features breath-taking views of River Dart which can be observed from the full height bay windows that invite an abundance of light. Equipped with a garage and parking, the property boasts well-maintained communal grounds and private jetty access.

Available from July 20th 2025





# 3 Kingswear Court Castle Road, South Hams, Kingswear, TQ6 0DX

## RECEPTION HALL

Double glazed windows and door to front, built-in pulldown double bed, built-in airing cupboard housing hot water tank, night storage heater, parquet flooring, loft access hatch, doors to;

## SHOWER ROOM

Frosted windows to rear, corner shower enclosure with 'mira sport' electric shower, \* suite comprising a pedestal wash hand basin, close coupled WC, chrome heated towel rail, part tiled walls, tiled floor, extractor fan, wall mounted electric fan heater.

## STEPS UP TO;

## INNER HALLWAY

Doors to;

## DRAWING ROOM

Double glazed bay window to front with window seats and views over the River Dart and towards the English Channel, night storage heater, fireplace with tiled hearth and insert, wooden surround and mantle, electric wood/wall effect fire. Wall mounted electric heater, \*\* to kitchen.

## KITCHEN

Range of modern base and wall mounted units, work surface, inset single drainer acrylic sink with swan neck mixer tap, inset 4 ring electric hob, built-in double oven and grill, built-in microwave, integrated fridge and freezer, integrated dishwasher, washing machine, tiled splashbacks, recessed ceiling downlights, under cupboard lighting, display cabinet with lighting, opening to drawing room.

## BEDROOM ONE

Double glazed full height window to side, range of built-in work surfaces and drawer units, recessed ceiling downlights.

## BEDROOM TWO

Windows to rear, wall mounted electric radiator, built-in cupboard and drawer units, overhead cupboard housing electric metre and fuse box, laminate floor.

## BATHROOM

White suite comprising a panelled bath with Victorian bath/shower mixer tap, and telephone style shower attachment, pedestal wash hand basin, close coupled WC, wall mounted electric heated towel rail, part tiled walls, wall mounted lights, extractor fan, laminate flooring.

## EPC:

To be confirmed.

## COUNCIL TAX BAND: E

## LOCAL AUTHORITY

South Hams District Council

## PLEASE NOTE

NO PETS, NO SMOKING IN PROPERTY AND NO MULTIPLE OCCUPANCY. References required together with a holding fee of 1 weeks rent and deposit of 5 weeks rent.

## CONSUMER PROTECTION FROM UNFAIR TRADING

These details are for guidance only and complete accuracy cannot be guaranteed. If there is any point, which is of particular importance, verification should be obtained. They do not constitute a contract or part of a contract. All measurements are approximate. No guarantee can be given with regards to planning permissions or fitness for purpose. No apparatus, equipment, fixture or fitting has been tested. Items shown in photographs are NOT necessarily included. Interested parties are advised to check availability and make an appointment to view before travelling to see a property.

### 3 Kingswear Court, Castle Road, Kingswear, TQ6 0DX

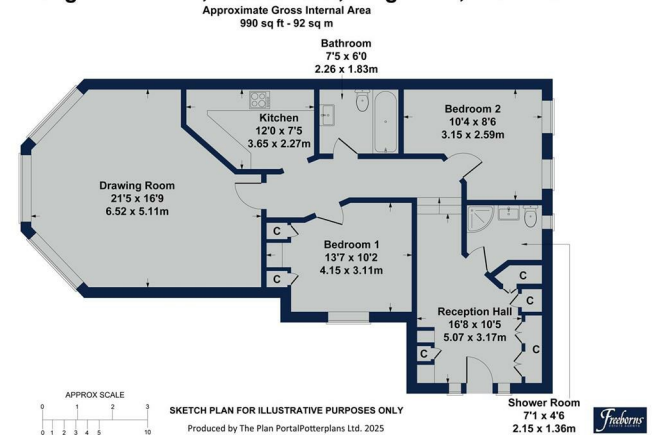

1 Mayors Avenue, Dartmouth, Devon, TQ6 9NF

Tel: 01803 832 045

[info@freebornsproperty.co.uk](mailto:info@freebornsproperty.co.uk)

[www.freebornsproperty.co.uk](http://www.freebornsproperty.co.uk)

*Freeborns*  
ESTATE AGENTS

