



14 Oakdene Avenue

ST5 8HQ

Asking Price £260,000



3



1



2



C



STEPHENSON BROWNE

Located on the charming Oakdene Avenue in Newcastle, this semi-detached house presents an excellent opportunity for families and professionals alike. Upon entering, you are greeted by a spacious entrance hall, enhanced by a feature window that bathes the area in natural light. The ground floor boasts an inviting, bright living room adorned with a bay window and an electric fireplace, creating a warm and welcoming atmosphere.

The heart of the home is undoubtedly the modern open-plan kitchen and dining area, which overlooks the neatly presented garden. This stylish kitchen is equipped with an integrated fridge-freezer, dishwasher, induction hob, and built-in oven, making it both functional and aesthetically pleasing. A convenient W.C. is located under the stairs, complete with plumbing for a washing machine, adding to the practicality of the space.

Venturing upstairs, you will find three well-proportioned bedrooms, with two offering ample space and one currently serving as a study. The family bathroom is easily accessible, and bedroom one features a wall recess, perfectly suited for a television. A useful boiler cupboard provides additional storage solutions.

Externally, the property is equally impressive, featuring a large driveway that accommodates up to three vehicles, along with a garage for extra storage or parking. The front of the house boasts a raised gravelled area, enhancing its kerb appeal with a smart, low-maintenance finish. The rear garden is designed for easy upkeep, featuring a lawn bordered by gravel and a paved area ideal for outdoor dining. A small attached shed provides a convenient space for garden tools and equipment.

This delightful property combines comfort, style, and practicality, making it a perfect choice for those seeking a lovely home in a desirable location.

Council Borough: Newcastle Under Lyme
Council Tax Band: C
Tenure: Freehold



Ground Floor

Entrance Hall

13'11" x 6'4"

Living Room

12'5" x 10'7"

Open Plan Kitchen/Dining Area

Dining Room

12'4" x 11'11"

Kitchen

5'7" x 11'0"

W.C./Utility

6'2" x 7'5"

Garage

18'1" x 8'11"

First Floor

Bathroom

6'4" x 6'10"

Bedroom One

10'10" x 12'2"

Bedroom Two

10'10" x 12'7"

Bedroom Three/Study

6'5" x 6'8"

Boiler Room

2'7" x 3'9"

Stephenson Browne AML Disclosure

Agents are required by law to conduct Anti-Money Laundering checks on all those buying a property. Stephenson Browne charge £49.99 plus VAT for an AML check per purchase transaction . This is a non-refundable fee. The charges cover the cost of obtaining relevant data, any manual checks that are required, and ongoing monitoring. This fee is payable in advance prior to the issuing of a memorandum of sale on the property you are seeking to buy.



- Well-presented three-bedroom semi-detached home in a sought-after location
- Bright bay-fronted lounge with feature electric fireplace
- Stylish open-plan kitchen/dining room with modern integrated appliances
- Spacious entrance hall with feature window and convenient downstairs W.C. with plumbing for washing machine
- Two generous double bedrooms, one with bay window, plus a third bedroom/study
- Family bathroom and additional storage via a boiler cupboard
- Recently serviced boiler and fully double-glazed throughout for comfort and efficiency
- Attractive low-maintenance raised gravel frontage enhancing kerb appeal
- Large driveway with space for up to three cars, plus garage and attached shed
- Blinds included subject to negotiation





Floor Plan

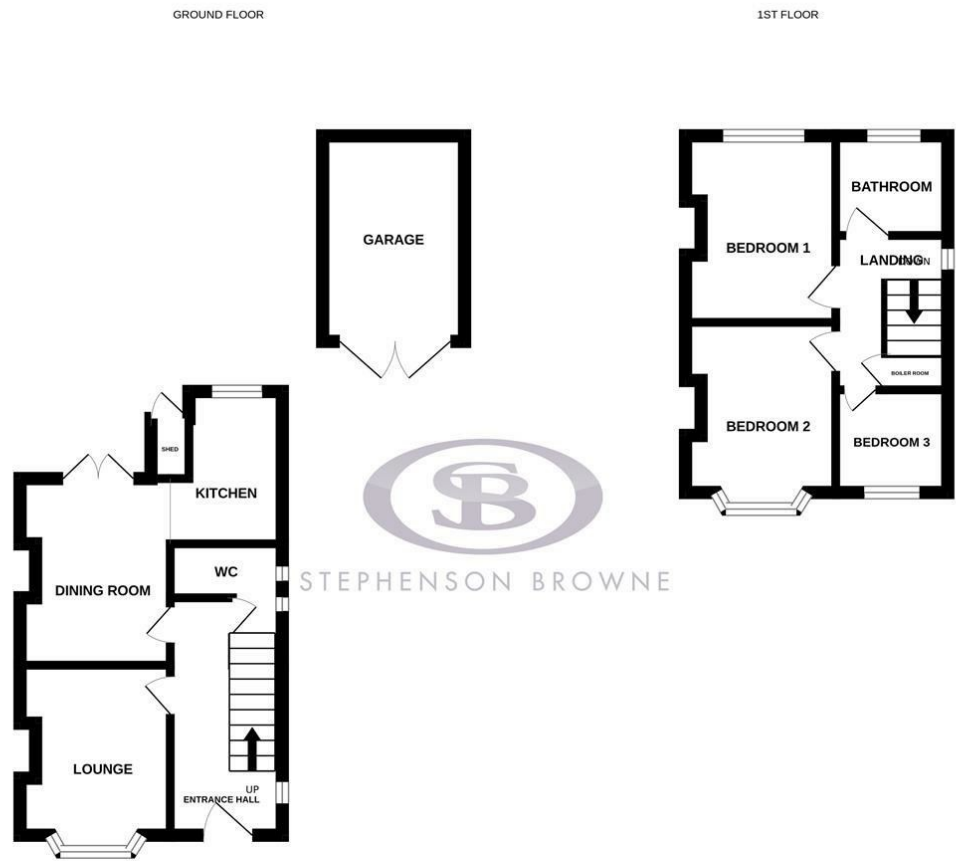

Whilst every attempt has been made to ensure the accuracy of the floorplan contained here, measurements of doors, windows, rooms and any other items are approximate and no responsibility is taken for any error, omission or mis-statement. This plan is for illustrative purposes only and should be used as such by any prospective purchaser. The services, systems and appliances shown have not been tested and no guarantee as to their operability or efficiency can be given.
Made with Metropix ©2025

Area Map

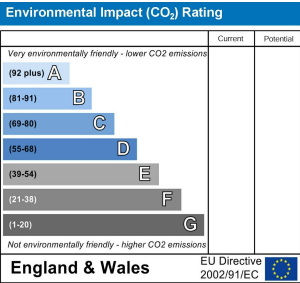
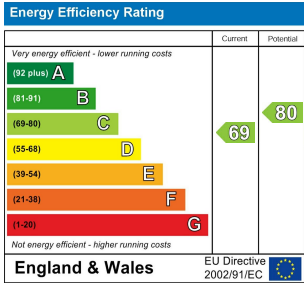
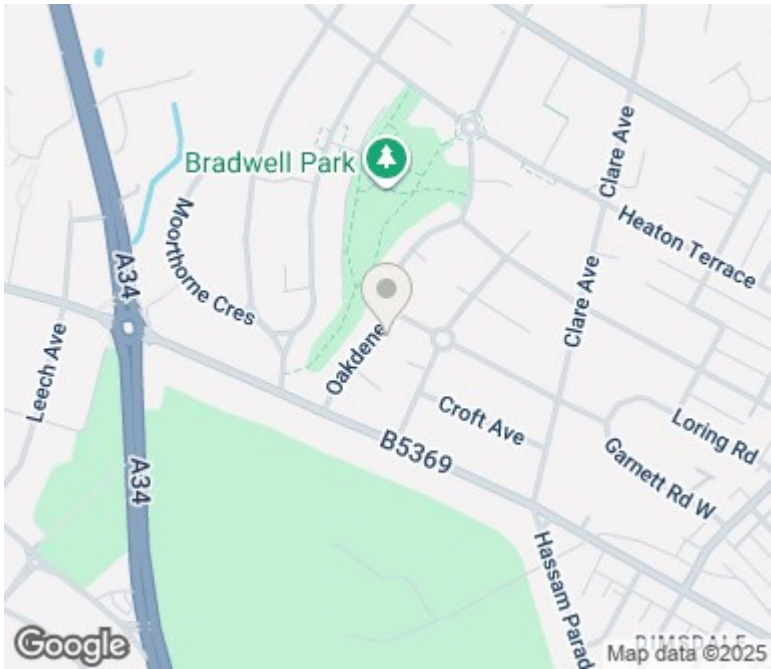

Viewing

Please contact our Newcastle-Under-Lyme Office on 01782 625734 if you would like to arrange a viewing appointment or require any further information.

NOTICE: Stephenson Browne for themselves and for the vendors or lessors of this property whose agents they are give note that: (1) the particulars are set out as a general guideline only for the guidance of intending purchasers or lessees. and do not constitute, nor constitute part of, an offer or contract; (2) all descriptions, dimensions, references to condition and necessary permissions for use and occupation, and other details are given in good faith and are believed to be correct but any intending purchasers or tenants should not rely on them as statements or representations of fact but must satisfy themselves by inspection or otherwise as to be the correctness of each theme; (3) no person in the employment of Stephenson Browne has any authority to make representation or warranty in relation to this property; (4) fixtures and fittings are subject to a formal list supplied by the vendors solicitor. Referring to: Move with Us Ltd Average fee: £123.64