



High Street
Wolstanton



£77,950

56 Merrial Street
Newcastle under Lyme
ST5 2AW
01782 625734



48 Adlington House High Street Wolstanton ST5 0HZ

A well presented and very spacious, Over-55s luxury retirement apartment. Adlington House luxury retirement apartments provide the perfect setting for an independent lifestyle with 24-hour on site care, should you ever need it and a wonderful community to become a part of.

This apartment is a fabulous one double bedroom unit, on the second floor, with large open aspect lounge diner, a fully integral modern kitchen, wardrobe storage, utility cupboard and walk-in shower room. Very well presented throughout with excellent proportions and thoughtful design.

To mention only a few benefits of the unique Adlington House concept, residents can enjoy audio and visual entry system to the main entrance, lifts to all floors, beautifully landscaped and manicured communal gardens, in-house subsidised restaurant and many recreational rooms to include a craft room, communal lounge and indoor hairdressing salon and a further private function room.

Contact Stephenson Browne Estate Agents for full details and to arrange a viewing appointment.

NO ONWARD CHAIN.

Council Borough: Newcastle-Under-Lyme

Council Tax Band: C

Tenure: Leasehold

The apartment is subject to a 125 years lease from April 1st 2014 with service charges and wellbeing charges payable at all times.

LEASE LENGTH - 125 years from 1st May 2014

SERVICE CHARGE - £383.61 pcm

WELLBEING CHARGE - £269.87 pcm

GROUND RENT - N/A

UTILITIES CHARGE - Water charges included in the service charge.

MANAGEMENT COMPANY - MHA (Methodist Homes)

NB: Full key leasehold facts and up to date wellbeing charge information available upon request.



£77,950

Entrance Hallway 8'11" x 8'4" (2.73 x 2.55)
Lounge Diner 22'10" x 11'3" max (6.96 x 3.45 max)
Kitchen 8'8" x 7'10" (2.65 x 2.41)
Bedroom 12'6" x 11'1" (3.82 x 3.40)
Shower Room 8'3" x 5'9" (2.53 x 1.77)
Utility Cupboard 7'1" x 4'0" (2.17 x 1.24)

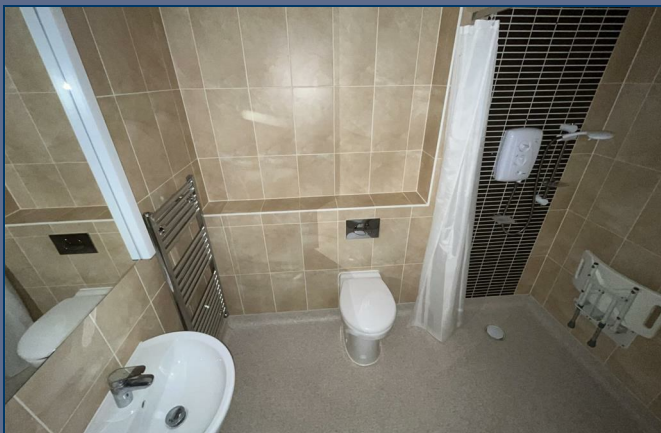

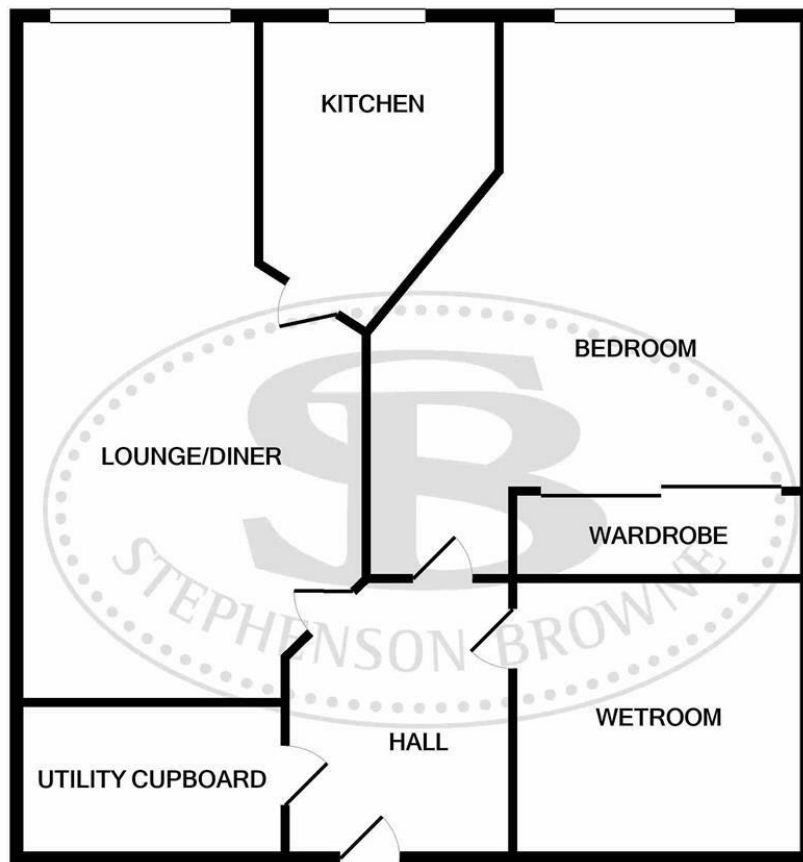

Whilst every attempt has been made to ensure the accuracy of the floor plan contained here, measurements of doors, windows, rooms and any other items are approximate and no responsibility is taken for any error, omission, or mis-statement. This plan is for illustrative purposes only and should be used as such by any prospective purchaser. The services, systems and appliances shown have not been tested and no guarantee as to their operability or efficiency can be given
Made with Metropix ©2021

Stephenson Browne Estate Agents

Newcastle
56 Merrial Street, Newcastle under Lyme
Staffordshire, ST5 2AJ
Tel: 01782 625734

Sandbach
38 High Street, Sandbach
Cheshire, CW11 1AN
Tel: 01270 763200

Alsager
13 Crewe Road, Alsager
Stoke on Trent, ST7 2EW
Tel: 01270 883130

NOT TO SCALE These floor plans are given as a guide only. Full completed measurements and details should be verified by any intending purchasers legal representative.

NOTICE: Stephenson Browne for themselves and for the vendors or lessors of this property whose agents they are give notice that: (1) the particulars are set out as a general guideline only for the guidance of intending purchasers or lessees, and do not constitute, nor constitute part of, an offer or contract; (2) all descriptions, dimensions, references to condition and necessary permissions for use and occupation, and other details are given in good faith and are believed to be correct but any intending purchasers or tenants should not rely on them as statements or representations of fact but must satisfy themselves by inspection or otherwise as to the correctness of each theme; (3) no person in the employment of Stephenson Browne has any authority to make representation or warranty whatever in relation to this property. (4) fixtures & fittings are subject to a formal list supplied by the vendors solicitors.