



Priory Park Road, NW6

£1,750 pcm



- One Bedroom
- Own Private Entrance
- Spacious
- Period Conversion
- Close to Transport
- Modern

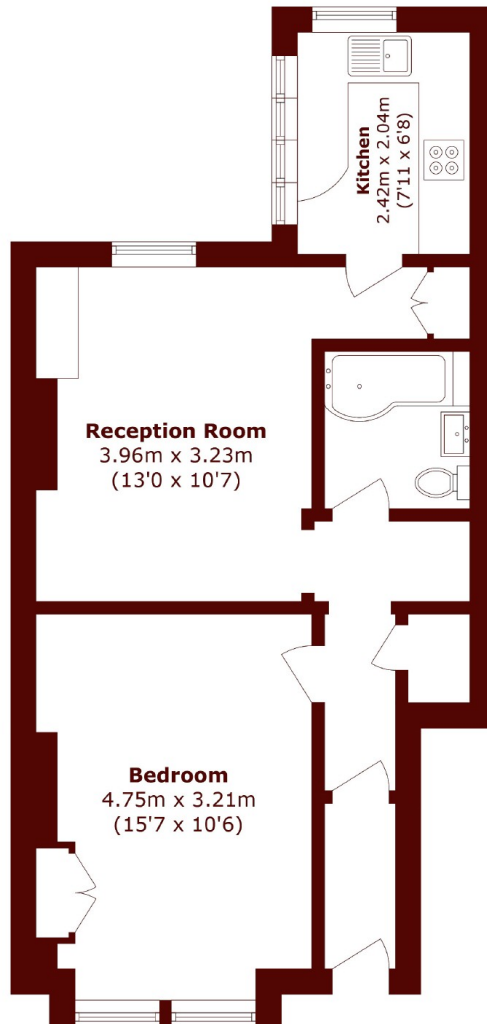

Total area (approx.): 46.3 sq. m (498.3 sq. ft)

Marsh & Parsons Willesden Green

291-293 Willesden Lane,
London, NW2 5HY
020 8451 0420