



## Victoria Road, NW6

£1,900 pcm



- One Bedroom Flat
- Raised Ground Floor

- Open Plan
- Large Bedroom

- Close to Transport
- Near High Street

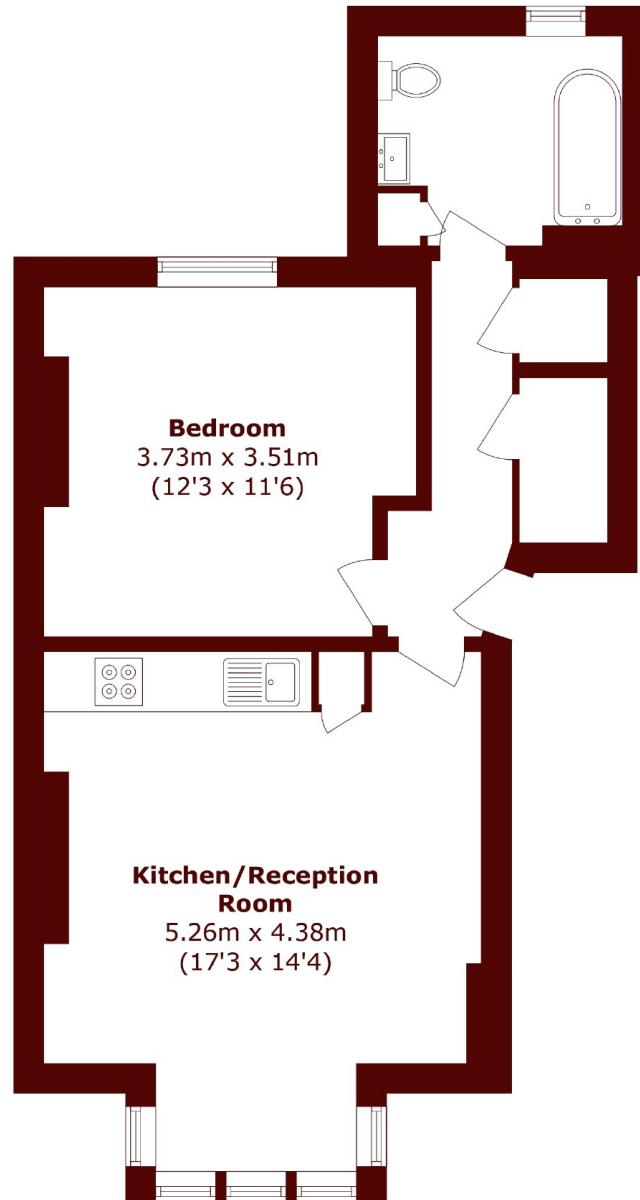

Total area (approx.): 45.6 sq. m (490.8 sq. ft)

## Marsh & Parsons Queens Park

91 Salusbury Road, London,  
NW6 6NH  
020 7624 4513