



28 Leavesden Court Mallard Road

Abbots Langley, WD5 0GT

£330,000

Welcome to this charming property located on Mallard Road in Abbots Langley! This delightful flat boasts a spacious 800 sq ft of living space, featuring one reception room, two cosy bedrooms, and a modern bathroom.

Situated in a beautiful block with well-maintained surrounding grounds, this property offers a serene and picturesque setting for you to call home. With the added convenience of two parking spaces, you'll never have to worry about finding a spot for your vehicle.

One of the highlights of this property is its prime location, within walking distance to local shops, making errands and shopping a breeze. Additionally, the property is conveniently located near the stunning Leavesden Country Park, perfect for leisurely strolls and enjoying the outdoors.

Don't miss out on the opportunity to own or rent this lovely flat in Abbots Langley. Contact us today to arrange a viewing and experience the charm and convenience this property has to offer!

- Two Bedroom Ground Floor Apartment
- Beautiful Surrounding Grounds
- Long Lease Length
- Walking Distance To Local Shops
- Leavesden Country Park
- Two Allocated Parking Spaces
- Local Schools Walking Distance
- Viewing Highly Advised

Viewing

Please contact our Abbots Langley Office on 01923262666 if you wish to arrange a viewing appointment for this property or require further information.



Floor Plan

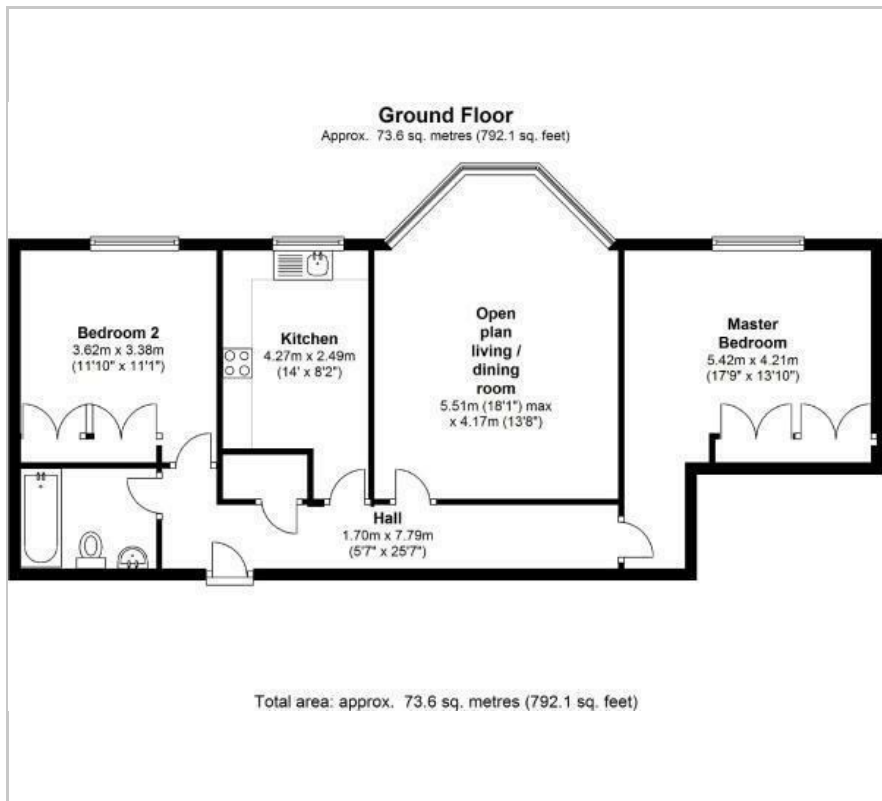

Area Map

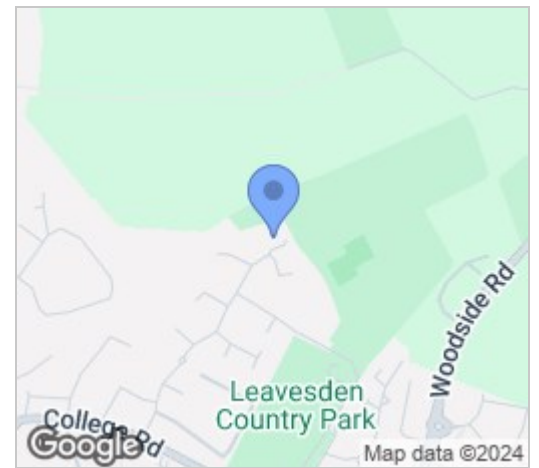

Energy Efficiency Graph

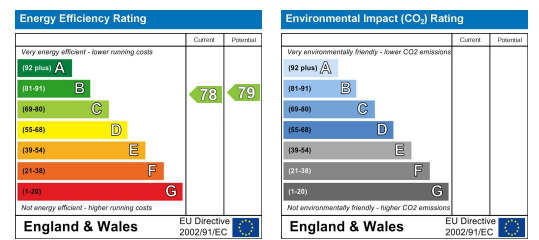

These particulars, whilst believed to be accurate are set out as a general outline only for guidance and do not constitute any part of an offer or contract. Intending purchasers should not rely on them as statements of representation of fact, but must satisfy themselves by inspection or otherwise as to their accuracy. No person in this firm's employment has the authority to make or give any representation or warranty in respect of the property.