



Dickinson House The Embankment

Hemel Hempstead, HP3 9DR

£300,000

Welcome to this charming two-bedroom, two-bathroom apartment located in the picturesque Nash Mills Wharf, Hemel Hempstead. Situated along The Embankment, this property boasts stunning canal views that will surely take your breath away.

As you step inside, you'll be greeted by a cosy reception room, perfect for relaxing or entertaining guests. The apartment features two well-appointed bedrooms, providing ample space for a small family or those in need of a guest room or home office.

One of the highlights of this property is its recent decoration, giving it a fresh and modern feel. Imagine coming home to a space that is not only inviting but also beautifully maintained.

Convenience is key with this apartment, as it is within walking distance to the train station. Whether you commute for work or enjoy exploring the surrounding areas, this location offers easy access to transportation.

Nestled in the beautiful Nash Mills area, you'll have the opportunity to enjoy the tranquility of canal-side living while still being close to local amenities and green spaces. It's the perfect blend of peaceful surroundings and urban convenience.

Don't miss out on the chance to make this apartment your new home. Contact us today to arrange a viewing and experience the beauty of living in Nash Mills Wharf for yourself.

- Two Double Bedrooms
- Ensuite to Master Bedroom
- Newly Decorated Throughout
- Newly Carpeted Throughout
- Beautiful Canal Views From Balcony
- Allocated Parking
- Walking Distance to Apsley Station
- Council Tax band D

Viewing

Please contact our Abbots Langley Office on 01923262666 if you wish to arrange a viewing appointment for this property or require further information.



Floor Plan

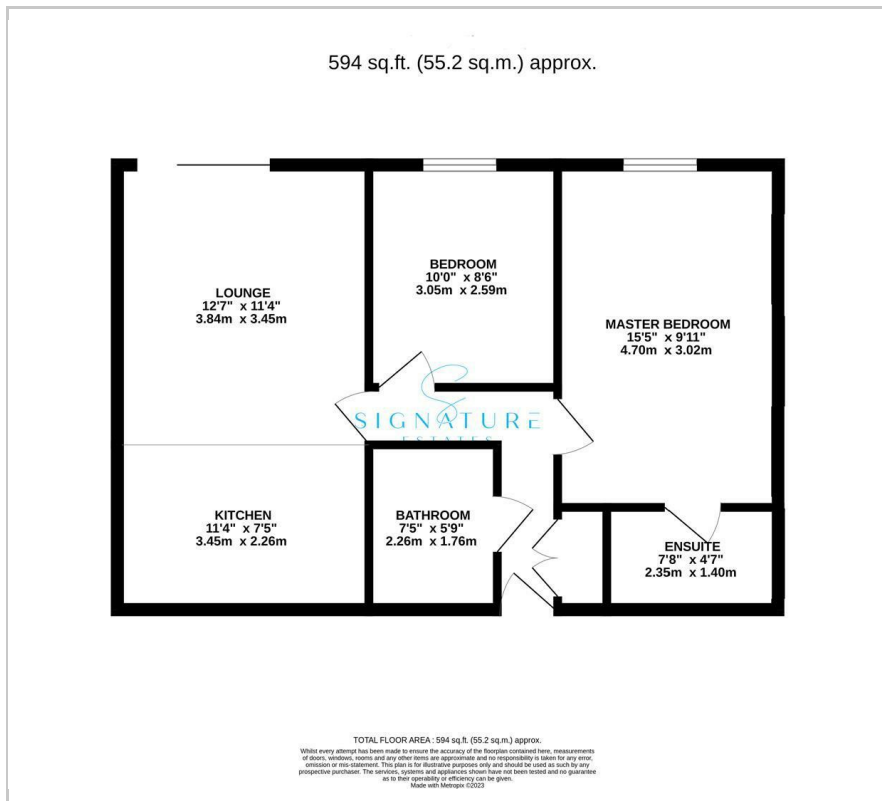

Area Map



Energy Efficiency Graph

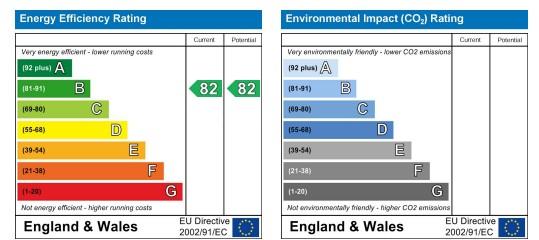

These particulars, whilst believed to be accurate are set out as a general outline only for guidance and do not constitute any part of an offer or contract. Intending purchasers should not rely on them as statements of representation of fact, but must satisfy themselves by inspection or otherwise as to their accuracy. No person in this firm's employment has the authority to make or give any representation or warranty in respect of the property.