



Dickinson House The Embankment

Hemel Hempstead, HP3 9DR

£325,000

WALKING DISTANCE TO TRAIN!!! A bright and airy two bed, two bath apartment boasting an ensuite bathroom to the master bedroom. The property has been newly decorated and carpeted throughout. Located in the beautiful Nash Mills Wharf development right next to the canal and just a 5-minute walk from Apsley station. Offered with tenants in situ.

- Two Double Bedrooms
- Ensuite to Master Bedroom
- Newly Decorated Throughout
- Newly Carpeted Throughout
- Communal Lift
- Allocated Parking
- Walking Distance to Apsley Station
- Council Tax band D

Viewing

Please contact our Abbots Langley Office on 01923262666 if you wish to arrange a viewing appointment for this property or require further information.



Floor Plan

594 sq.ft. (55.2 sq.m.) approx.

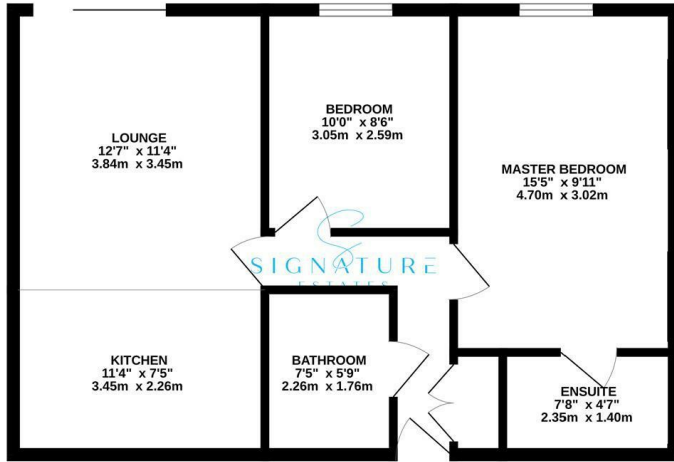

TOTAL FLOOR AREA: 594 sq.ft. (55.2 sq.m.) approx.

Whilst every attempt has been made to ensure the accuracy of the floorplan contained herein, measurements of floors, windows, rooms and any other items are approximate and no responsibility is taken for any error, omission or mis-statement. This plan is for illustrative purposes only and should be used as such by any prospective purchaser. The services, fixtures and appliances shown have not been tested and no guarantee as to their operability or efficiency can be given. Made with MetreX 10/23

Area Map



Energy Efficiency Graph

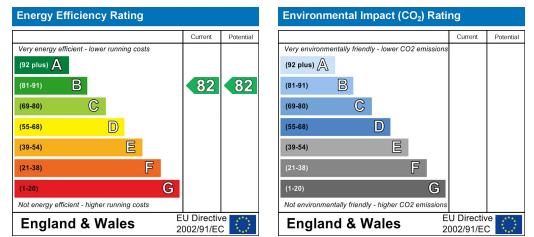

These particulars, whilst believed to be accurate are set out as a general outline only for guidance and do not constitute any part of an offer or contract. Intending purchasers should not rely on them as statements of representation of fact, but must satisfy themselves by inspection or otherwise as to their accuracy. No person in this firm's employment has the authority to make or give any representation or warranty in respect of the property.

67 High Street, Abbots Langley, Hertfordshire, WD5 0AT

T: 01923262666 | E: abbots@signatureestates.co.uk | www.signatureestates.co.uk