

BRUNTON

RESIDENTIAL

MANOR CHARE APARTMENTS, NEWCASTLE UPON TYNE, NE1

Offers Over £175,000

BRUNTON

RESIDENTIAL





BRUNTON

RESIDENTIAL



BRUNTON

RESIDENTIAL



FIRST FLOOR APARTMENT - CITY CENTRE LOCATION - SECURE ALLOCATED PARKING - INVESTMENT OPPORTUNITY

Brunton Residential are delighted to offer to the market for sale, this fantastic two bedroom apartment situated on Manor Chare in Newcastle City Centre. The apartment is within walking distance to Newcastle Railway Station, as well as various bus links, Metro Stations, Quayside, the International Centre for Life and retail stores.

The Property has been previously rented for £1500pcm

BRUNTON

RESIDENTIAL



BRUNTON

RESIDENTIAL

Accommodation briefly comprises; secure communal entrance with the property on the first floor. The apartment has a large entrance hallway with store cupboard which leads to the open plan lounge, kitchen and dining area with French doors leading to the balcony which is the full-width of the property. The kitchen itself has been recently installed and provides a range of wall and floor units, coordinated work surfaces and fitted appliances. The master bedroom has fitted wardrobes and access to an ensuite shower room whilst bedroom two is large enough to fit a double bed and furniture. Finally, there is a tiled bathroom with WC, basin and shower over bath. The property also benefits from an allocated parking space in a secure basement car park.



BRUNTON

RESIDENTIAL

TENURE : Leasehold

LOCAL AUTHORITY : Newcastle

COUNCIL TAX BAND : D

EPC RATING : C

First Floor
Approx. 73.3 sq. metres (789.3 sq. feet)

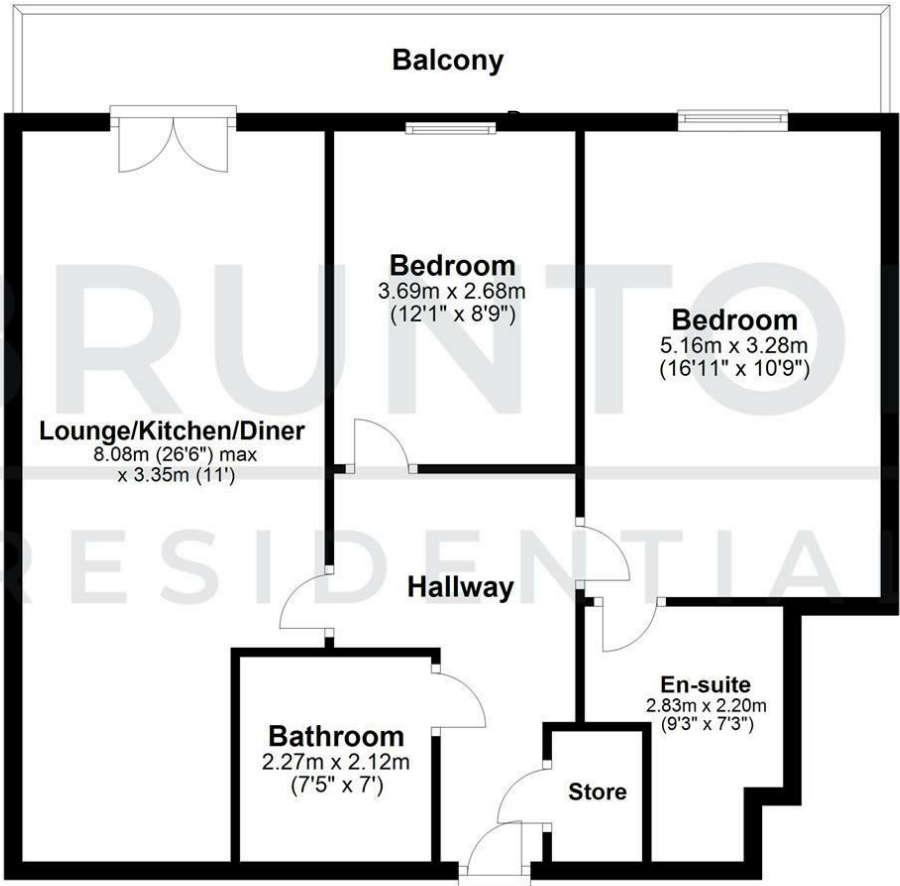

All measurements are approximate and are for illustration only.
Plan produced using PlanUp.



Energy Efficiency Rating		
	Current	Potential
Very energy efficient - lower running costs		
(92 plus) A		
(81-91) B		
(69-80) C		
(55-68) D		
(39-54) E		
(21-38) F		
(1-20) G		
Not energy efficient - higher running costs		
EU Directive 2002/91/EC		
England & Wales		

Environmental Impact (CO ₂) Rating		
	Current	Potential
Very environmentally friendly - lower CO ₂ emissions		
(92 plus) A		
(81-91) B		
(69-80) C		
(55-68) D		
(39-54) E		
(21-38) F		
(1-20) G		
Not environmentally friendly - higher CO ₂ emissions		
EU Directive 2002/91/EC		
England & Wales		