

BRUNTON

RESIDENTIAL



NORTH TERRACE, NEWCASTLE UPON TYNE, NE2

£230,000

BRUNTON

RESIDENTIAL





BRUNTON

RESIDENTIAL





TWO BEDROOMS – WELL-PRESENTED FLAT – FANTASTIC LOCATION

Brunton Residential are delighted to offer for sale this well-presented two-bedroom flat, located on North Terrace in Newcastle Upon Tyne.

This property features two well-proportioned bedrooms, a spacious lounge, and a modern fitted kitchen.

Situated in Spital Tongues, this property offers easy access to Newcastle city centre, nearby hospitals, and university campuses. The area appeals to a wide range of buyers and benefits from local amenities, green spaces, and excellent public transport links.

BRUNTON

RESIDENTIAL



BRUNTON

RESIDENTIAL

Upon entering the property, you are welcomed into an entrance hall which provides access to a spacious open-plan lounge/kitchen, featuring front aspect windows that allow for plenty of natural light. The kitchen is well equipped with a range of floor and wall units, wood-effect flooring, granite worktop surfaces, and integrated appliances including an oven, hob, and extractor fan, along with space for additional appliances.

From the lounge/kitchen, a door leads into an inner hallway, giving access to a bathroom fitted with a bath, overhead shower, washbasin, and WC. The hallway also houses a useful storage unit containing the central heating system.

At the end of the hallway, you have access to two well-proportioned bedrooms, one of which benefits from dual aspect windows.



BRUNTON

RESIDENTIAL

TENURE : Freehold

LOCAL AUTHORITY : Newcastle

COUNCIL TAX BAND : A

EPC RATING : C

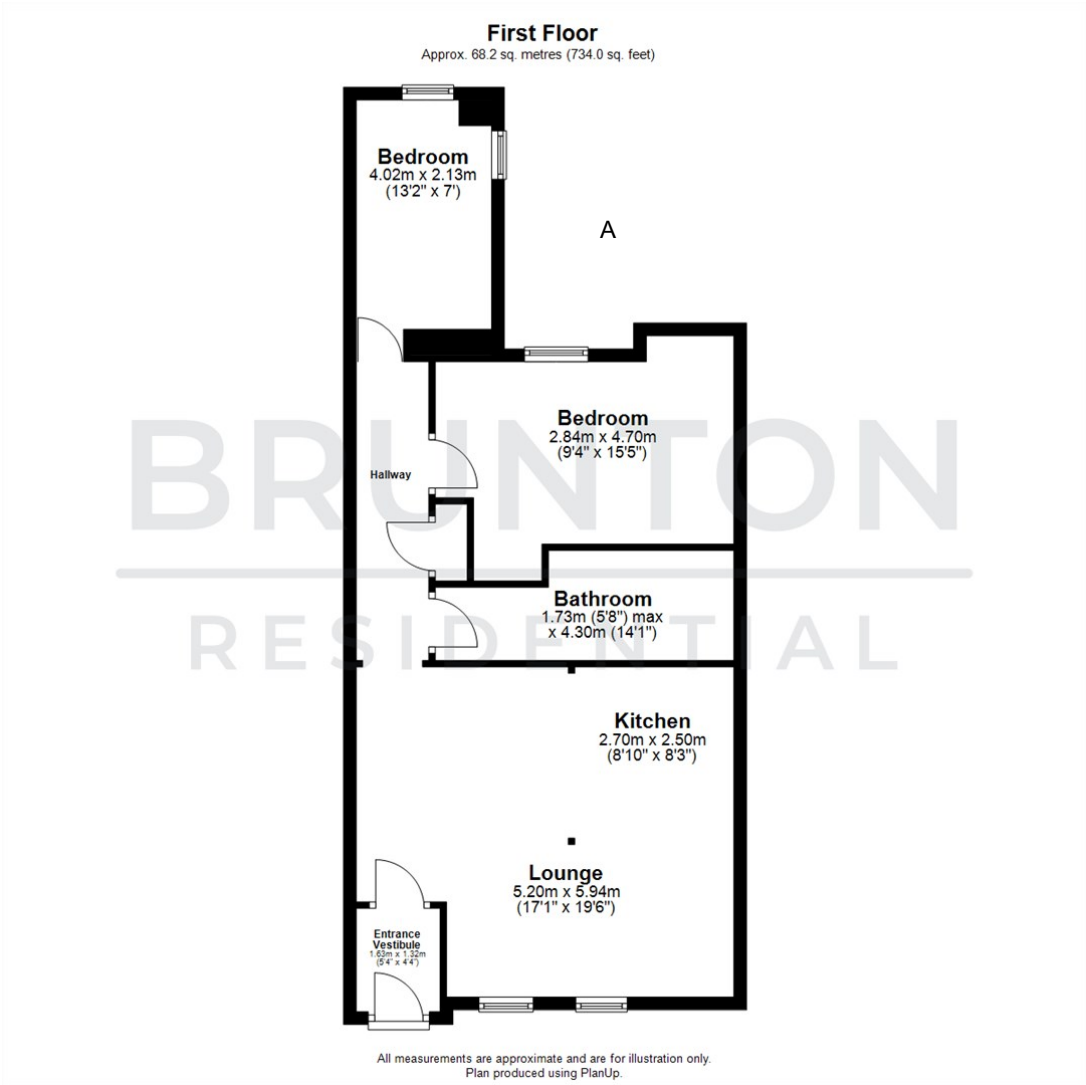

Energy Efficiency Rating		
	Current	Potential
Very energy efficient - lower running costs		
(92 plus) A		
(81-91) B		
(69-80) C		
(55-68) D		
(39-54) E		
(21-38) F		
(1-20) G		
Not energy efficient - higher running costs		
England & Wales	EU Directive 2002/91/EC	

Environmental Impact (CO ₂) Rating		
	Current	Potential
Very environmentally friendly - lower CO ₂ emissions		
(92 plus) A		
(81-91) B		
(69-80) C		
(55-68) D		
(39-54) E		
(21-38) F		
(1-20) G		
Not environmentally friendly - higher CO ₂ emissions		
England & Wales	EU Directive 2002/91/EC	