

# BRUNTON

---

## RESIDENTIAL



**THERESA STREET, BLAYDON-ON-TYNE, NE21**

**£139,950**

# BRUNTON

---

## RESIDENTIAL





# BRUNTON

---

RESIDENTIAL



# BRUNTON

---

## RESIDENTIAL



THREE BEDROOMS | TERRACED HOME | IDEAL FIRST TIME BUY

Brunton Residential are delighted to welcome to the market this well presented three bedroom terraced family home on the ever popular Theresa Street in Blyden with enclosed gardens, four piece bathroom and the benefit of being freehold.

For more information on this and to book your viewing please call our team on 0191 236 8347.

# BRUNTON

---

## RESIDENTIAL



# BRUNTON

---

## RESIDENTIAL

Set on the pedestrianised Theresa Street in a desirable area on Blaydon with a number of amenities at hand this stunning property briefly comprises: entrance hallway, open plan lounge diner spanning the depth of the property, kitchen with floor and wall units and access to the West facing rear yard.

Off the landing to the first floor there are three well proportioned bedrooms and the family four piece bathroom with stand alone shower.

Externally there is an enclosed garden to the front with lawned area and an private West facing yard to the rear.

Internal inspection is highly recommended to appreciate the accommodation on offer.

### Tenure

The agent understands the property to be freehold. However, this should be confirmed with a licenced legal representative.

Council Tax Band A



# BRUNTON

## RESIDENTIAL

TENURE : Freehold

LOCAL AUTHORITY :

COUNCIL TAX BAND : A

EPC RATING : C

SERVICES :

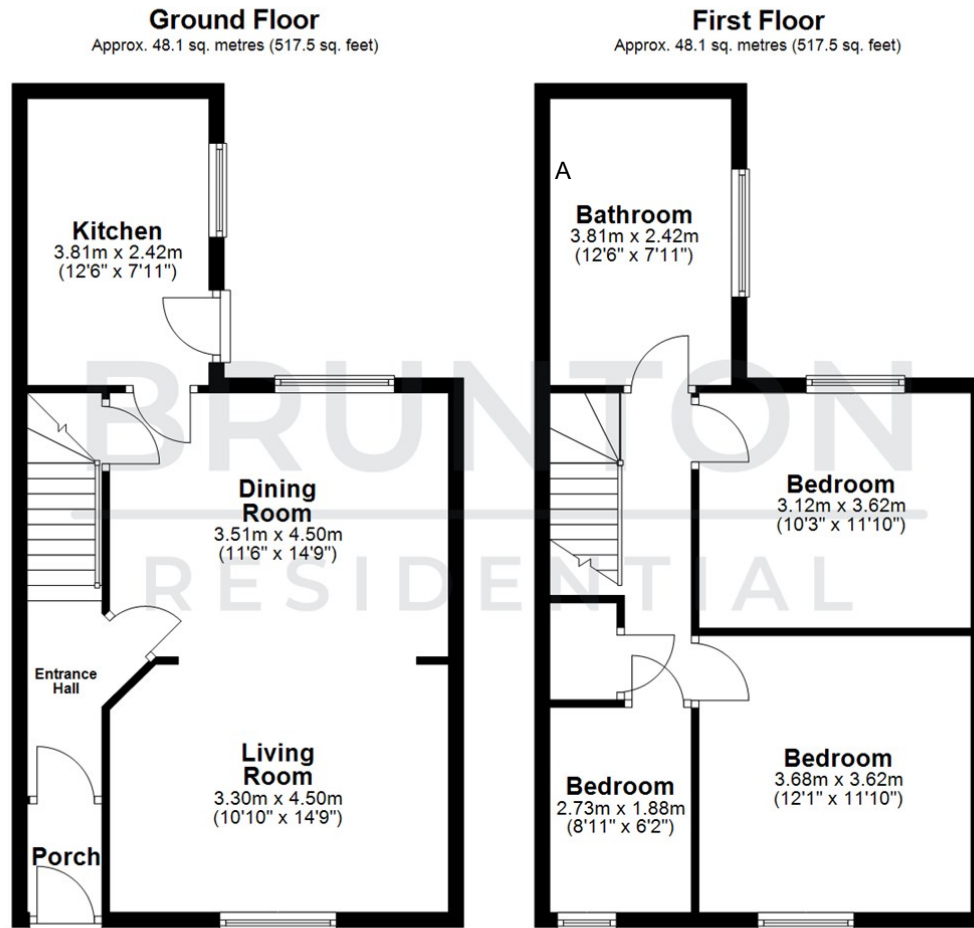

Total area: approx. 96.2 sq. metres (1035.0 sq. feet)

All measurements are approximate and are for illustration only.  
Plan produced using PlanUp.



Energy Efficiency Rating		Current	Potential
Very energy efficient - lower running costs			
(92 plus) <b>A</b>			87
(81-91) <b>B</b>			
(69-80) <b>C</b>		73	
(55-68) <b>D</b>			
(39-54) <b>E</b>			
(21-38) <b>F</b>			
(1-20) <b>G</b>			
Not energy efficient - higher running costs			
England & Wales		EU Directive 2002/91/EC	

Environmental Impact (CO <sub>2</sub> ) Rating		Current	Potential
Very environmentally friendly - lower CO <sub>2</sub> emissions			
(92 plus) <b>A</b>			
(81-91) <b>B</b>			
(69-80) <b>C</b>			
(55-68) <b>D</b>			
(39-54) <b>E</b>			
(21-38) <b>F</b>			
(1-20) <b>G</b>			
Not environmentally friendly - higher CO <sub>2</sub> emissions			
England & Wales		EU Directive 2002/91/EC	