

BRUNTON

RESIDENTIAL



HILLHEAD WAY, WESTERHOPE, NE5 5

Offers Over £150,000

BRUNTON

RESIDENTIAL





BRUNTON

RESIDENTIAL



BRUNTON

RESIDENTIAL



SOUGHT AFTER LOCATION - FOUR BEDROOMS - FRONT & REAR GARDENS

Brunton Residential are delighted to offer for sale this fantastic family home located on Hillhead Way within Westerhope, just next to Westerhope primary school. This fantastic home is in a good condition throughout,, it has four bedrooms along with gardens to the front and rear.

BRUNTON

RESIDENTIAL



BRUNTON

RESIDENTIAL

Accommodation briefly comprises of a hallway with large store cupboard, a WC and a staircase leading to the first floor. A door leads to the lounge with a window to the front while to the rear is a full width dining kitchen with doors and windows over the rear gardens. The kitchen itself offers a range of wall and floor units with coordinated work surfaces and some fitted appliances.

The first floor provides four bedrooms and a stylish family bathroom WC.

Externally there is a large garden to the rear with fenced boundaries and gated access while to the front is a lawned area with pathway access to the front door.



BRUNTON

RESIDENTIAL

TENURE : Freehold

LOCAL AUTHORITY :

COUNCIL TAX BAND : A

EPC RATING : E

SERVICES :

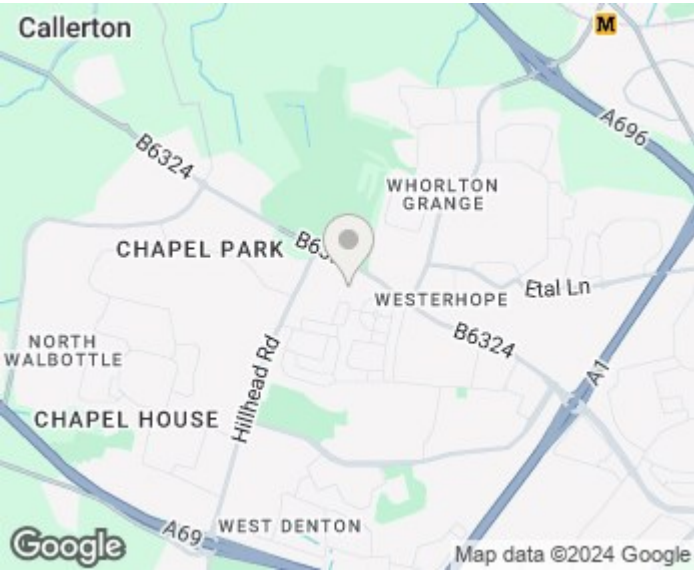
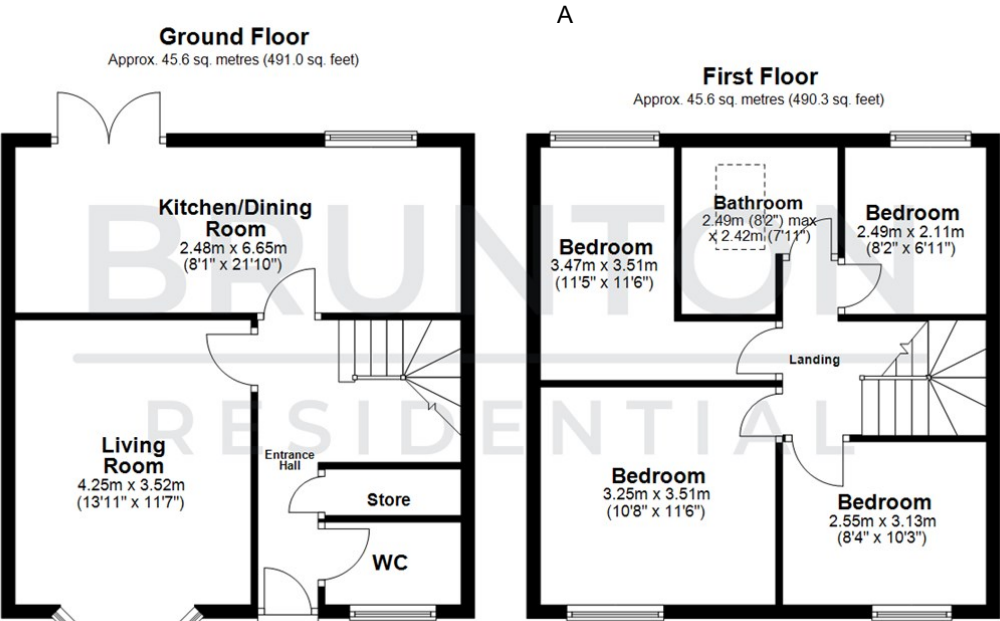

All measurements are approximate and are for illustration only.
Plan produced using PlanUp.

