

BRUNTON

RESIDENTIAL



MAPLE DRIVE, WIDDRINGTON NE61

Offers Over £115,000

BRUNTON

RESIDENTIAL





BRUNTON

RESIDENTIAL



BRUNTON

RESIDENTIAL



TWO BEDROOM - SEMI DETACHED - SOUGHT AFTER LOCATION

Brunton Residential are delighted to bring to the market this fantastic two bedroom property situated in the popular area of Maple Drive, Widdrington Station. This semi-detached home offers excellent space throughout and would make the ideal home for first time buyers or as an investment opportunity.

BRUNTON

RESIDENTIAL



BRUNTON

RESIDENTIAL

Accommodation briefly comprises of; Entrance hallway offering access to the kitchen which offers coordinated cupboard and work surfaces, some integrated appliances, and open space for kitchen furniture. There is a store cupboard and WC which can be accessed from the hallway. This then leads directly into a spacious lounge with French doors to the rear garden and the staircase can be accessed from this room which takes you to the first floor.

The first floor consists of a convenient landing space with access to two very equal-sized double bedrooms which both offer excellent space for ample bedroom furniture. There is a family bathroom that completes this floor.

The front gardens offer a private driveway whilst the rear gardens offer a large space which is made up of lawned and paved areas surrounded by fenced boundaries to allow for privacy.

BRUNTON

RESIDENTIAL

TENURE : Freehold

LOCAL AUTHORITY :

COUNCIL TAX BAND : A

EPC RATING : C

SERVICES :

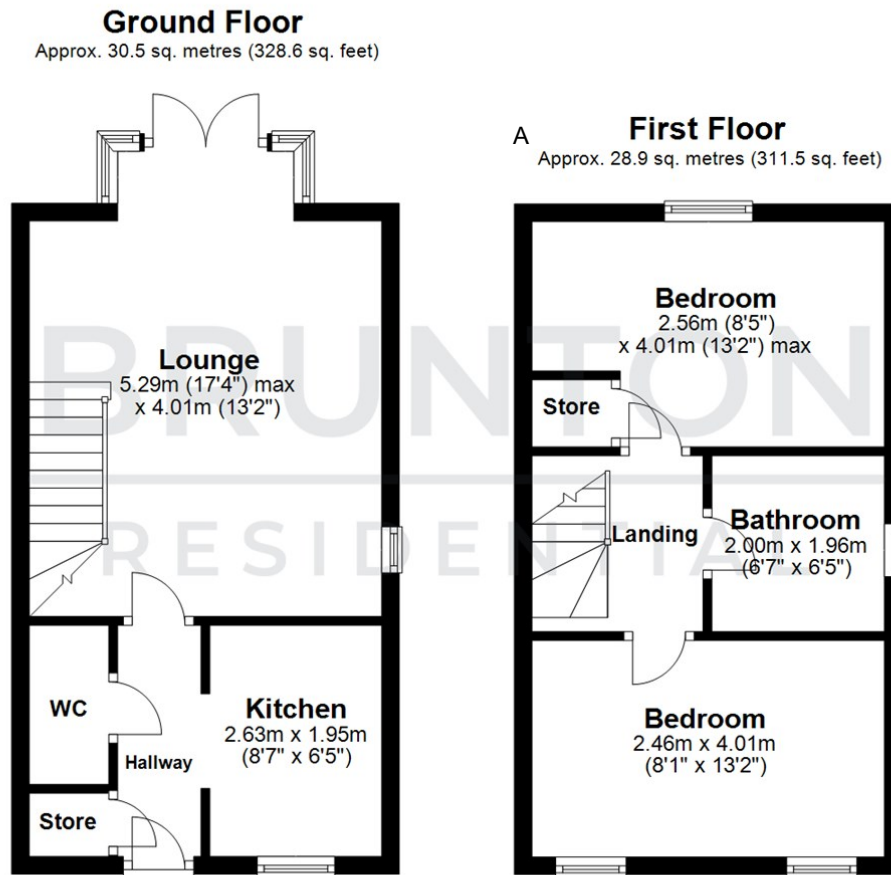

Total area: approx. 59.5 sq. metres (640.1 sq. feet)

All measurements are approximate and are for illustration only.
Plan produced using PlanUp.



Energy Efficiency Rating	
	Potential
Very energy efficient - lower running costs	
(92 plus) A	89
(81-91) B	
(69-80) C	75
(55-68) D	
(39-54) E	
(21-38) F	
(1-20) G	
Not energy efficient - higher running costs	
EU Directive 2002/91/EC	

Environmental Impact (CO ₂) Rating	
	Potential
Very environmentally friendly - lower CO ₂ emissions	
(92 plus) A	
(81-91) B	
(69-80) C	
(55-68) D	
(39-54) E	
(21-38) F	
(1-20) G	
Not environmentally friendly - higher CO ₂ emissions	
EU Directive 2002/91/EC	