

BRUNTON

RESIDENTIAL



MONTAGU COURT, GOSFORTH, NE3

Offers Over £600,000

BRUNTON

RESIDENTIAL





BRUNTON
RESIDENTIAL



BRUNTON

RESIDENTIAL



FANTASTIC APARTMENT - SOUGHT AFTER LOCATION - THREE BEDROOM

Brunton Residential are delighted to bring to market this outstanding apartment located in the popular area of Montagu Court. This excellent three bedroom property offers elegance and Sophistication with its quirky interior. Located close to local amenities, shops, schools and restaurants.

BRUNTON

RESIDENTIAL



BRUNTON

RESIDENTIAL



BRUNTON

RESIDENTIAL

TENURE : Leasehold

LOCAL AUTHORITY :

COUNCIL TAX BAND : G

EPC RATING :

SERVICES :

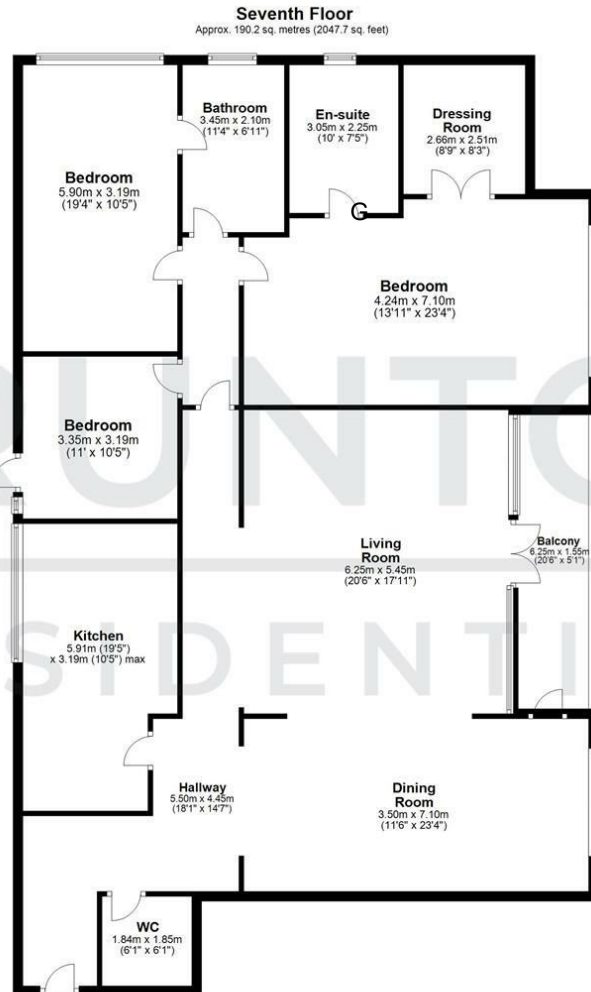

Total area: approx. 190.2 sq. metres (2047.7 sq. feet)

All measurements are approximate and are for illustration only.
Plan produced using PlanUp.



Energy Efficiency Rating		Current	Potential
Very energy efficient - lower running costs			
(92 plus) A			
(81-91) B			
(69-80) C			
(55-68) D			
(39-54) E			
(21-38) F			
(1-20) G			
Not energy efficient - higher running costs			
England & Wales	EU Directive 2002/91/EC		

Environmental Impact (CO ₂) Rating		Current	Potential
Very environmentally friendly - lower CO ₂ emissions			
(92 plus) A			
(81-91) B			
(69-80) C			
(55-68) D			
(39-54) E			
(21-38) F			
(1-20) G			
Not environmentally friendly - higher CO ₂ emissions			
England & Wales	EU Directive 2002/91/EC		