

T. 01912368347
E. info@bruntonresidential.com
A. Brunton Residential Middleton
W. South, Wagonway Drive, NE13
9RT



Orangetip Gardens

Great Park, NE13 9EG

FOUR BEDROOM - DETACHED - SOUGHT AFTER LOCATION

Brunton Residential are delighted to bring to the market this gorgeous four bedroom family home located in Great Park. This Neen/Polwarth style home is well presented across three floors and offers a detached garage to the rear of the property. This popular location offers excellent access to the A1 and other local amenities.

Offers Over £300,000

8 Orangetip Gardens

Great Park, NE13 9EG



Accommodation briefly comprises: entrance hall with staircase to first floor, a bright lounge to the front allowing natural light from the front window and a full width kitchen dining space with French doors leading to the rear garden, the kitchen area has a range of wall and base units with coordinated work surfaces, there is also a ground floor utility room and separate WC which is accessed from the hallway.

The first floor accommodation offers the first of two bedrooms which could be used as a master room, it offers plenty of space for wardrobes and has access to the first ensuite shower room, this room also features a stunning Juliette style balcony, there are two further bedrooms and a family bathroom WC. The second floor offers a potential for another master bedroom allowing space for bed/wardrobes and other bedroom furniture. This room also offers a dorma style window along with the second ensuite shower room.

Externally there is a lawned garden to the rear with paved areas and walled boundaries, a pathway provides access to a double driveway which offers off street parking and a detached garage. The front garden is also laid to lawn with pathway access to the front door.

ON THE GROUND FLOOR

Hall

Lounge

13'1" x 13'1" (4.00m x 4.00m)

WC

Kitchen/Diner

9'5" x 18'4" (2.88m x 5.59m)

Utility

5'8" x 5'10" (1.72m x 1.77m)

Bedroom

11'1" x 12'1" (3.38m x 3.68m)

En-suite

6'3" x 5'3" (1.90m x 1.60m)

Bedroom

9'7" x 8'4" (2.91m x 2.53m)

Bedroom

9'7" x 9'8" (2.91m x 2.94m)

Bathroom

7'1" x 5'9" (2.16m x 1.75m)

Stairs

Bedroom

14'0" x 11'1" (4.26m x 3.38m)

En-suite

5'0" x 6'8" (1.53m x 2.03m)

Disclaimer

ON THE FIRST FLOOR

ON THE SECOND FLOOR



- FOUR BEDROOM
- 360 VIRTUAL TOUR
- EN-SUITE
- DETACHED
- GREAT PARK
- GARAGE
- SOUGHT AFTER LOCATION



Floor Plan

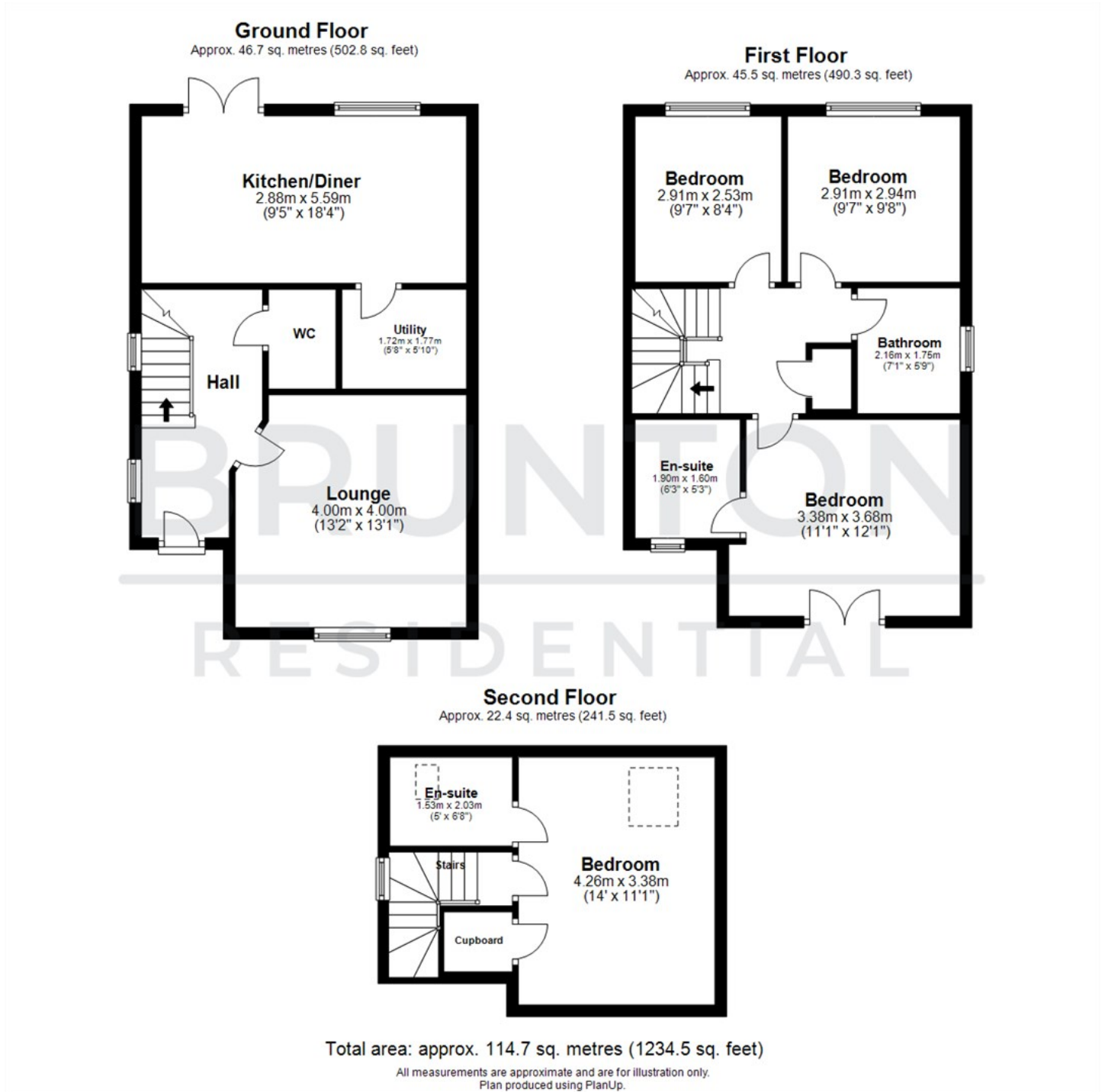

These particulars, whilst believed to be accurate are set out as a general outline only for guidance and do not constitute any part of an offer or contract. Intending purchasers should not rely on them as statements of representation of fact, but must satisfy themselves by inspection or otherwise as to their accuracy. No person in this firm's employment has the authority to make or give any representation or warranty in respect of the property.

