

BRUNTON

RESIDENTIAL

T. 01912368347
E. info@bruntonresidential.com
A. Brunton Residential Middleton
W. South, Wagonway Drive, NE13 9BJ



Abingdon Court

Kingston Park, NE3 2YQ

SEMI-DETACHED HOME - CUL-DE-SAC LOCATION - GARAGE & DRIVEWAY

Brunton Residential are delighted to offer this semi-detached home located on Abingdon Court in Kingston Park. This property is in a great cul-de-sac location with fantastic garden space. Kingston Park is a highly popular area, well known for its vast shopping facilities, excellent schooling and excellent commuting links.

Offers Over £225,000

22 Abingdon Court

Kingston Park, NE3 2YQ



Brunton Residential are delighted to offer this semi-detached home located on Abingdon Court in Kingston Park. This property is in a great cul-de-sac location with fantastic garden space. Kingston Park is a highly popular area, well known for its vast shopping facilities, excellent schooling and excellent commuting links. The accommodation briefly comprises: Entrance porch leading to the hallway then in to a spacious lounge with a window to the front. This leads to an open plan dining area with patio door access to the rear garden. The large modern kitchen is fitted with a range of wall and floor units with coordinated work surfaces, access to a utility area, WC and integral garage. The rear garden can be accessed through the kitchen and side gate.

The first floor has a landing area with doors to the master bedroom, a second double bedroom overlooking the rear garden, a third bedroom which is currently being used a nursery. Finally, a family bathroom with bath and integrated shower

Externally there is a garden to the rear with a patio, artificial lawn and fenced boundaries. To the front there is a driveway providing off-street parking for two cars and garage access.

ON THE GROUND FLOOR

Porch

Hallway

Dining Room

10'8" x 8'8" (3.26m x 2.64m)

Lounge

15'3" x 11'10" (4.65m x 3.60m)

Dining Room

10'8" x 8'8" (3.26m x 2.64m)

Kitchen

10'8" x 18'10" (3.26m x 5.73m)

Utility

WC

Utility

Landing

Bedroom

9'1" x 7'10" (2.77m x 2.40m)

Garage

ON THE FIRST FLOOR

Landing

Bedroom

9'1" x 7'10" (2.77m x 2.40m)

Bedroom

10'10" x 10'2" (3.29m x 3.11m)

Bedroom

10'8" x 6'7" (3.25m x 2.00m)

Bathroom

Disclaimer

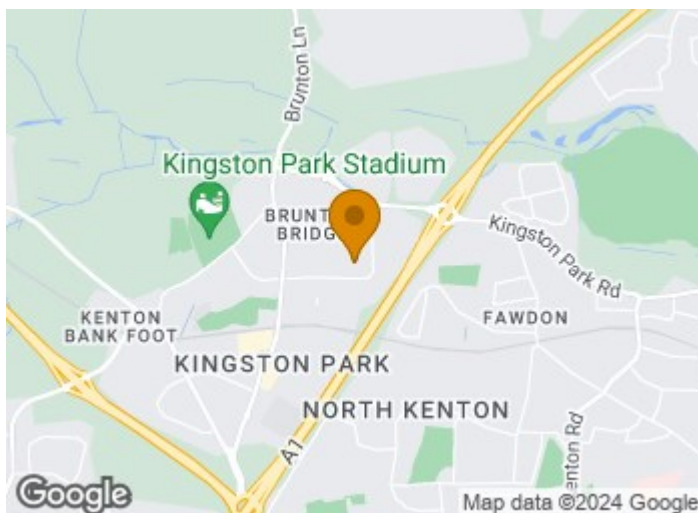

- SEMI DETACHED HOME
- FRONT AND REAR GARDENS
- THREE BEDROOMS
- PERFECT FAMILY HOME
- CUL DE SAC LOCATION
- FREEHOLD



Floor Plan

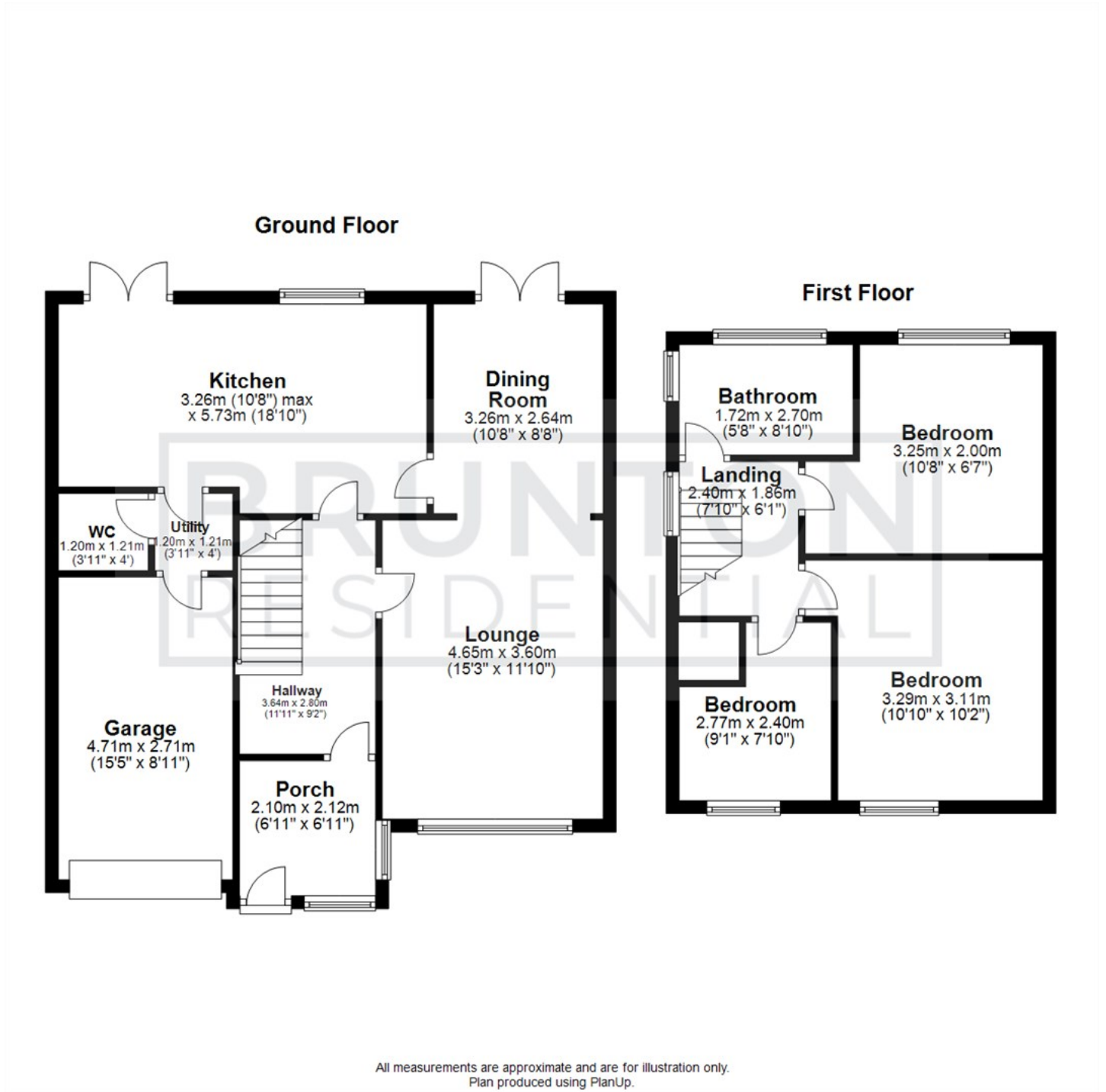

These particulars, whilst believed to be accurate are set out as a general outline only for guidance and do not constitute any part of an offer or contract. Intending purchasers should not rely on them as statements of representation of fact, but must satisfy themselves by inspection or otherwise as to their accuracy. No person in this firm's employment has the authority to make or give any representation or warranty in respect of the property.

