

T. 01912368347  
E. info@bruntonresidential.com  
A. Brunton Residential Middleton  
W. South, Wagonway Drive, NE13  
9RT



## High Street

### Gosforth Newcastle Upon Tyne, NE3 1HH

RETIREMENT PROPERTY - GREAT LOCATION - FULLY REFERBISHED

Brunton Residential are delighted to offer for sale this one bedroom property in the well located Homedowne House development on Gosforth High Street. This apartment is on a high floor located close to the lift and has been stylishly refurbished throughout.

**Offers Over £55,000**

# 37 High Street

Gosforth Newcastle Upon Tyne, NE3 1HH



Brunton Residential are delighted to offer for sale this one bedroom property in the well located Homedowne House development on Gosforth High Street. This apartment is on a high floor located close to the lift and has been stylishly refurbished throughout.

Homedowne House is a warden assisted site designed for downsizers of at 55 years of age, it has a range of communal facilities. We offer this property without forward chain and offers accommodation briefly comprising: communal entrance hallway with lift to all floors, the property offers a private internal hall, a large lounge with windows to rear and an open plan style kitchen area which has been recently replaced, there is a range of wall and floor units with some fitted appliances. There is a master bedroom and a stylish shower room WC. Externally there are some communal garden areas and a residents parking facility.

## TO THE APARTMENT

Disclaimer.

### Hall

### Living Room

15'5" x 11'2" (4.70m x 3.40m)

### Kitchen

5'5" x 7'3" (1.65m x 2.20m)

### Bedroom

14'3" x 8'8" (4.35m x 2.65m)

### Shower Room

6'7" x 5'1" (2.00m x 1.55m)

### Cupboard

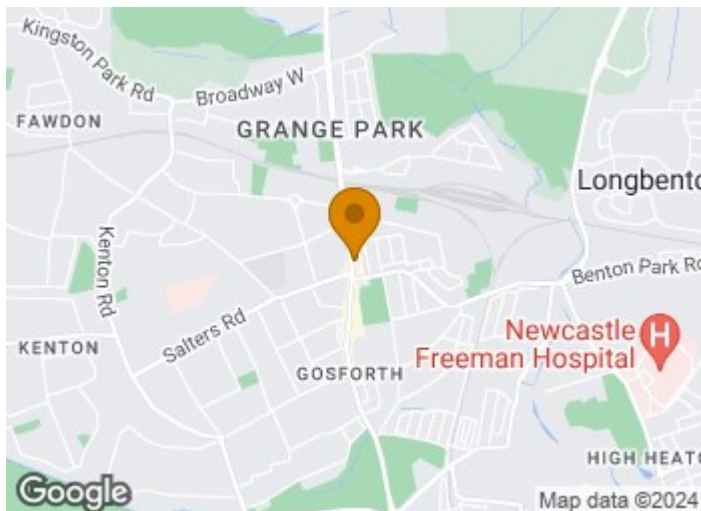

- RETIREMENT PROPERTY
- ONE BEDROOM
- ALLOCATED PARKING
- FULLY REFERBISHED
- GREAT LOCATION



## Floor Plan

### Third Floor

Approx. 35.6 sq. metres (383.7 sq. feet)

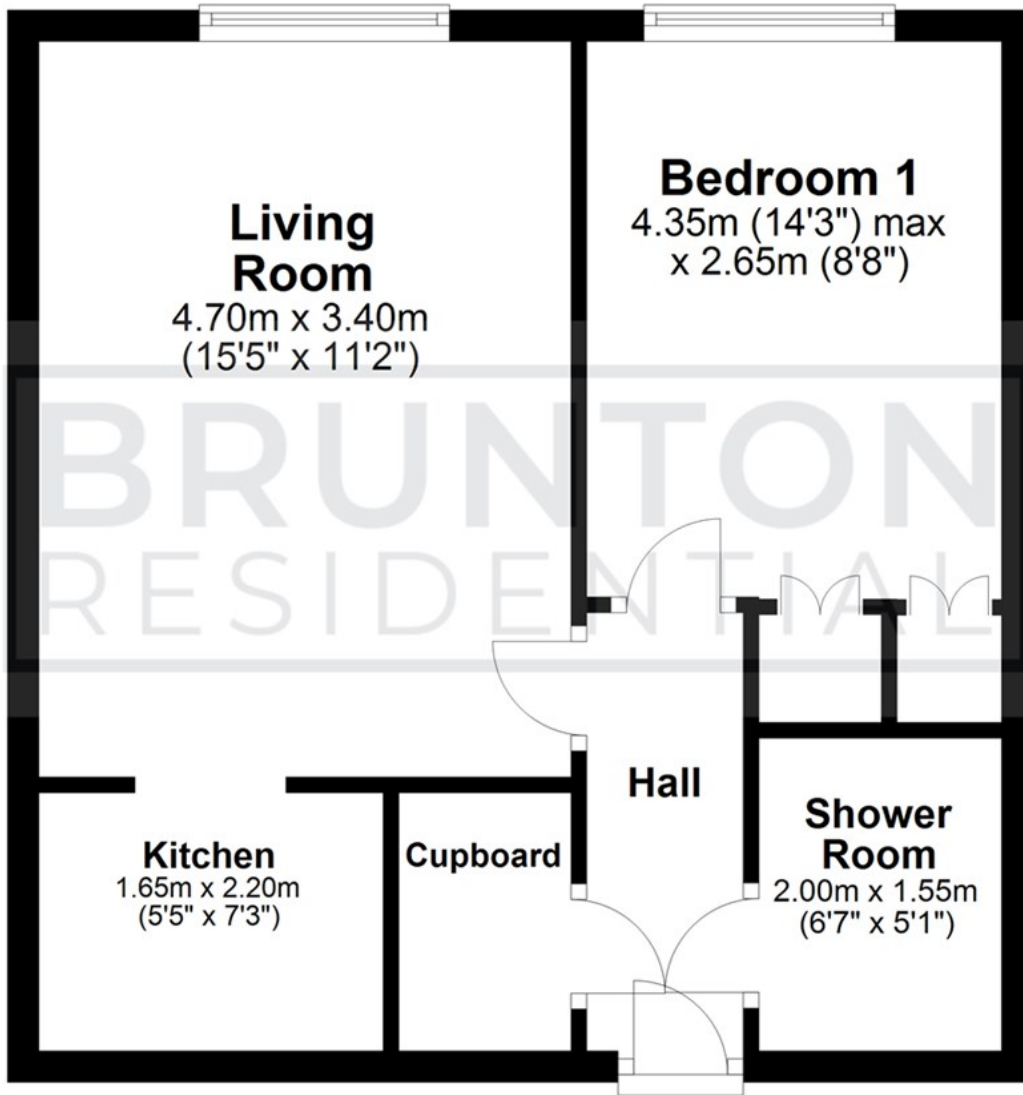

All measurements are approximate and are for illustration only.  
Plan produced using PlanUp.

These particulars, whilst believed to be accurate are set out as a general outline only for guidance and do not constitute any part of an offer or contract. Intending purchasers should not rely on them as statements of representation of fact, but must satisfy themselves by inspection or otherwise as to their accuracy. No person in this firm's employment has the authority to make or give any representation or warranty in respect of the property.

