

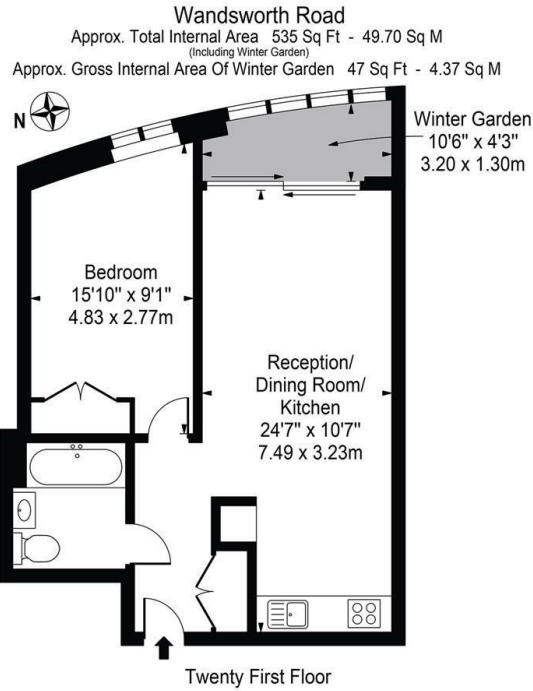

Sky Gardens, Wandsworth Road, London SW8

Asking Price £625,000

- One Bedroom / One Bathroom
- Comfort Cooling
- Lift
- Great location moments from Vauxhall and Nine Elms station
- Winter Garden
- Underfloor Heating
- Gym & Bicycle Storage
- Amazing Views from both Bedroom and Reception
- 24hr Concierge
- Roof Terrace & Communal Gardens



For Illustration Purposes Only - Not To Scale
 This floor plan should be used as a general outline for guidance only and does not constitute in whole or in part an offer or contract.
 Any intending purchaser or lessee should satisfy themselves by inspection, searches, enquiries and full survey as to the correctness of each statement.
 Any areas, measurements or distances quoted are approximate and should not be used to value a property or be the basis of any sale or let.

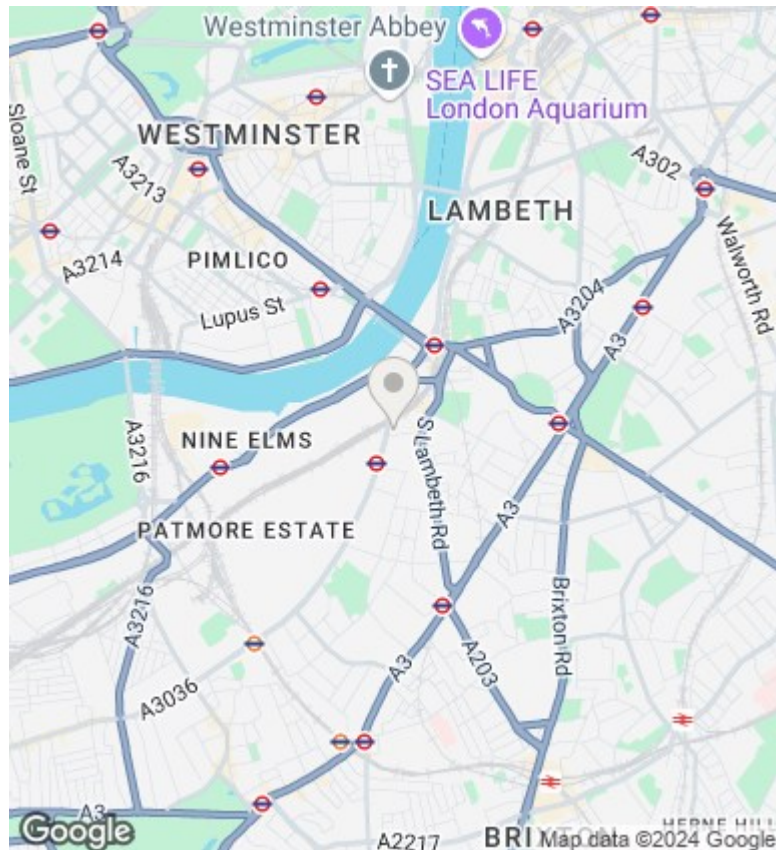

Directions

Viewings

Viewings by arrangement only. Call 02070990800 to make an appointment.

Council Tax Band

E

EPC Rating:

B

| Energy Efficiency Rating | | Current | Potential |
|--|--|-------------------------|-----------|
| <i>Very energy efficient - lower running costs</i> | | | |
| (92 plus) A | | | |
| (81-91) B | | 84 | 84 |
| (69-80) C | | | |
| (55-68) D | | | |
| (39-54) E | | | |
| (21-38) F | | | |
| (1-20) G | | | |
| <i>Not energy efficient - higher running costs</i> | | | |
| England & Wales | | EU Directive 2002/91/EC | |