

## 25, 12 Knightsbridge Court, Sloane Street, London, SW1X 9LQ

Asking Price £3,500,000

- Penthouse Apartment
- 1 Guest toilet
- Lift
- Leasehold 979 years
- 3 Bedroom
- Refurbished
- Porter
- 3 Ensuite
- Air conditioning
- Spectacular views over London

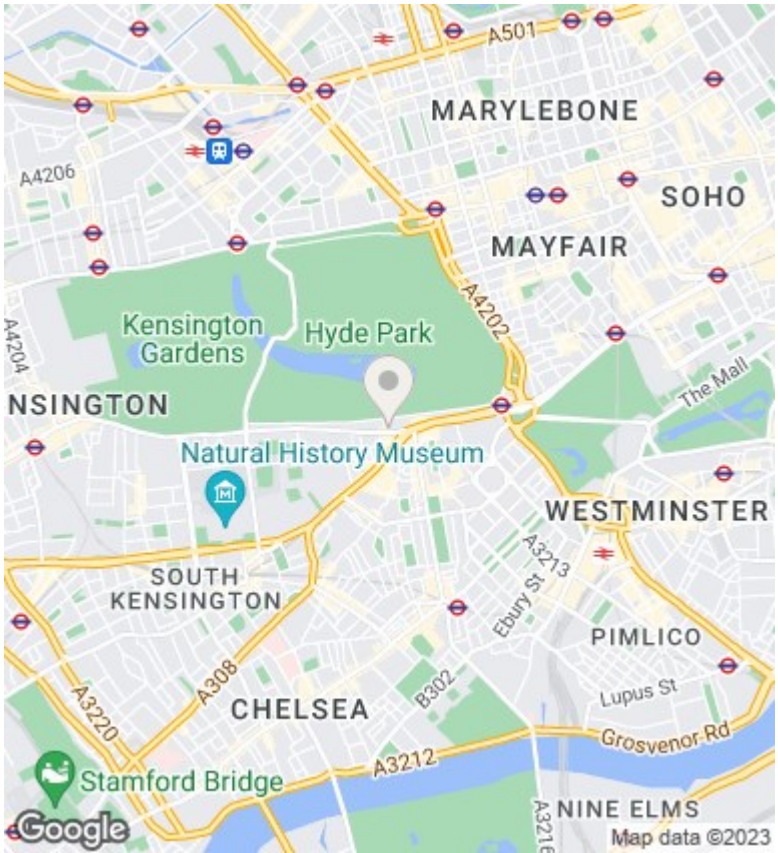
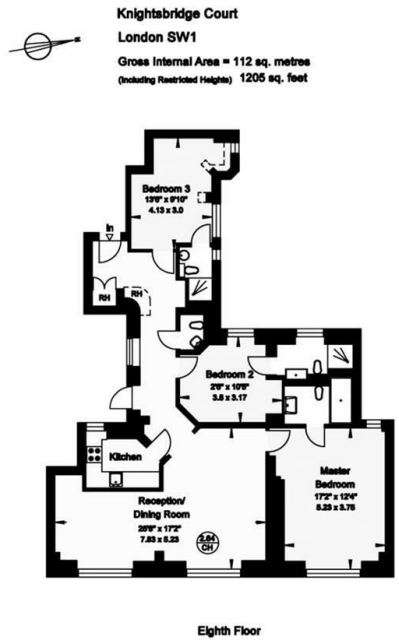

**Directions**

**Viewings**

Viewings by arrangement only. Call 02070990800 to make an appointment.

**Council Tax Band**

G

**EPC Rating:**

Energy Efficiency Rating		
	Current	Potential
<i>Very energy efficient - lower running costs</i>		
(92 plus) <b>A</b>		
(81-91) <b>B</b>		
(69-80) <b>C</b>		
(55-68) <b>D</b>		
(39-54) <b>E</b>		
(21-38) <b>F</b>		
(1-20) <b>G</b>		
<i>Not energy efficient - higher running costs</i>		
<b>England &amp; Wales</b>	EU Directive 2002/91/EC	