



3 Bedroom  
Harlesden Road, NW10

 **Portland**  
Trusted, every step of the way

£575,000  
Leasehold – Share of Freehold



Spanning over 1000sqft is an exceptional three bedroom apartment with private garden

Positioned on the first and top floor of a semi-detached Victorian conversion, this property is flooded with natural light and gorgeous features. To the front is a wonderful dining living area with bay window. There are two large double rooms with an eat in kitchen and family bathroom all on this floor. Upstairs, a further bedroom has been created with an abundance of eaves storage. Rarely available, this first floor apartment comes with a private section of garden too.

Buyers will benefit with this property being sold with a share of the freehold and also vacant possession.

This pocket of Harlesden Road offers residents parking permits and is also a short walk to the rolling green space of Roundwood Park. Dollis Hill on the Jubilee Line is also within walking distance along with the eateries on College Road.

- Private garden
- Large bay fronted reception room
- Share of freehold
- Over 1000 square foot of accommodation
- Roundwood park a short stroll away
- Incredible condition
- Large separate eat-in kitchen
- EPC Band D
- Vacant possession
- High ceilings









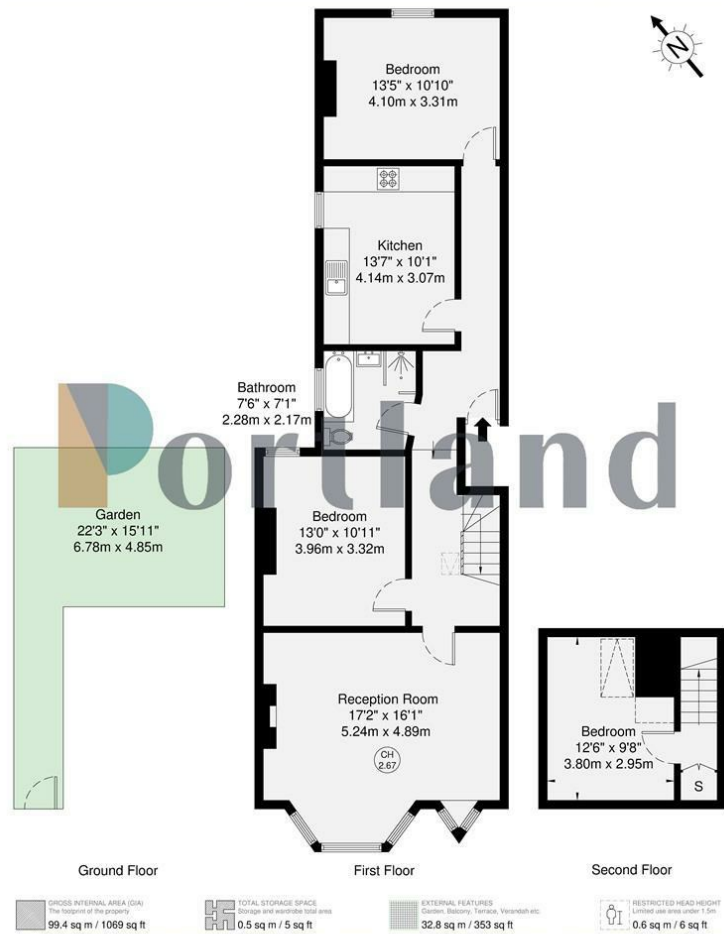

Disclaimer: Floorplan measurements are approximate and are for illustrative purposes only. While we do not doubt the floorplan accuracy and completeness, you or your advisors should conduct a careful, independent investigation of the property in respect of monetary valuation.



Trusted, every step of the way

90 Walm Lane, London, NW2 4QY  
020 8451 9844  
info@portlandestateagents.co.uk  
www.portlandestateagents.co.uk

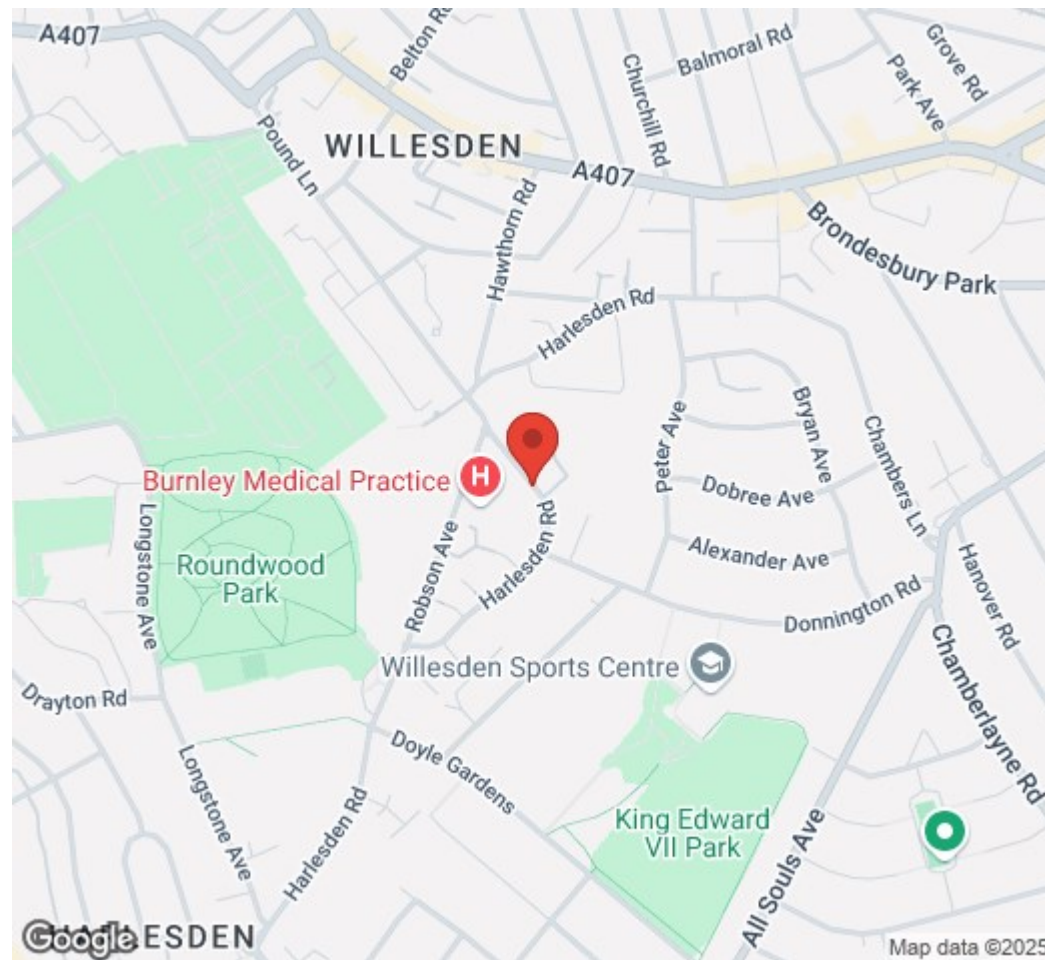

Energy Efficiency Rating		Current	Potential
Very energy efficient - lower running costs			
(92 plus) A			
(81-91) B			
(69-80) C			
(55-68) D			
(39-54) E			
(21-38) F			
(1-20) G			
Not energy efficient - higher running costs			
England & Wales		EU Directive 2002/91/EC	

Environmental Impact (CO <sub>2</sub> ) Rating		Current	Potential
Very environmentally friendly - lower CO <sub>2</sub> emissions			
(92 plus) A			
(81-91) B			
(69-80) C			
(55-68) D			
(39-54) E			
(21-38) F			
(1-20) G			
Not environmentally friendly - higher CO <sub>2</sub> emissions			
England & Wales		EU Directive 2002/91/EC	