



1 Bedroom
Griffin Close, NW10

 **Portland**
Trusted, every step of the way

£300,000
Leasehold

A rarely available one bedroom apartment with access to a private garden.

Positioned perfect for commuters is a wonderful apartment in Rowan House. On the ground floor, buyers will find a charming front room, a well equipped kitchen with access to outside space, a large double bedroom and a separate shower and w/c.

With off street parking becoming a much more sought after, along with it's proximity to the Jubilee Line, this will be perfect for First Time Buyers and Investors alike.

this property is offered chain free and with a brand new lease. The bubbling High Road and it's amenities are a short walk away and the ever popular rolling green space of Gladstone Park are just down the road. The nearest Station is Willesden Green with excellent access to the West End, Canary Wharf and Stratford.

- Close To Station
- One Bedroom Apartment
- Chain Free
- Long Lease
- Off Street Parking
- Private Garden
- Perfect For First Time Buyers
- Close To Gladstone Park
- Tucked Away Location
- Separate Kitchen





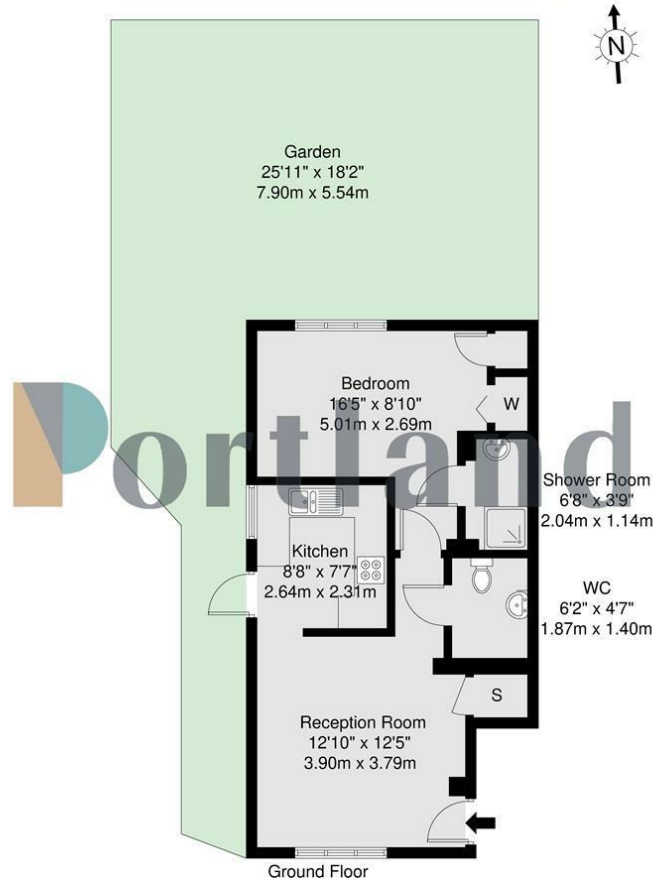

GROSS INTERNAL AREA (GIA)
The footprint of the property
44.9 sq m / 483 sq ft

TOTAL STORAGE SPACE
Storage and available total area
1.3 sq m / 13 sq ft

EXTERNAL FEATURES
Garden, Balcony, Terrace, Verandah etc.
43.8 sq m / 471 sq ft

RESTRICTED HEAD HEIGHT
Limited use area under 1.5m
0.0 sq m / 0.0 sq ft

Disclaimer: Floorplan measurements are approximate and are for illustrative purposes only. While we do not doubt the floorplan accuracy and completeness, you or your advisors should conduct a careful, independent investigation of the property in respect of monetary valuation.



90 Walm Lane, London, NW2 4QY
020 8451 9844
info@portlandestateagents.co.uk
www.portlandestateagents.co.uk

