



2 Bedroom
Anson Road, NW2

 **Portland**
Trusted, every step of the way

£550,000
Leasehold

Boasting beautiful original features, is a wonderful Ground Floor Garden Flat in a Victorian Conversion.

Anson Road is a wonderful two bedroom apartment with incredible ceiling height, gorgeous original features such as fireplaces, ceiling roses and cornicing. Buyers can expect to find a bright reception room at the front with bay window and wooden flooring. There is a large double bedroom with doors onto the private garden and access to the family bathroom. A single bedroom is positioned further back and the kitchen with access to the garden to the rear.

This property is being sold chain free and with vacant possession.

Anson Road is a popular treelined streets moments from Cricklewood, Willesden Green and Kilburn Stations. This property is positioned in the residential Victorian end and benefits great access to Gladstone Park & The Mapesbury Dell

- Charming Two Bedroom Garden Flat
- Stunning Original Features Found Throughout
- Bright Reception Room With Bay Window
- Large Private Garden
- Separate Kitchen
- Large Double Bedroom
- High Ceilings
- Intricate Cornicing & Ceiling Rose
- Close To Stations Allowing Great Access To Central London & The West End
- Gladstone Park & Mapesbury Dell A Short Stroll Away



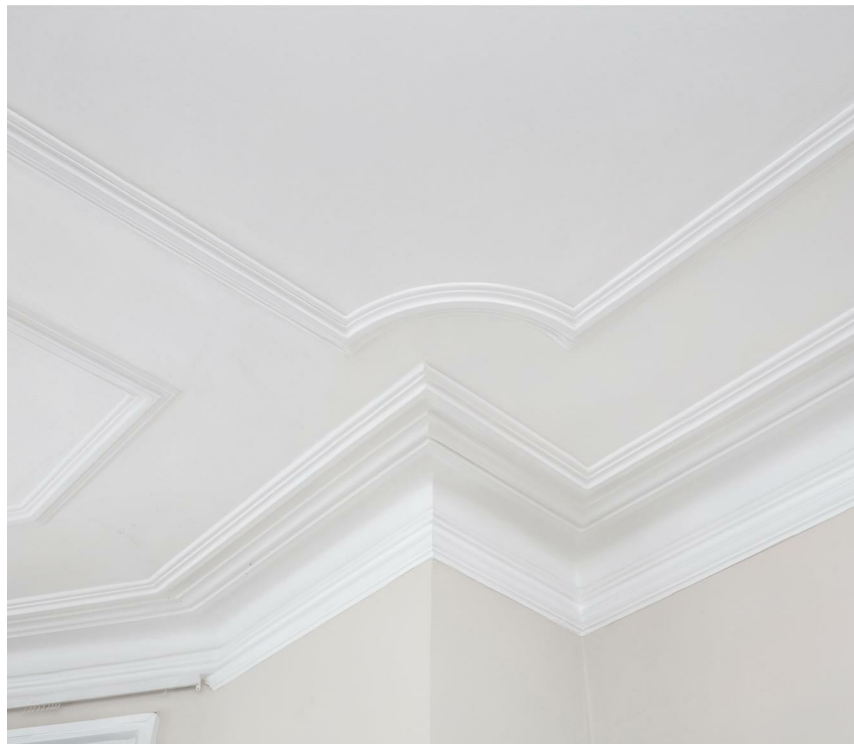

Portland

Anson Road, NW2

GROSS INTERNAL AREA
67.6 sq m / 727 sq ft

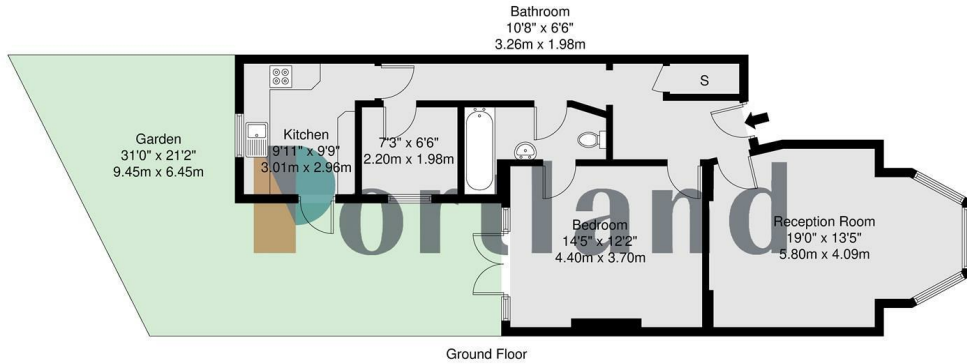

- GROSS INTERNAL AREA (GIA)
The footprint of the property
67.6 sq m / 727 sq ft
- TOTAL STORAGE SPACE
Storage and wasteable total area
1.1 sq m / 11 sq ft
- EXTERNAL STRUCTURAL FEATURES
Garden, Balcony, Terrace, Verandah etc.
69.1 sq m / 743 sq ft
- RESTRICTED HEAD HEIGHT
Limited use area under 1.5m
0.0sq m / 0.0 sq ft

Disclaimer : Floorplan measurements are approximate and are for illustrative purposes only. While we do not doubt the floorplan accuracy and completeness, you or your advisors should conduct a careful, independent investigation of the property in respect of monetary valuation.



Portland

Trusted, every step of the way

90 Walm Lane, London, NW2 4QY
020 8451 9844

info@portlandestateagents.co.uk
www.portlandestateagents.co.uk

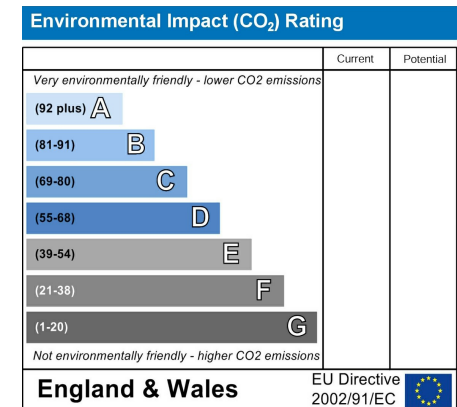
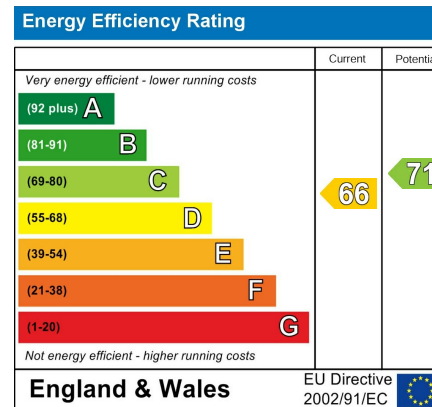

Important Notice - These particulars have been prepared in good faith and they are not intended to constitute part of an offer or contract. We have not performed a structural survey on this property and the services, appliances and specific fittings have not been tested. All photographs, measurements, floor plans and distances referred to are given as a guide and should not be relied upon.