



2 Bedroom
Chandos Road, NW2

 **Portland**
Trusted, every step of the way

£500,000
Share of Freehold

Spanning over 800sqft of lateral Accommodation, Portland Estate Agents are pleased to offer an exceptional two bedroom first floor flat.

Flooded with natural light, is an exceptional purpose built Victorian flat with amazing space. Buyers can expect to find a separate kitchen, two large double bedrooms and family bathroom. Prospective purchasers will be most impressed with the incredible living room which spans over 6 meters! The property is offered to the market chain free and in exceptional condition.

Chandos Road is a popular residential tree lined street moments from the jubilee line. Positioned in a Victorian Detached building allows for larger and more lateral accommodation compared to neighboring terraced homes. The property is a short walk from the rolling green space of Gladstone Park, Willesden Green Underground Station (Jubilee Zone 2/3) and the bustling high street of Walm Lane.

- Share Of Freehold
- Lateral Accommodation
- Two Double Bedrooms
- Shops Nearby
- Over 800sqft
- Close To Willesden Green Station
- Bright First Floor Flat
- Amazing Condition
- Chain Free
- Popular Residential Road





Chandos House NW2

GROSS INTERNAL AREA
76.3 sq m / 821 sq ft

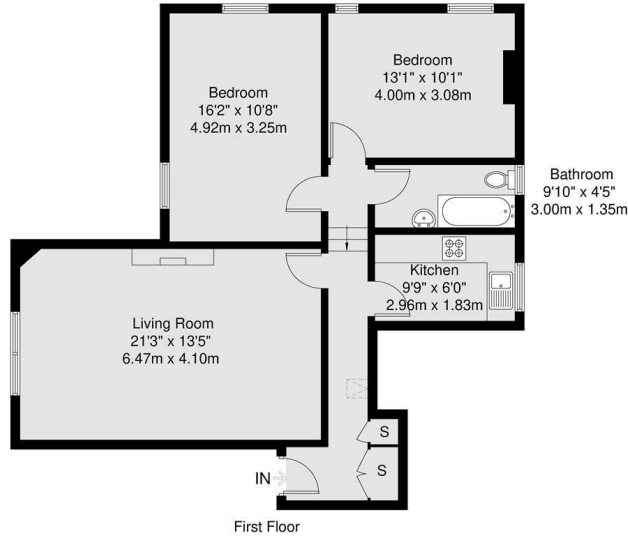

GROSS INTERNAL AREA (GIA)
The balance of the property
76.3 sq m / 821 sq ft

TOTAL STORAGE SPACE
Storage and wardrobe total area
1.1 sq m / 12 sq ft

EXTERNAL STRUCTURAL FEATURES
Curtain, Skirting, Terrace, Verandah, etc.
0.0 sq m / 0.0 sq ft

RESTRICTED HEAD HEIGHT
Limited use areas under 2.0m
0.0 sq m / 0.0 sq ft

Disclaimer : Floorplan measurements are approximate and are for illustrative purposes only. While we do not doubt the floorplan accuracy and completeness, you or your advisors should conduct a careful, independent investigation of the property in respect of monetary valuation.

Maison
VUE

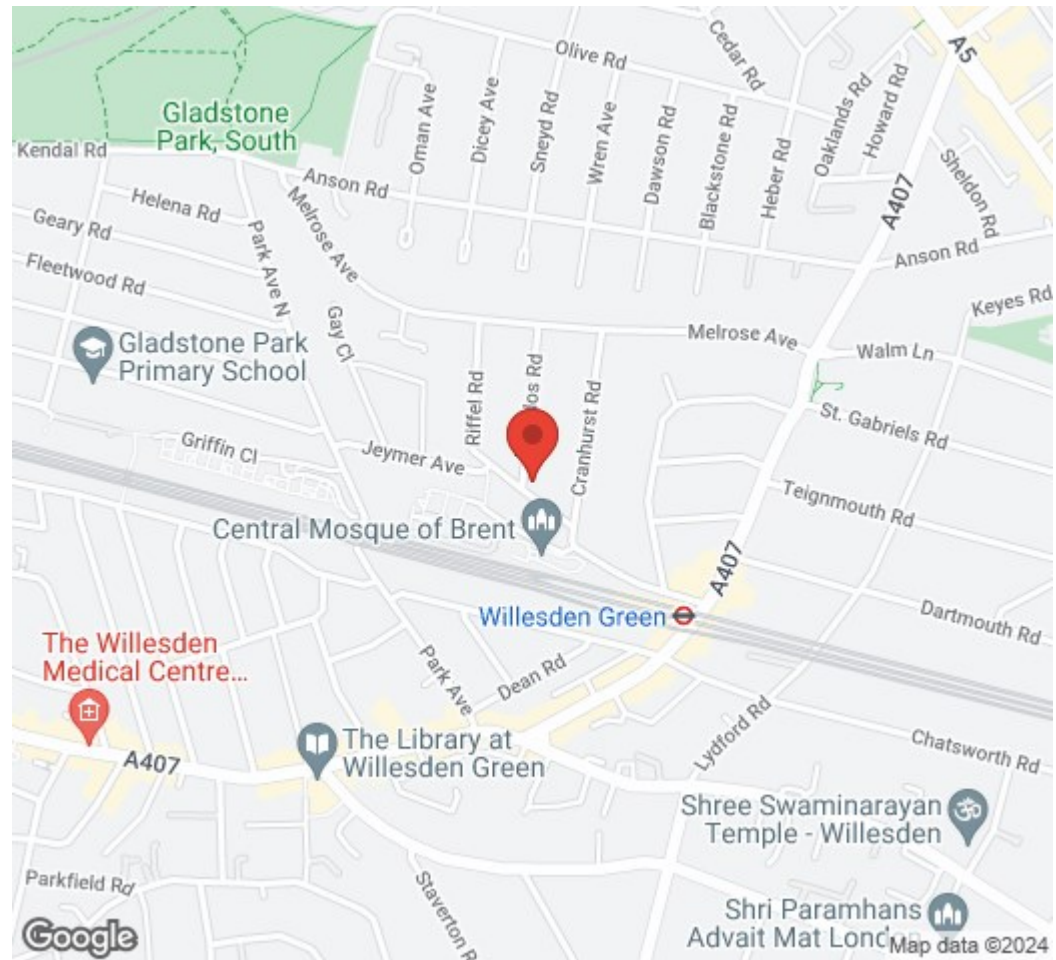

Trusted, every step of the way

90 Walm Lane, London, NW2 4QY
020 8451 9844

info@portlandestateagents.co.uk

www.portlandestateagents.co.uk

