

Blore House, Kings Chelsea, SW10

**JOWEBSTER**





## Blöre House, Kings Chelsea, SW10

We are pleased to present this exceptional two-bedroom apartment within the renowned Kings Chelsea development, offering a sophisticated and secure living experience. Residents enjoy a host of exclusive amenities, including a large swimming pool, a fully equipped gym, a tennis court, and beautifully landscaped gardens. The development is gated, with 24-hour security ensuring peace of mind at all times. Secure car parking is also provided.

This elegant apartment spans 939 sq ft (87.24 sq m) and features an open-plan living and kitchen area, creating a spacious and contemporary living environment. The master bedroom benefits from an en-suite bathroom, while the second bedroom is served by a separate family bathroom, ensuring privacy and convenience for all residents.

Kings Chelsea is perfectly situated between the prestigious Fulham Road and King's Road in Chelsea, placing an array of high-end shops, dining options, and transport links, including rail, bus, and river boat services, all within easy walking distance. This is an exceptional opportunity to reside in one of Chelsea's most sought-after addresses.



### Property Attributes

- Reception Room
- Kitchen
- Master Bedroom with En-Suite
- Second Bedroom
- Family Bathroom
- Residents Gym and Swimming Pool
- Landscaped Gardens
- Car Parking

### Terms

- £1,350,000
- Royal Borough of Kensington And Chelsea
- Share of Freehold
- Service charge approx. £9000 (2025)





# BLORE HOUSE, COLERIDGE GARDENS, SW10

Approximate gross internal area = 939 sq ft / 87.24 sq m

Key:  
CH - Ceiling Height

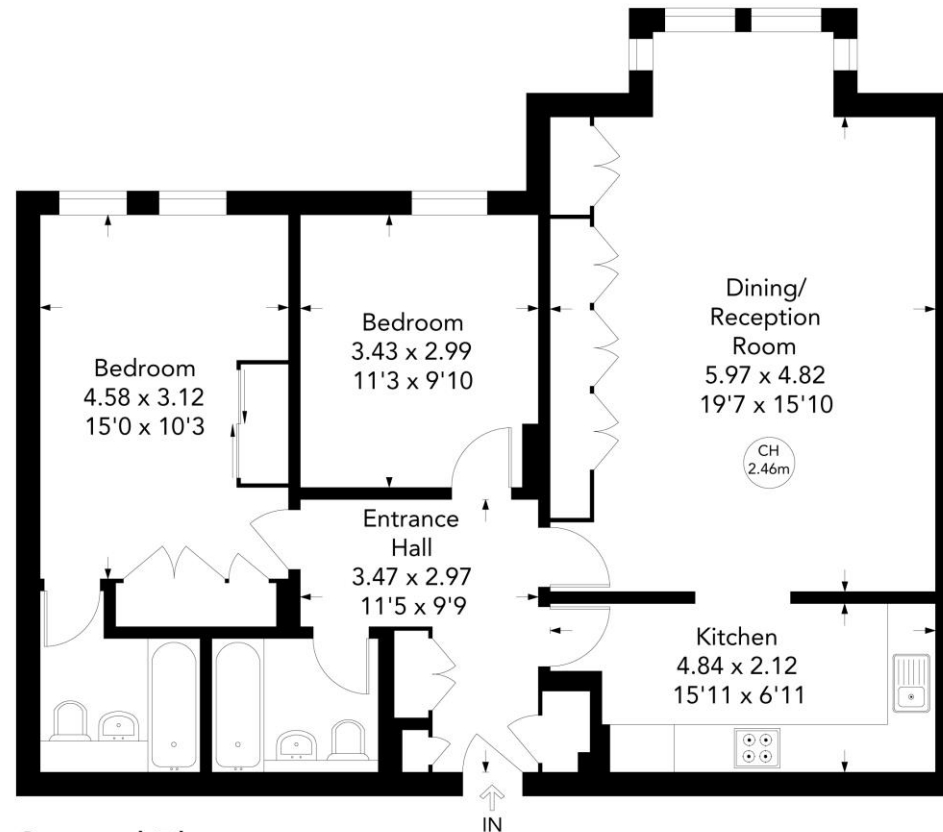

Second Floor

Not to scale, for guidance only and must not be relied upon as a statement of fact.  
All measurements and areas are approximate only

+44 (0)20 7349 7055  
sales@jowebster.com  
www.jowebster.com

**Important Notice**  
These sales particulars are believed to be correct, but their accuracy is not guaranteed, nor do they form any part of a contract. We have not carried out a detailed survey nor tested services, appliances or fittings.  
Purchasers must satisfy themselves by inspection or otherwise.