

E.S.&A. ROBINSON. LTD. COLOUR PRINTERS.

Bedminster - £350,000

2 bed flat

Norfolk Place, BS3 4AX



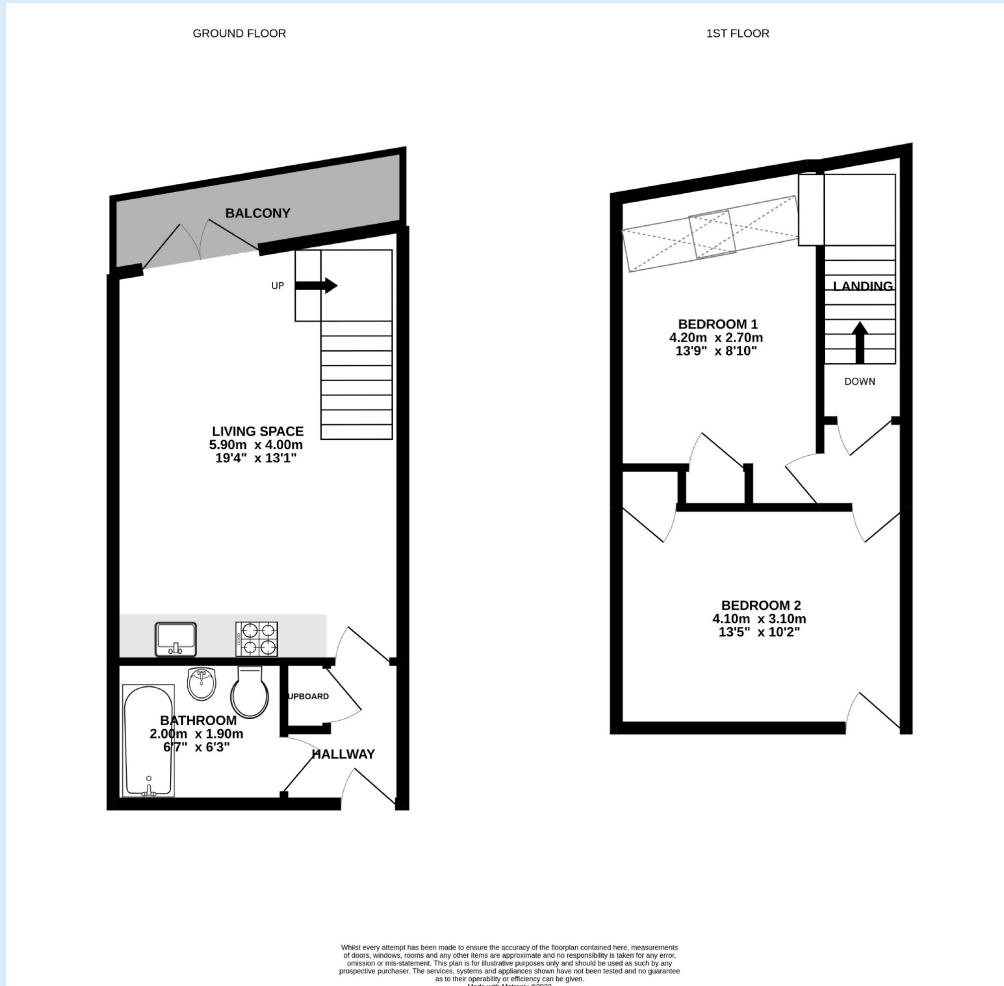

A 2 bedroom duplex apartment in the iconic Robinson Building just off East Street in Bedminster, boasting an open plan living space, two double bedrooms, a 3 piece bathroom and a parking space! This apartment is located on the 6th floor and flows upstairs onto the 7th floor of the building with breath-taking views across Bristol from the balcony and the upstairs velux windows. The balcony floods the living space with natural light, bringing the outside in. The kitchen is fitted with integrated white goods, and the building comes with bike and bin storage.

**Material Information (provided by the Owner) - Leasehold (987 years remaining)
Ground rent: £250. Annual service charge circa: £2400. Council Tax - B**



Southville Office

275 North Street, Southville, BRISTOL, BS3 1JN

Call: 0117 9231866

Mail: southvillesales@oceanhome.co.uk

Search: oceanhome.co.uk

References to the Tenure of a Property are based on information supplied by the Seller. The Agent has not had sight of the title documents. Lease details, service ground rent (where applicable) are given as a guide only and should be checked and confirmed by your solicitor prior to exchange of contracts.