



30 Wishford Road, Wilton, Salisbury, Wiltshire, SP2 0JQ

£229,950 Freehold

A wonderfully open plan chalet bungalow with terrific views over water meadows to the front.

Directions

From Salisbury take the A36 Wilton Road. At the roundabout turn left and proceed through Wilton. The road bears sharply left into Shaftesbury Road and turn immediately right into Waterditchampton. Proceed under the railway bridge and after a quarter of a mile No. 30 will be found on the left hand side.

Description

Mid terraced chalet bungalow set well back from the road with a large front garden, offering open plan living accommodation, kitchen, bathroom and two bedrooms upstairs. There is tremendous potential to alter and re-arrange both upstairs and downstairs and we would highly recommend an internal inspection to appreciate. The property has gas fired central heating by radiators and combination boiler, double glazed windows throughout, a useful alley/store area to the side and an enclosed rear garden. Parking could be made to the front subject to the necessary permissions. There are delightful views over water meadows to the front. Vacant possession is offered.

House Specifics

The accommodation is arranged as follows, all measurements being approximate:

Entrance porch

Wood flooring. Door to:

Hall

Open to both dining room and to sitting room.

Sitting room 12'11" x 9'11" (3.94m x 3.04m)

Window to front elevation, ornamental fireplace with spotlights above. Open to:

Sitting room/study area 9'6" x 8'7" (2.91m x 2.64m)

Patio doors to garden.

Dining room 13'11" x 8'5" (4.25m x 2.57m)

Stairs to first floor, window to front elevation.

Inner hall

Doors to bathroom and kitchen.

Bathroom

Fully tiled walls with suite of panelled bath, low level WC and wash-hand basin. Electric shower, tiled floor.

Kitchen 10'11" x 8'7" (3.35m x 2.64m)

Large larder cupboard housing Worcester combination boiler for central heating and hot water. Double storage cupboard. Range of work surfaces with inset one and a half bowl sink unit with mixer taps over, four ring electric hob with oven below and hood above. The washer/dryer and fridge/freezer are included in the sale. Door to storage area giving access to front and back gardens.

First floor

Bedroom one 20'4" x 11'10" (6.22m x 3.62m)

Two double built-in wardrobes with double cupboard between. Built-in bedroom furniture to include bedside tables, dressing table, chest of drawers/desk unit. Two Velux windows, door to eaves storage areas, storage recess.

Bedroom two 14'1" max x 9'1" max (4.31m max x 2.78m max)

L-shaped room with Velux window and door to loft storage area.

Outside

The front garden is primarily laid to lawn behind a low brick wall with path to front door. Flower beds and shrubs. The rear garden is laid to lawn with sitting area, garden shed and flower beds. Enclosed by timber fencing.

There are wonderful views to the front over water meadows.

Services

Mains gas, water, electricity and drainage are connected to the property.

Outgoings

The Council Tax Band is 'B' and the payment for the year 2018/2019 payable to Wiltshire Council is £1398.30.

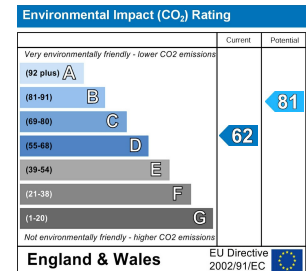
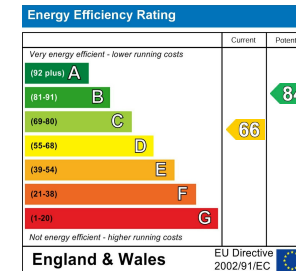
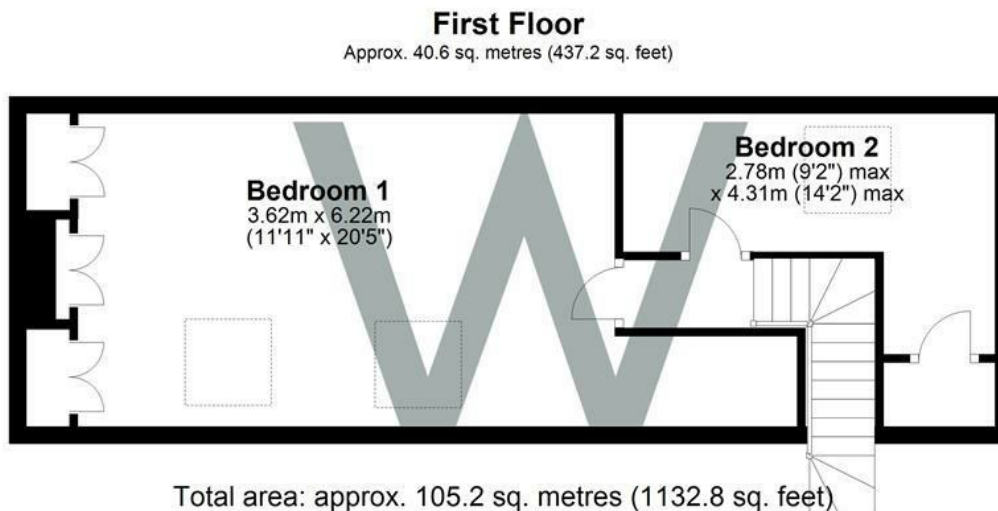
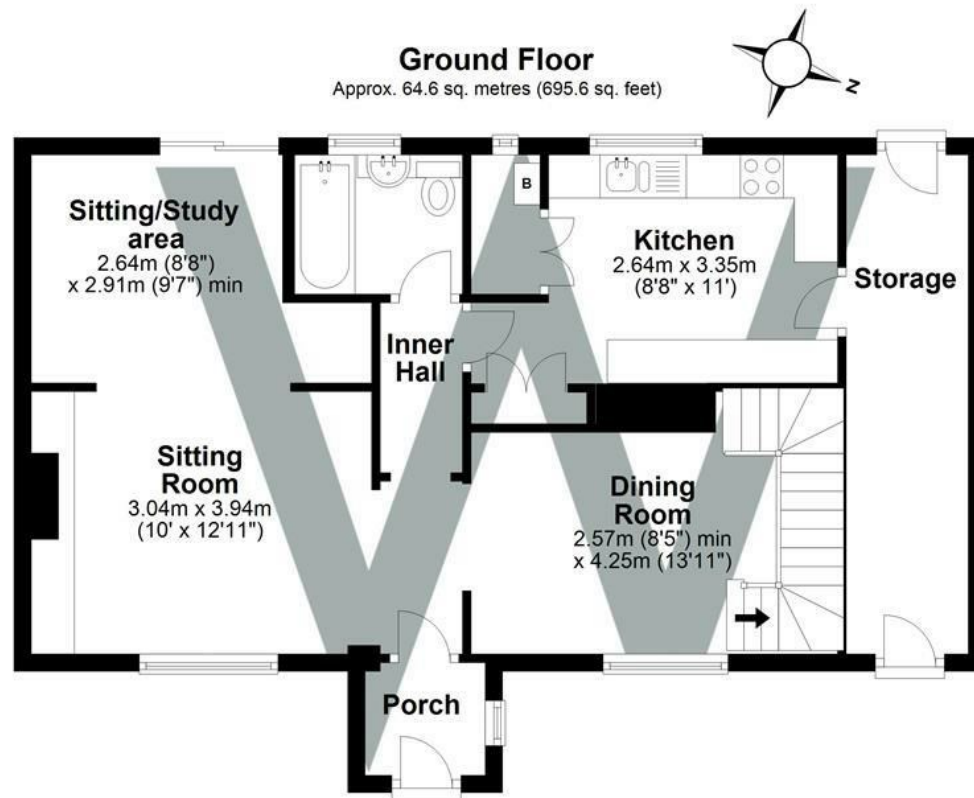

WHITES
Castle Chambers, 47 Castle Street,
Salisbury, Wiltshire, SP1 3SP
Tel: 01722 336422
www.hwwwwhite.co.uk
email: residential-sales@hwwwwhite.co.uk

