



11 Albany Terrace, Wilton, Salisbury, Wilts, SP2 0HF

£1,100 PCM

About the property

A characterful two-bedroom terraced house situated within walking distance of Wilton town centre, offering convenient access to local amenities and transport links. The property is unfurnished and will be available from the beginning of July.

The ground floor accommodation comprises a front lounge with a door leading through to the dining room, followed by a fitted kitchen which includes a fridge, gas cooker with hob, and space for a washing machine. A rear lobby with built-in larder cupboard leads to the ground floor bathroom, which is fitted with a bath and handheld shower attachment.

Upstairs, there are two double bedrooms, both featuring original fireplaces, with one room also offering a built-in wardrobe and airing cupboard. The property retains sash windows and is heated via electric heaters and an electric hot water system.

To the rear, there is a private garden with a paved area, ideal for outdoor seating or planting. Council Tax Band B.

- Conveniently situated in Wilton
- Two double bedroom
- Lounge & separate dining room
- Original feature fireplaces
- Ground floor bathroom
- Built-in larder cupboard
- Electric heating & hot water
- Long garden with patio
- On-street parking
- Available early July, unfurnished





Further details

Ground Floor

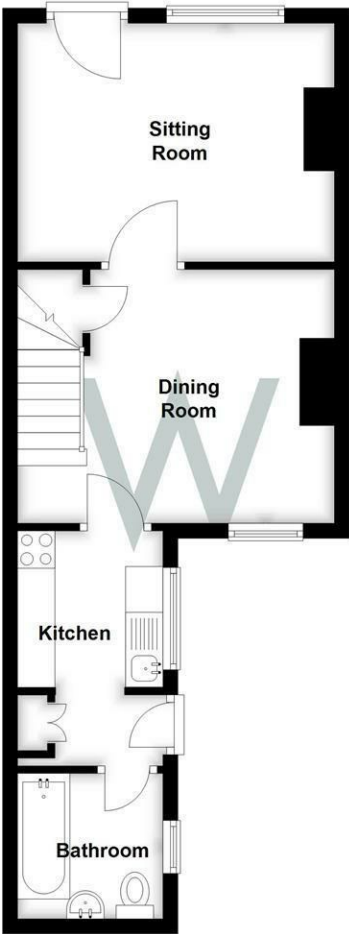

First Floor

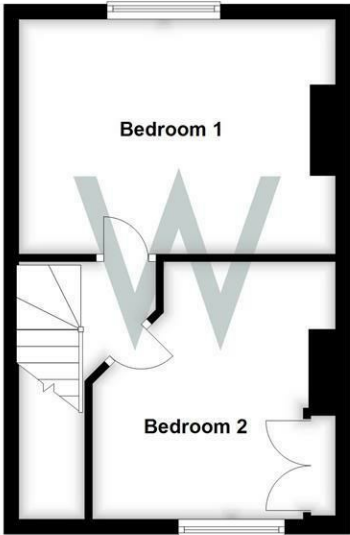

| Energy Efficiency Rating | | |
|---|---------|-------------------------|
| | Current | Potential |
| Very energy efficient - lower running costs | | |
| (92 plus) A | | 87 |
| (81-91) B | | |
| (69-80) C | | |
| (55-68) D | | |
| (39-54) E | | |
| (21-38) F | | |
| (1-20) G | | |
| Not energy efficient - higher running costs | | |
| England & Wales | | EU Directive 2002/91/EC |



Whites Estate Agents

Castle Chambers, 47 Castle Street,
Salisbury, SP1 3SP
Lettings-management@hwwhite.co.uk
01722 336 422